

Model 122505A & 122506A & Assembly Instructions Do-It-Yourself Retractable Sheath Banana Plug

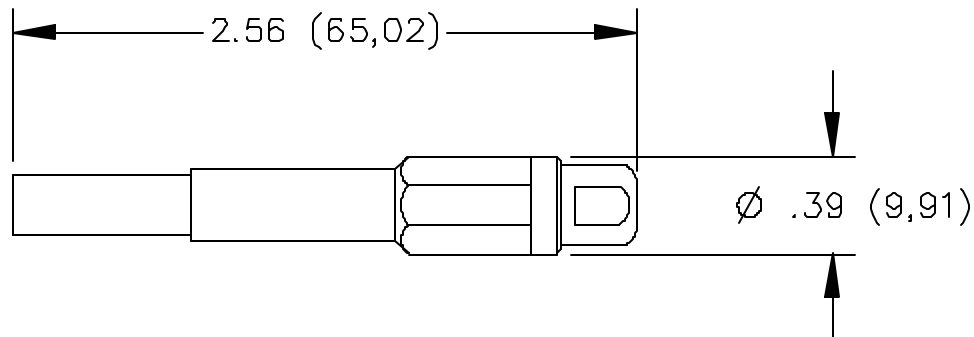

FEATURES:

- Models 122505A and 122506A accepts 18 to 22 AWG wire.
- Ideal for creating a special patch cord length.
- Spring loaded retractable sheath offers versatile use in sheathed and non-sheathed style of banana jacks.

MATERIALS:

Insulation: Lucel Acetal Polymer (N127)

Contact: Nickel plated brass & Beryllium Copper

RATINGS:

Operating Voltage: 1500 VRMS per IEC 1010, CAT III

Operating Temperature: -10°C to +80°C

Current: 20 Amperes

ORDERING INFORMATION:

Model 122505A (Color: Black)

Model 122506A (Color: Red)

All dimensions are in inches. Tolerances (except noted): .xx = ±.02" (.51 mm), .xxx = ± .005" (.127 mm).

All specifications are to the latest revisions. Specifications are subject to change without notice.

Registered trademarks are the property of their respective companies. Made in USA

Model 122505A & 122506A & Assembly Instructions Do-It-Yourself Retractable Sheath Banana Plug

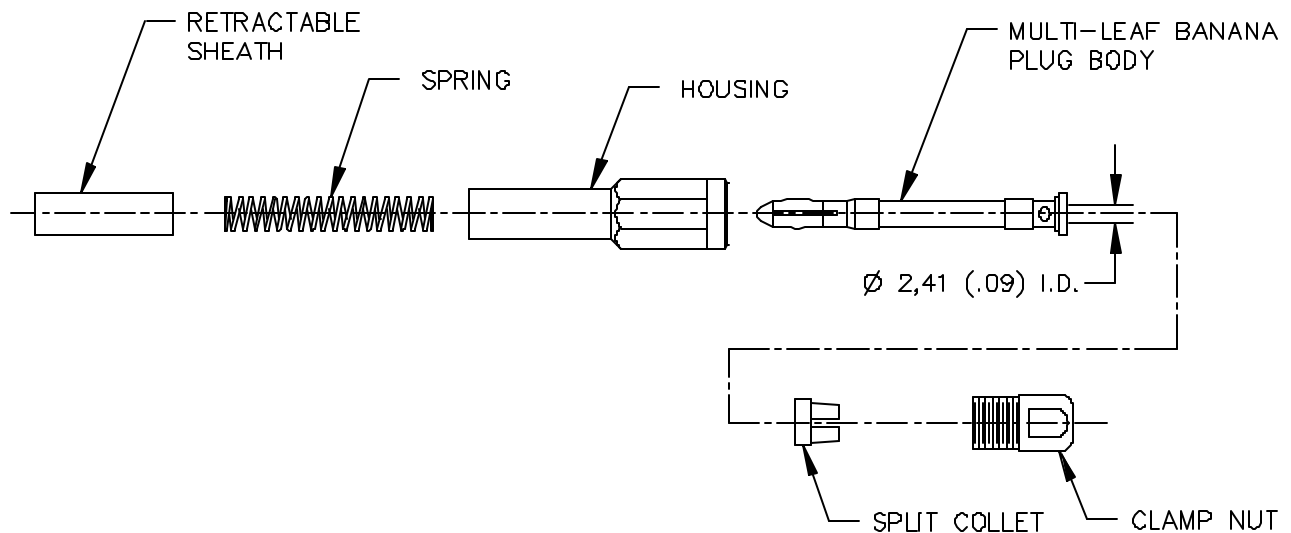

ASSEMBLY INSTRUCTIONS:

- A. Slide clam nut and split collet over wire.
- B. Solder wire to body.
- C. Tighten clam nut.
- D. Slide spring over banana plug body.
- E. Slide sheath over banana plug body until snap.

All dimensions are in inches. Tolerances (except noted): .xx = ±.02" (.51 mm), .xxx = ± .005" (.127 mm).
All specifications are to the latest revisions. Specifications are subject to change without notice.
Registered trademarks are the property of their respective companies. Made in USA

Mouser Electronics

Authorized Distributor

Click to View Pricing, Inventory, Delivery & Lifecycle Information:

Pomona:

[122506A](#) [122505A](#)