

REV. NO.		REVISIONS			
REV.	DATE	DESCRIPTION	DATE	OWN	APVD
A	09MAY06	RELEASED	09MAY06	SS	KS
B	23APR10	REVISED	23APR10	TS	KB

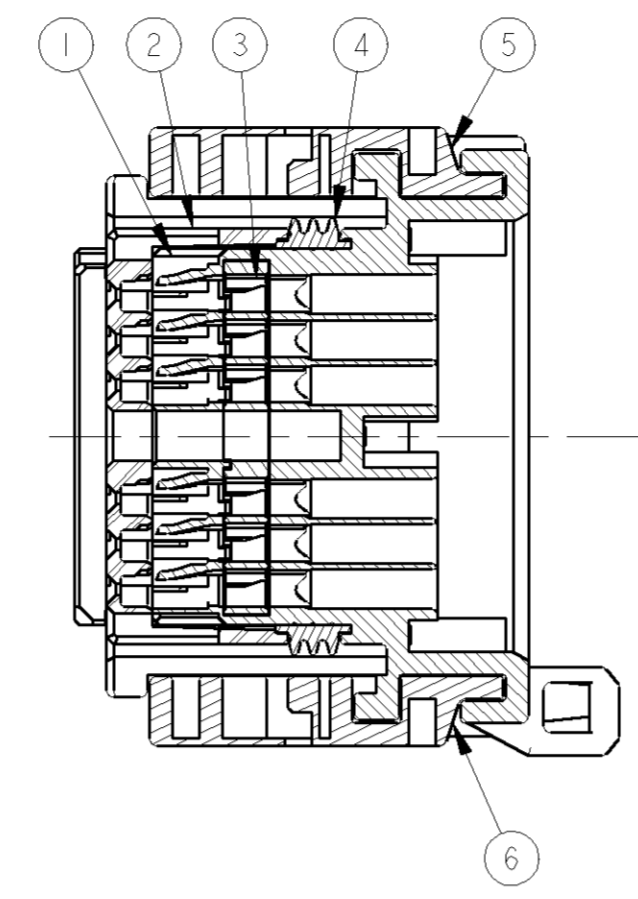

A-A

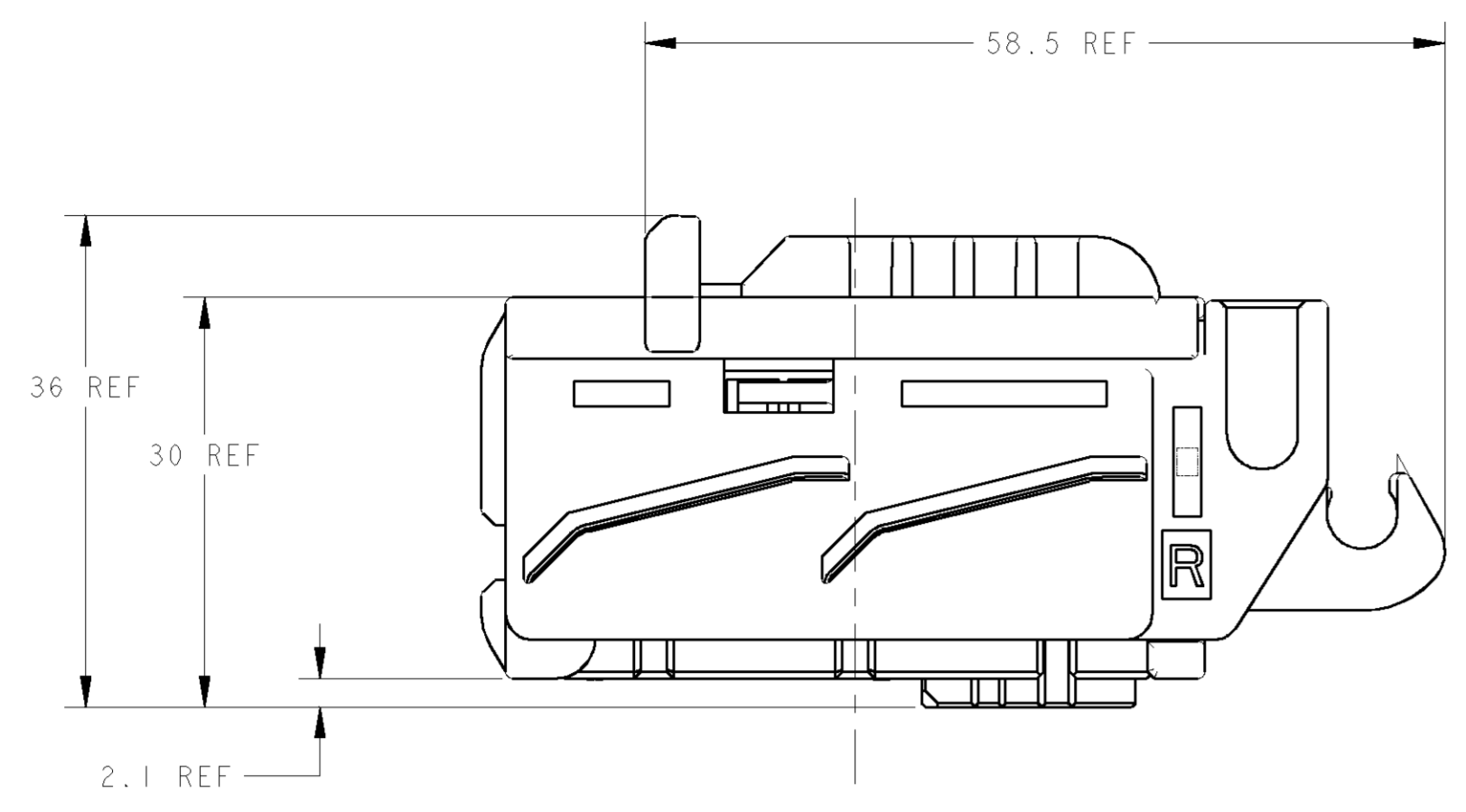
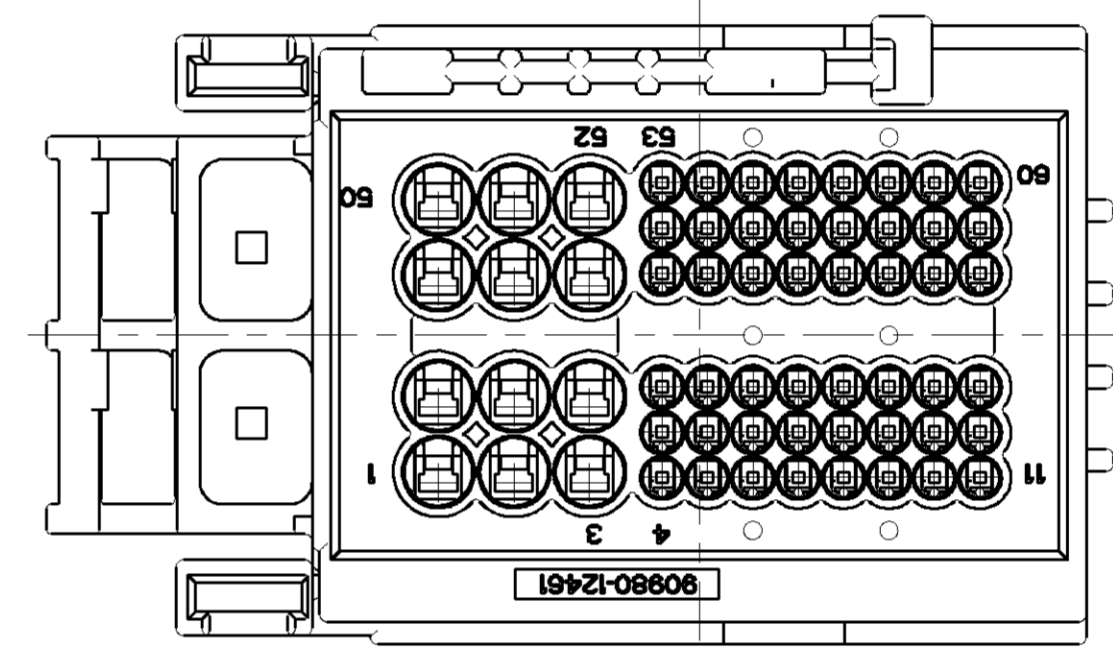
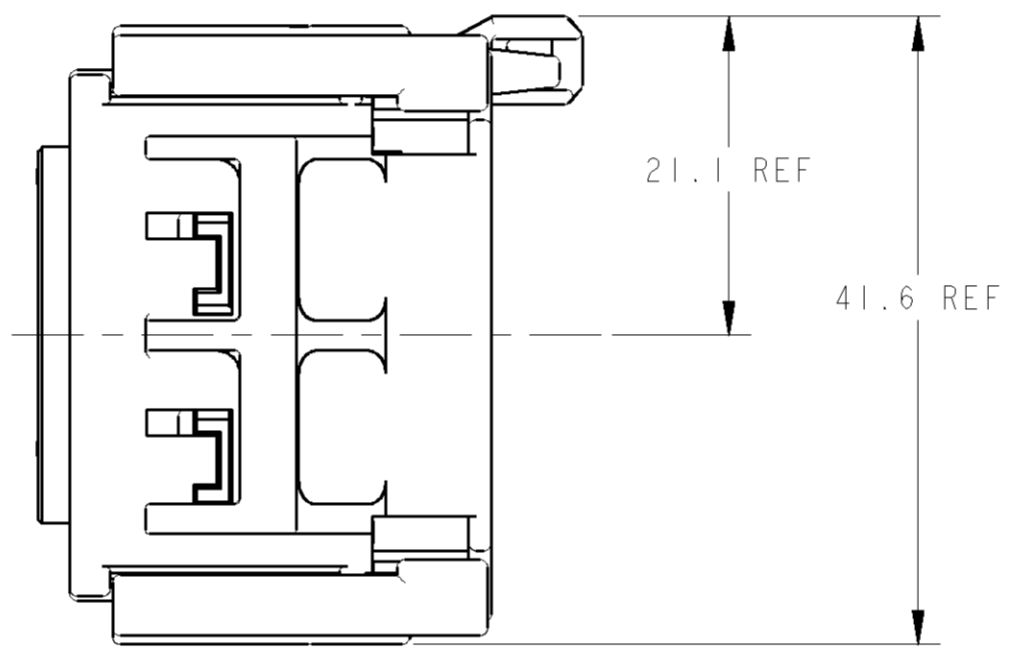
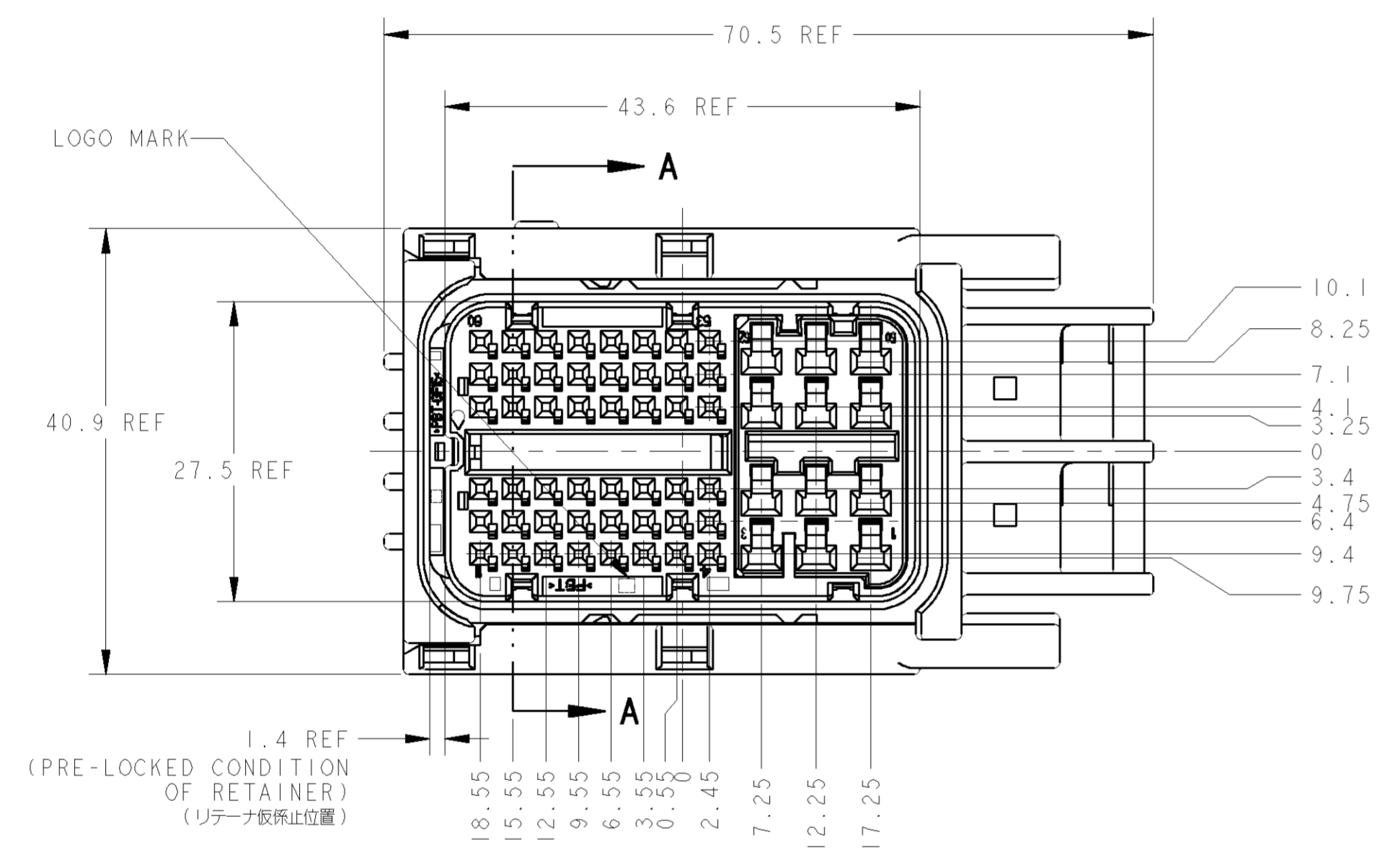

- MATING CONNECTOR IS:
P/N:1612272,1717313
- HANDLING OF THIS PART SHOULD FOLLOW INSTRUCTION SHEET NO.411-78084.
- COMPONENTS OF THIS PART;SEE TABLE-1
- THIS PRODUCT IS SHIPPED WITH RETAINER PRE-LOCKED POSITION.
- ASSEMBLED BY CUSTOMER.
LEVER P/N FOR SUPPLEMENT:1612288
- PLEASE USE A WIRE COVER, WHEN YOU CANNOT SECURE THE WORKING SPACE BETWEEN A LEVER AND AN ELECTRIC WIRE.

- 嵌合相手品番
P/N:1612272,1717313
- 本製品の取扱は取扱説明書NO.411-78084に従うこと
- 本製品の構成部品、TABLE-1参照
- リテーナは取外し状態で出荷される。
- レバーは顧客にて組立てされる。
補給用レバー品番:1612288
- レバーと電線の隙間(作業スペース)が確保出来ない時はカバーを使用下さい。

TABLE-1

ITEM NO.	NAME	MATERIAL	PACKING STYLE	
			外形	梱包形態
1	PAPER BOX タンボール箱	BLACK	PBT	SLIDER-L
2	SOFT TRAY プラスチックトレイ	BLACK	PBT	SLIDER-R
3	1	REDDISH BROWN	SILICONE	SEAL RING
4	1	NATURAL	PBT	RETAINER
5	1	BLACK	PBT	FRONT CAV
6	1	BLACK	PBT	PLUG HSG
	1612283-1	COLOR	MATERIAL	NAME

DIMENSIONS: 単位: mm 		TOLERANCES UNLESS OTHERWISE SPECIFIED: 公差: ±0.3 0-PLC ± 1-PLC ± 2-PLC ± 3-PLC ± 4-PLC ± ANGLES FINISH		OWN: S. SHISHIKURA 09MAY06 CHK: K. SAKAMAKI 09MAY06 APVD: S. ISOHATA 09MAY06 PRODUCT SPEC: 108-5891 APPLICATION SPEC: 114-5336 WEIGHT: 40 g FINISH: SEE TABLE		Tyco Electronics Corporation Kawasaki, Japan SEaled EFI ECU 0.64/2.311 I/O CONNECTOR 60POSITION PLUG HOUSING ASSY SIZE: A1 CAGE CODE: 00779 DRAWING NO: 1612283 CUSTOMER DRAWING	
SEE TABLE		SEE TABLE		CUSTOMER DRAWING		SHEET 2:1 OF 1 REV B	

Mouser Electronics

Authorized Distributor

Click to View Pricing, Inventory, Delivery & Lifecycle Information:

[TE Connectivity:](#)

[1612283-1](#)