



Metric Printed Circuit Board Supports

561-MMP002, 561-MMP003, 561-MMP004, 561-MMP005, 561-MMP006, 561-MMP008, 561-MMP010, 561-MMP012, 561-MMP014, 561-MMP016, 561-MMP018, 561-MMP020, 561-MMP022

Date Last Revised: 4/2/10

Locking Printed Circuit Board Supports are injection molded in natural Nylon 6/6 material. Economical locking spacers eliminate screws, nuts, and lock washers in mounting P.C. boards on metal chassis or stacking in multiple tiers. Unique locking clips provide a mechanically secure, reusable connection in pre-drilled or punched holes while saving considerable assembly time. The new metric supports are designed for 2.5mm dia. holes and 1.57mm thick panels.

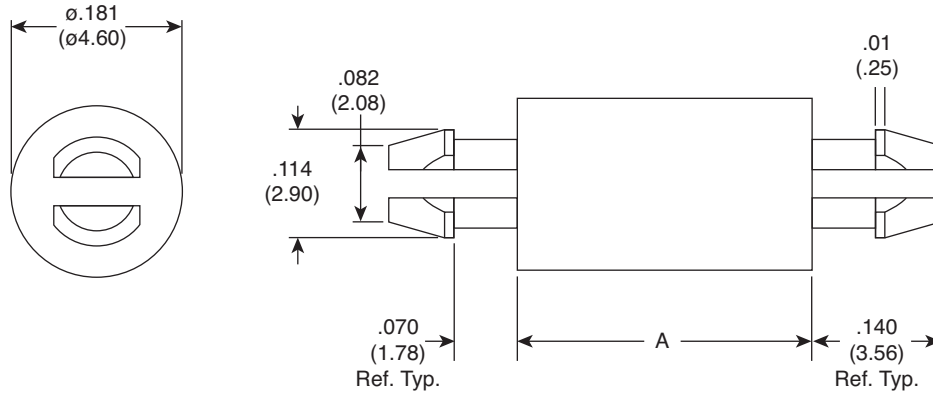

Notes:
 Hole Size .098 (±.002) [2.5mm]
 Panel Thickness -.062 [1.57mm]

Dimensions: in. (mm)

Item Number	Description	A (in.)
561-MMP002	2mm Mini Post	0.078
561-MMP003	3mm Mini Post	0.118
561-MMP004	4mm Mini Post	0.156
561-MMP005	5mm Mini Post	0.197
561-MMP006	6mm Mini Post	0.236
561-MMP007	8mm Mini Post	0.314
561-MMP010	10mm Mini Post	0.394
561-MMP012	12mm Mini Post	0.472
561-MMP014	14mm Mini Post	0.551
561-MMP016	16mm Mini Post	0.63
561-MMP018	18mm Mini Post	0.709
561-MMP020	20mm Mini Post	0.787
561-MMP022	22mm Mini Post	0.866

Available from Mouser Electronics
1-800-346-6873 / www.mouser.com

EPD-200512

Mouser Electronics

Authorized Distributor

Click to View Pricing, Inventory, Delivery & Lifecycle Information:

Eagle Plastic Devices:

[561-MMP002](#) [561-MMP003](#) [561-MMP012](#) [561-MMP020](#) [561-MMP022](#) [561-MMP016](#) [561-MMP014](#) [561-MMP018](#)
[561-MMP010](#) [561-MMP005](#) [561-MMP006](#) [561-MMP008](#) [561-MMP004](#)