

This document is the property of Amphenol Corporation and is delivered on the understanding that it is not to be distributed, copied, reproduced, or used in whole or in part, for manufacture or sale by anyone other than Amphenol Corporation or its authorized agents. Amphenol Corporation reserves the right to use any information in this document.

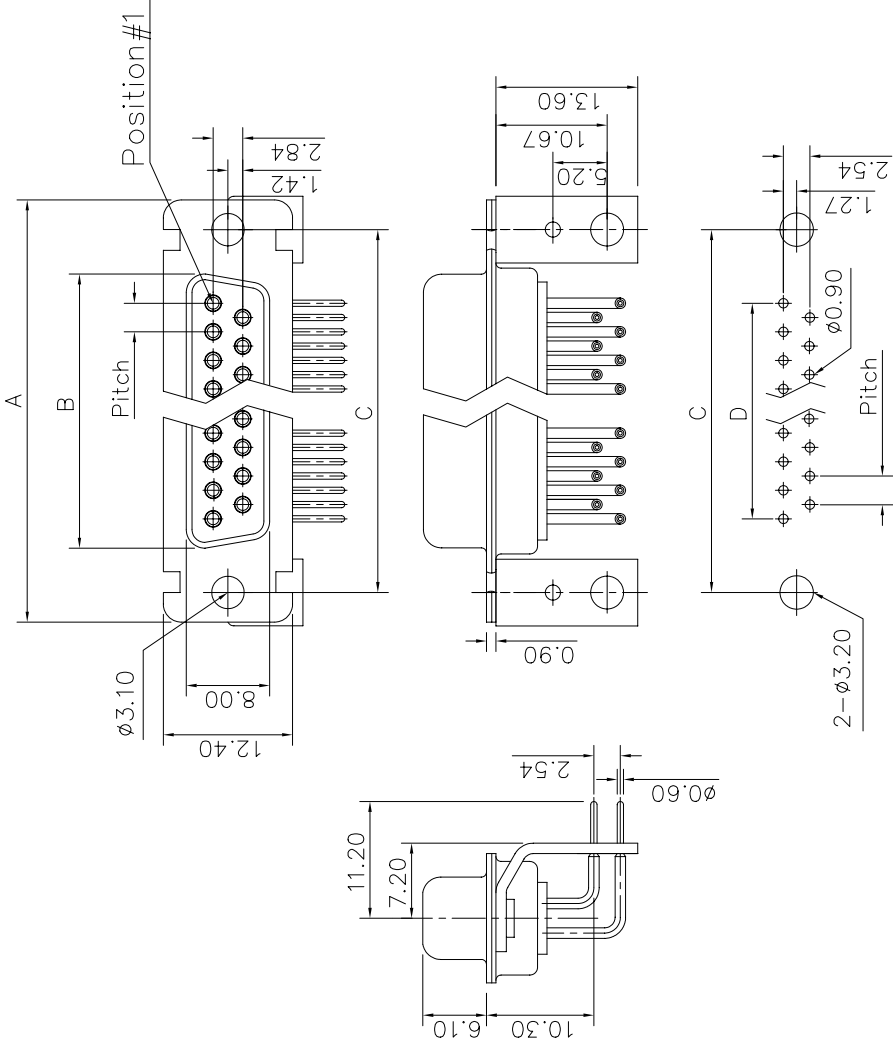

RECOMMENDED P.C.B LAYOUT
(TOLERANCE + / -0.03)

Customer drawing



DIM.S	A	B	C	D	Pitch
SHELL					
9	30.70	16.40	25.00	10.96	2.74
15	39.00	24.80	33.30	19.18	2.74
25	52.90	38.50	47.00	33.12	2.77
37	69.20	54.90	63.50	49.68	2.77

REVISONS		
SYM	ECN	DATE
1		06/18/08

D-SUB TECHNICAL DATA

SHELL : Steel 2.5um(100u") min tin over 1.25um(50u") min nickel
BODY : Glass filled thermoplastic.
CONTACTS : Flame retardant to UL94 V-0 Color Black Brass
BRACKET : 0.1um(4u") min gold over 1.25um(50u") min nickel
ELECTRICAL : Steel,100u" min tin over 50u" min nickel
Voltage rating : 300 V RMS at 50 Hz
Current rating 7.5A.
Insulation resistance >5000 M Ohms
Contact resistance 20 mohms max.
CLIMATIC : Temperature range -55 °C up to 85°C
Damp heat 21 days(40 °C-95% HR)
MARKING : Amphenol-...(Series No.)
Commercial reference
Manufacturing date

PRODUCT CODE

L 77D X XX S 1AMN

L: RoHS Compliance

77D: tinned shell for receptacle

Shell Size : E,A,B,C

Configuration: 09,15,25,37

Right angle connector:
European footprint
metal bracket
1AMN=X=2.54

Contact type:
S: Female

UNLESS OTHERWISE SPECIFIED		TOLERANCES		APPROVAL		DATE	
METRIC		U.S.		DRAWN		CHECKED	
X		+/-		0.50		0.030	
XX		+/-		0.30		0.020	
XXX		+/-		0.20		0.015	
FRACTIONS		+/-		2'		2'	
ANGLES		+/-		2'		2'	
FOR MATERIALS AND FINISHES		SEE NOTES		DRAWING FILE :		ANGLE OF PROJECTION	
REMOVE SHARP EDGES		DIMENSIONS		U-S		TINHAS	
MM		MM		MM		MM	

Amphenol

TITLE		REV.	
machined contacts connector, D series		1	
SIZE		A4	
DRAWING NO.		C L77DXXXS1AMN	
SCALE		NONE	
SHEET 1		OF 1	

Mouser Electronics

Authorized Distributor

Click to View Pricing, Inventory, Delivery & Lifecycle Information:

[Amphenol:](#)

[L77DE09S1AMN](#)