

Model 5931 Panel Mount IEC 1010 4mm Banana Jack For Sheathed Plugs

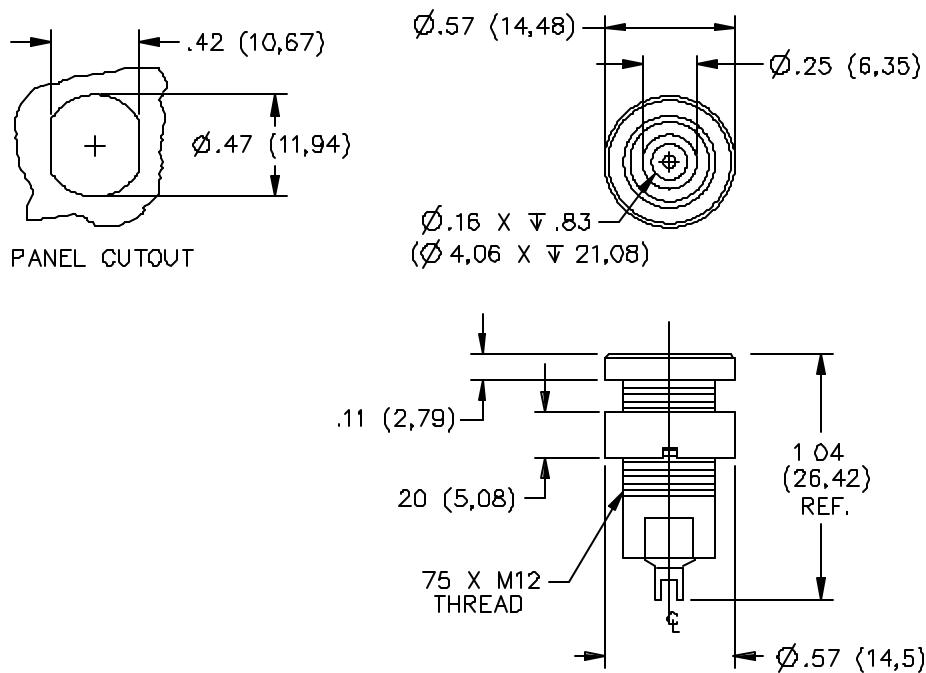

Recommended Maximum Panel Thickness: .28" (7mm)

FEATURES:

- Banana jack mates to Pomona's models 5907A, 5908A & 5909A flexible sheathed style of DMM test leads.
- Slip ring threads onto the insulated body to firmly secure jack to panel.
- Banana jack is gold plated for superb electrical connection.

MATERIALS:

Banana Jack: Brass, Gold Plated

Insulation: Nylon

Locking Ring: Brass, Nickel Plated

RATING:

Operating Voltage: 1000 VRMS Max.

Current: 36 Amperes Max.

ORDERING INFORMATION: Model 5931-*

* = Color, Std. Colors: -0 Black, -2 Red, -4 Yellow, -5 Green, -6 Blue, -9 White

Sold in packs of ten.

All dimensions are in inches. Tolerances (except noted): .xx = ±.02" (.51 mm), .xxx = ±.005" (.127 mm).

All specifications are to the latest revisions. Specifications are subject to change without notice.

Registered trademarks are the property of their respective companies. Made in USA

Mouser Electronics

Authorized Distributor

Click to View Pricing, Inventory, Delivery & Lifecycle Information:

Pomona:

[5931-9](#) [5931-0](#) [5931-4](#) [5931-5](#) [5931-2](#) [5931-6](#) [5931-02](#)