

Hole Plugs

561-12BG09, 561-12BG09B, 561-15BG09, 561-18BG14, 561-25BG06, 561-25BG06BK, 561-25BM06, 561-31BG14, 561-37BG31, 561-43BG17, 561-50BG14, 561-50BM14B, 561-56BG14, 561-62BG07, 561-75BG11, 561-87BG11, 561-100BG11

Date Last Revised: 8-7-14

Dimensions: in.

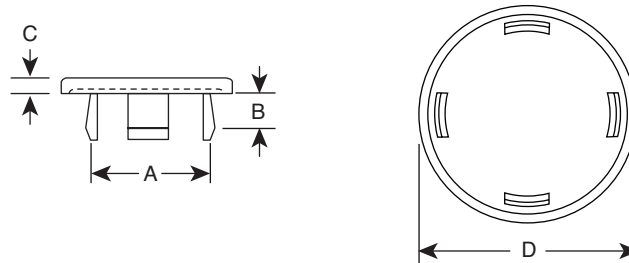

Economical snap-in Poly-Plugs will close unneeded chassis holes, wiring outlets, fill unused accessory openings, cover inspection and production access holes. They can be used as tube end caps and protective bumpers.

Poly plugs are molded in Nylon 6/6 which is abrasion and vibration resistant making them ideal for drawer glides and small appliance feet. Poly Plugs are designed with special flexible and tapered prongs which snugly lock in place with finger pressure but can be removed and reused when necessary. Parts can be furnished in natural nylon or dyed in colors. Poly Plugs are available in smooth, gloss finish or in dull, matte finish.

* Color = Black

MOUSER STOCK NO.	Head Style	Finish	Hole Size (A)	Panel Thickness (B)	Head Height (C ±.010)	Head Size (D)
561-12BG09	Binder	Smooth	0.125	.031/.094	0.04	0.203
* 561-12BG09B	Binder	Smooth	0.125	.031/.094	0.04	0.203
561-15BG09	Binder	Smooth	0.15	.031/.094	0.04	0.25
561-18BG14	Binder	Smooth	0.187	.031/.140	0.04	0.344
561-25BG06	Binder	Smooth	0.25	.031/.062	0.04	0.422
* 561-25BG06BK	Binder	Smooth	0.25	.031/.062	0.04	0.422
561-25BM06	Binder	Matte	0.25	.031/.062	0.04	0.422
561-31BG14	Binder	Smooth	0.312	.031/.140	0.055	0.453
561-37BG31	Binder	Smooth	0.375	.031/.140	0.055	0.578
561-43BG17	Binder	Smooth	0.437	.031/.171	0.055	0.609
561-50BG14	Binder	Smooth	0.5	.031/.140	0.062	0.672
561-50BM14B	Binder	Matte	0.5	.031/.140	0.062	0.672
561-56BG14	Binder	Smooth	0.562	.031/.140	0.062	0.734
561-62BG07	Binder	Smooth	0.625	.031/.072	0.062	0.797
561-75BG11	Binder	Smooth	0.75	.031/.109	0.062	0.984
561-87BG11	Binder	Smooth	0.875	.031/.109	0.062	1.078
561-100BG11	Binder	Smooth	1	.031/.109	0.062	1.219

Available from Mouser Electronics
1-800-346-6873 / www.mouser.com

EPD-200502

Mouser Electronics

Authorized Distributor

Click to View Pricing, Inventory, Delivery & Lifecycle Information:

Eagle Plastic Devices:

[561-15BG09](#) [561-62BG07](#) [561-25BG06](#) [561-87BG11](#) [561-50BG14](#) [561-12BG09](#) [561-100BG11](#) [561-75BG11](#) [561-31BG14](#) [561-12BG09B](#) [561-37BG31](#) [561-15BG09-BLK](#) [561-43BG17](#) [561-18BG14](#) [561-25BM06](#) [561-56BG14](#) [561-25BG06BK](#) [561-50BM14B](#)