

**Models 72912**  
**Panel Mt IEC1010 Banana Jacks for Sheathed Plugs**

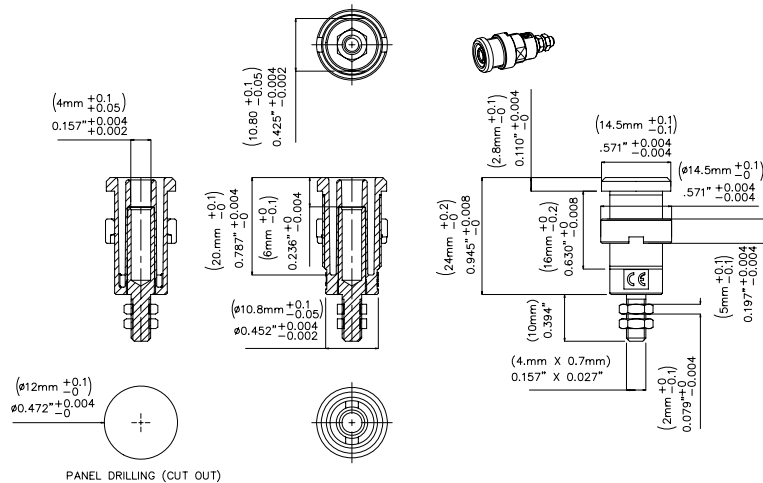

**Features**

- Panel Mt IEC1010 4mm (0.16in) jack for sheathed banana plugs, threaded stud.

**Materials**

- Body: Polyamide.
- Nut: Nickel plated
- Pin: Gold plated Nickel brass.
- Pin hex nuts: Gold Plated brass

**Ordering Information**

Model: 72912-Color sold in packages of 10 pieces.  
Available colors: Black (-0), Red (-2)

**Specifications**

Max Current	36A
Max Voltage	1000 V CAT III

M4 x 0.7 nut: Screwing torque nuts 30Ncm Max.

**USA:** Sales: 800-490-2361 Technical Support: 800-241-2060 Fax: 888-403-3360

**Europe:** 31-(0) 40 2675 150 **International:** 425-446-5500

**e-mail:** [technicalsupport@pomonatest.com](mailto:technicalsupport@pomonatest.com)

**Where to Buy:** [www.pomonaelectronics.com](http://www.pomonaelectronics.com)

All dimensions are in inches. Tolerances (except noted): .xx = ±.02" (.51 mm), .xxx = ±.005" (.127 mm). All specifications are to the latest revisions. Specifications are subject to change without notice. Registered trademarks are the property of their respective companies.

# Mouser Electronics

Authorized Distributor

Click to View Pricing, Inventory, Delivery & Lifecycle Information:

Pomona:

[72912-2](#) [72912-0](#)