

TABLE 1
TERMINAL SPECIFICATION

LEAD STYLE	SOCKET	"L" REF
-2	SC-1P1-XX	.300
-3	SC-1S1-XX	.203
-10	SC-3P1-XX	.230
-11	SC-4P1-XX	.240
-12	SC-5P1-XX	.190
-15	SC-1M2-XX	.167
-18	SC-6P1-XX	.353
-19	SC-8P1-XX	.165
-22	EZ-1P1-XX	.300
-23	EZ-1S1-XX	.203
-30	EZ-3P1-XX	.230
-31	EZ-4P1-XX	.240
-32	EZ-5P1-XX	.190
-38	EZ-6P1-XX	.353

TABLE 2

ROW SPECIFICATION	LEAD STYLE	PLUG	TUBE
01	-3	TP-12	PT-1-24-01-23
02	-10, -12	TP-03	PT-1-24-01-14
03	-12, -23	TP-03	PT-1-24-01-27
03	-32	TP-09	PT-1-24-01-59

NOTES:

- 1.) FILL ALL POSITIONS.
- 2.) PINS TO ENTER BODY FROM C'BORE SIDE.
- 3.) BARB ON SOCKET MUST BE VISABLE BELOW BODY.
- 4.) DELETED
- 5.) ALL OPTIONS ROWS 4-20, WITH LEAD STYLE 02, 10, 11, 12, AND 18, TO BE PACKAGED ON BEAD BOARD.
- 6.) ALL OPTIONS ROWS 1-3, TO BE PACKAGED IN TUBES. UNLESS OTHERWISE SPECIFIED, ALL OTHER PARTS TO BE BULK PACKAGED.
- 7.) MAXIMUM ALLOWABLE FLASH: .010[0.25].

-L OPTION

AVAILABLE IN STYLES -2 & -22 ONLY

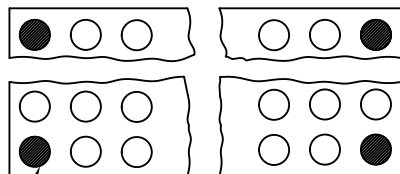

REPLACE CORNER POSITIONS WITH
SC-1L1-GT (WHEN USING SC LEAD STYLE)
OR EZ-1L1-GT WHEN USING EZ LEAD STYLE)
NOTE: FOR -ST PLATING SPEC.
USE SC-1L1-GT OR EZ-1L1-GT

DIMENSIONS ARE IN INCHES

UNLESS OTHERWISE NOTED

TOLERANCES ARE:

ONE PLACE DECIMALS: $\pm .1[.3]$ THREE PLACE DECIMALS: $\pm .005[.13]$

ANGLES

TWO PLACE DECIMALS: $\pm .01[.3]$ FOUR PLACE DECIMALS: $\pm .0020[.051]$ $\pm 2^\circ$

TITLE:

HLS ASSEMBLY

DWG NO:

HLS-XXXX-XX-XX-X

SHEET 1 OF 1

HLS-XXXX-XX-XX-X

ROW SPECIFICATION

(SEE FIG. 1)

EXPRESSED IN NO. OF ROWS
1 THRU 20BODY LENGTH SPECIFICATION

(SEE FIG. 1)

EXPRESSED IN NO. OF POS. PER ROW
1 THRU 20OPTION-L LOCKING LEAD
(USE ONLY WITH LEAD
STYLE -2 OR -22)LEAD STYLE SPECIFICATION

(SEE TABLE 1)

PLATING SPECIFICATION

- G: GOLD, SPECIFY -GG IN SOCKET SUFFIX -XX
- T: TIN, SPECIFY -GT IN SOCKET SUFFIX -XX
- TT: TIN/TIN, SPECIFY -TT IN SOCKET SUFFIX -XX
(STYLE 2,10,11,12,18,22,30,31,&32 ONLY)
- S: SELECTIVE, SPECIFY -ST IN SOCKET SUFFIX -XX
(STYLE -2 & -22 ONLY)

ASSEMBLY INSTRUCTIONS

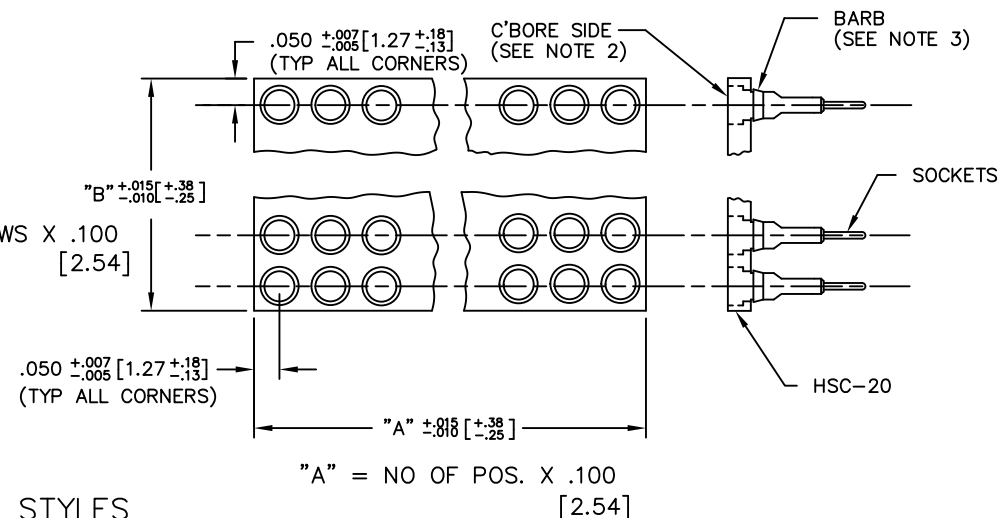

STYLES
-11,12,15,19,31 & 32

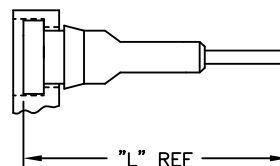

SOCKETS TO BE RECESSED (COUNTER-SUNK)
INTO BODY TO ALLOW BARB
PROTRUSION AT BOTTOM

FIGURE 1

PROPRIETARY NOTE
THIS DOCUMENT CONTAINS CONFIDENTIAL
AND PROPRIETARY INFORMATION AND ALL
DESIGN, MANUFACTURING, REPRODUCTION,
USE, PATENT RIGHTS AND SALES RIGHTS
ARE EXPRESSLY RESERVED BY SAMTEC,
INC. THIS DOCUMENT SHALL NOT BE
DISCLOSED IN WHOLE OR PART, TO ANY
UNAUTHORIZED PERSON OR ENTITY NOR
REPRODUCED, TRANSMITTED OR
INCORPORATED IN ANY OTHER PROJECT IN
ANY MANNER WITHOUT THE EXPRESS
WRITTEN CONSENT OF SAMTEC, INC.

EXISPROD\ASSEMBLY\100
HLS-ASM
samtec

520 PARK EAST BLVD. NEW ALBANY, INDIANA 47150
PHONE (812) 944-6733 P.O. BOX 1147
CODE 55322

MADE BY: JORDAN 5-30-85
CHECKED BY: THRUSTON 6-4-85

ENGINEER
APPROVAL
BET
6-4-85

HLS-XXXX-XX-XX-X
SHEET 1 OF 1

Mouser Electronics

Authorized Distributor

Click to View Pricing, Inventory, Delivery & Lifecycle Information:

Samtec:

[HLS-0106-G-3](#) [HLS-0407-S-2](#) [HLS-0105-G-3](#) [HLS-0215-G-10](#) [HLS-0215-G-11](#) [HLS-0217-T-15](#) [HLS-0220-G-12](#)
[HLS-0220-G-2](#) [HLS-0220-T-31](#) [HLS-0220-T-32](#) [HLS-0301-TT-12](#) [HLS-0304-TT-11](#) [HLS-0305-G-11](#) [HLS-0305-G-12](#)
[HLS-0308-G-18](#) [HLS-0310-G-22](#) [HLS-0314-G-11](#) [HLS-0316-G-2](#) [HLS-0316-G-38](#) [HLS-0318-TT-22](#) [HLS-0320-G-2](#)
[HLS-0404-T-10](#) [HLS-0405-S-2](#) [HLS-0408-TT-22](#) [HLS-0414-S-2](#) [HLS-0416-T-10](#) [HLS-0417-T-2](#) [HLS-0508-G-38](#)
[HLS-0520-T-18](#) [HLS-0807-T-2](#) [HLS-0813-TT-2](#) [HLS-0813-TT-22](#) [HLS-2001-TT-12](#) [HLS-0204-T-31](#) [HLS-0205-TT-12](#)
[HLS-0206-G-10](#) [HLS-0207-S-2](#) [HLS-0207-T-11](#) [HLS-0209-G-2](#) [HLS-0209-G-38](#) [HLS-0209-T-10](#) [HLS-0213-G-3](#)
[HLS-0216-G-2](#) [HLS-0218-T-11](#) [HLS-0220-T-18](#) [HLS-0303-G-18](#) [HLS-0303-G-2](#) [HLS-0306-G-11](#) [HLS-0306-G-18](#)
[HLS-0306-T-11](#) [HLS-0306-T-12](#) [HLS-0308-T-22](#) [HLS-0308-TT-22](#) [HLS-0311-G-12](#) [HLS-0312-T-30](#) [HLS-0312-TT-30](#)
[HLS-0314-T-32](#) [HLS-0317-T-2](#) [HLS-0317-T-22](#) [HLS-0320-T-18](#) [HLS-0406-T-18](#) [HLS-0406-TT-10](#) [HLS-0412-G-2](#)
[HLS-0420-G-2](#) [HLS-0513-G-38](#) [HLS-0610-T-2](#) [HLS-0611-T-12](#) [HLS-1111-TT-22-L](#) [HLS-0314-T-31](#) [HLS-0317-S-2](#)
[HLS-0317-T-30](#) [HLS-0320-T-2](#) [HLS-0320-T-22](#) [HLS-0406-T-2](#) [HLS-0407-G-10](#) [HLS-0407-G-11](#) [HLS-0410-T-2](#) [HLS-](#)
[0411-G-2](#) [HLS-0420-S-2](#) [HLS-0420-T-12](#) [HLS-0512-T-18](#) [HLS-0610-TT-2](#) [HLS-0610-TT-22](#) [HLS-0910-G-2](#) [HLS-](#)
[1012-G-10](#) [HLS-0312-G-11](#) [HLS-0312-T-12](#) [HLS-0313-G-11](#) [HLS-0314-T-12](#) [HLS-0314-TT-2](#) [HLS-0316-T-12](#) [HLS-](#)
[0316-TT-11](#) [HLS-0320-T-15](#) [HLS-0406-T-11](#) [HLS-0410-G-2](#) [HLS-0420-G-19](#) [HLS-0516-G-38](#) [HLS-0620-T-22](#) [HLS-](#)
[1212-G-2](#) [HLS-0303-T-2](#)