

REVISIONS		
LTR	DESCRIPTION	DATE
A	INITIAL RELEASE PER ECO-08-020561	15AUG08

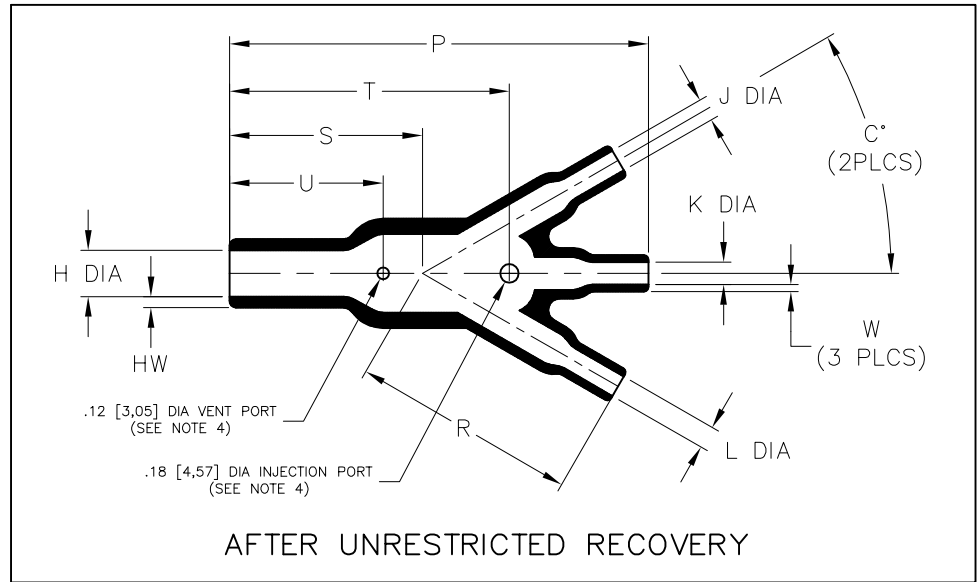
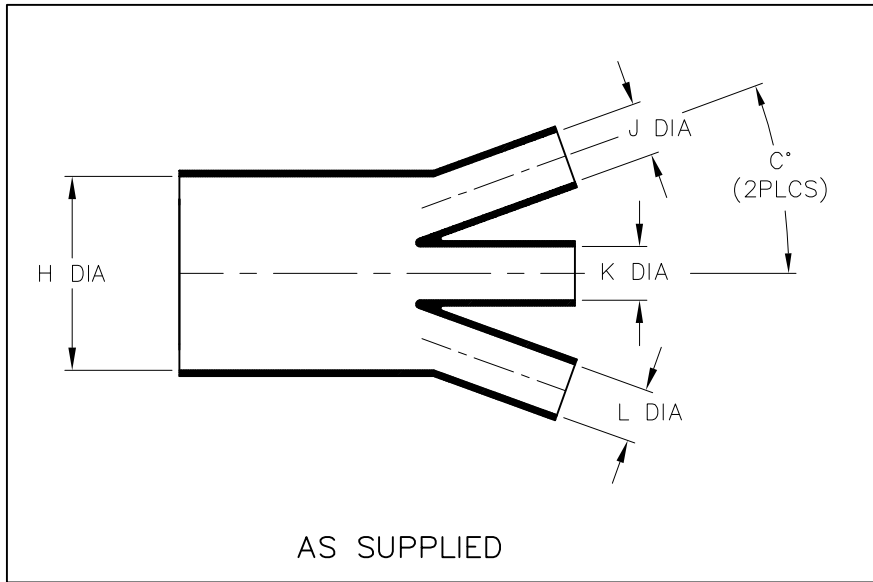

PART DESCRIPTION	H		J,K & L		P	R	S	T	U	HW	W	C°	
	MIN a	MAX b	MIN a	MAX b	±10% b	±10% b	±10% b	±10% b	±10% b	±20% b	±20% b	REF a	±5° b
462A034-12	1.52 [38,6]	.74 [18,8]	.76 [19,3]	.38 [9,7]	5.32 [135,1]	2.90 [73,7]	2.42 [61,5]	3.50 [88,9]	1.80 [45,7]	.12 [3,05]	.07 [1,78]	20°	30°

**NOTES**

- ALL DIMENSIONS ARE IN  $\frac{\text{INCHES}}{\text{MILLIMETERS}}$
- DIMENSIONS APPEARING IN TABLE ARE AS FOLLOWS:  
a - AS SUPPLIED  
b - AFTER UNRESTRICTED RECOVERY
- MATERIAL: -12 IS FLUOROELASTOMER, RT-1312
- MOLDING PORTS ARE OPTIONAL. WHEN -00 MODIFICATION NUMBER IS SPECIFIED MOLDING PORTS WILL BE LOCATED AS SHOWN.

If this document is printed it becomes uncontrolled. Check for the latest revision.

**CUSTOMER DRAWING**

UNLESS OTHERWISE SPECIFIED DIMENSIONS ARE INCHES. METRIC DIMENSIONS ARE IN BRACKETS.  DECIMAL TOLERANCES .XXX ± 0.005 [0.13 mm] .XX ± 0.01 [0.25 mm] .X ± 0.1 [0.50 mm]  ANGLE TOLERANCE .X ± 1 DEG.	DRAWN YUNGUYEN	DATE 05/30/2008	 Raychem Molded Parts 305 Constitution Dr Menlo Park, CA 94025
	TITLE TRANSITION, 1 TO 3 ENTRY		
THIRD ANGLE PROJECTION	SIZE B	CODE IDENT. NO. 06090	DWG. NO. 462A034-12

# Mouser Electronics

Authorized Distributor

Click to View Pricing, Inventory, Delivery & Lifecycle Information:

[TE Connectivity:](#)

[462A034-12-0](#)