

SPECIFICATIONS:

MATERIALS:

SHELL: STEEL, TIN (80u" TIN OVER 40u" COPPER)
OR NICKEL (80u" NICKEL OVER 40u" COPPER)

INSULATOR: UL 94V-0 RATED BLACK PBT
+30% FIBER-GLASS

CONTACTS: COPPER ALLOY, GOLD PLATED

ELECTRICALS:

CURRENT RATING: 5 AMPS
CONTACT RESISTANCE: 15 mOHMS MAX
INSULATOR RESISTANCE: 1000 MOHMS MIN
VOLTAGE: 500V AC FOR 1 MINUTE
TEMPERATURE: -50°C TO +100°C

POS.	A	B	C	D	E	F	G
09	1.213	0.984	0.642	0.756	0.311	0.109	0.496
	30.80	24.99	16.30	19.20	7.90	2.77	12.60
15	1.541	1.312	0.971	1.091	0.311	0.109	0.496
	39.15	33.32	24.65	27.70	7.90	2.77	12.60
25	2.087	1.852	1.512	1.618	0.311	0.109	0.496
	53.00	47.04	38.40	41.10	7.90	2.77	12.60
37	2.728	2.500	2.157	2.256	0.311	0.109	0.496
	69.30	63.50	54.80	57.30	7.90	2.77	12.60
50	2.638	2.406	2.055	2.169	0.429	0.109	0.602
	67.00	61.00	52.20	55.10	10.90	2.77	15.30

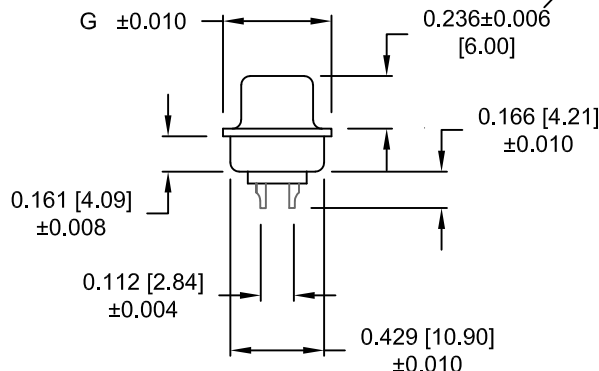
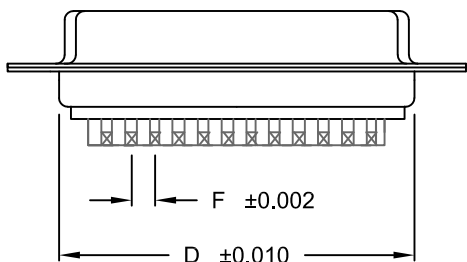
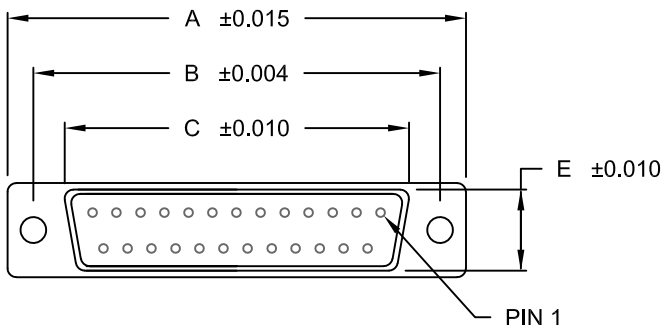

171-YYY-20YLYY1

- SERIES
- POSITIONS
- 009
- 015
- 025
- 037
- 050
- GENDER
- 1 = MALE
- 2 = FEMALE
- TERMINATION
- 0 = SOLDER CUP
- SHELL PLATING
- 2 = TIN
- 3 = NICKEL
- HARDWARE OPTIONS
- 00 = NO HARDWARE
- 01 = .098 4-40 CLINCH NUT BOARD SIDE
- 02 = .236 4-40 CLINCH NUT BOARD SIDE
- 03 = .236 4-40 CLINCH NUT MATING SIDE
- 05 = .237 4-40 BOARD LOCK
- 91 = .237 4-40 SPACER/BOARD LOCK
- PLATING OPTIONS
- 1 = GOLD FLASH
- 2 = 30 MICRO-INCH GOLD

WILL ACCEPT 28-20 AWG CONDUCTORS

RoHS COMPLIANT

UNITS = INCHES [MM] DO NOT SCALE FROM DRAWING



THESE DRAWINGS AND SPECIFICATIONS ARE THE PROPERTY OF NorComp AND SHALL NOT BE REPRODUCED, COPIED OR USED AS THE BASIS FOR THE MANUFACTURE OR SALE OF APPARATUS WITHOUT WRITTEN PERMISSION.

DRAWN:
J. KADEL

DATE:
07/24/2018

NorComp

SCALE:
NTS

SHEET OF
1 2

REV
12

DWG NO.

171-YYY-20YLYY1

TOLERANCE:
ALL DIMENSIONS ARE ± 0.010

ALL CLINCH-NUTS ARE 4-40 INTERNAL THREADS

01X 0.098" (BOARD SIDE) - CN1

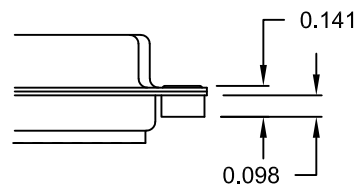

02X 0.236" (BOARD SIDE) - CN2

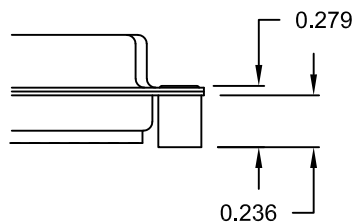

03X..... 0.236" (MATING SIDE) - CN8

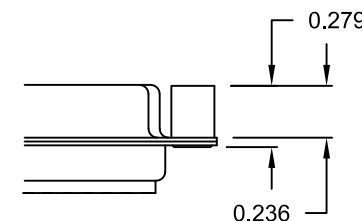

05X 0.237" (BOARD SIDE) - CN10

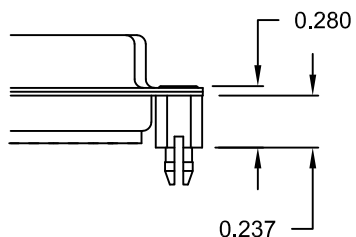

91X 0.237" BOARD SIDE
0.197" MATING SIDE
CN10/SFSO4404

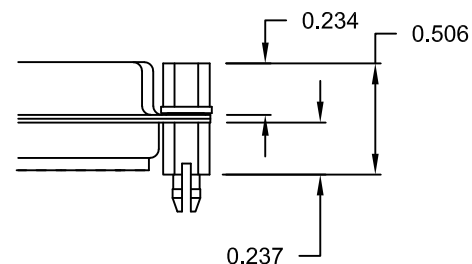

NOTE: 4-40 FEMALE SCREW LOCK IS REMOVABLE

RoHS COMPLIANT

UNITS = INCHES [MM] **DO NOT SCALE FROM DRAWING**



THESE DRAWINGS AND SPECIFICATIONS ARE THE PROPERTY OF NorComp AND SHALL NOT BE REPRODUCED, COPIED OR USED AS THE BASIS FOR THE MANUFACTURE OR SALE OF APPARATUS WITHOUT WRITTEN PERMISSION.

DRAWN:
J. KADEL

DATE:
07/24/2018

NorComp

SCALE:
NTS

SHEET OF
2 2

REV
12

DWG NO.

171-YYY-20YLYY1

Mouser Electronics

Authorized Distributor

Click to View Pricing, Inventory, Delivery & Lifecycle Information:

NorComp:

[171-009-203L011](#) [171-009-203L021](#) [171-009-203L031](#) [171-015-203L011](#) [171-015-203L021](#) [171-015-203L031](#)
[171-025-203L011](#) [171-025-203L021](#) [171-025-203L031](#) [171-037-203L011](#) [171-037-203L021](#) [171-037-203L031](#) [171-](#)
[050-203L011](#) [171-050-203L021](#) [171-050-203L031](#) [171-037-202L011](#) [171-025-203L001](#) [171-050-203L001](#) [171-037-](#)
[203L001](#) [171-009-203L001](#) [171-015-203L001](#) [171-009-202L001](#) [171-009-202L011](#) [171-009-202L021](#) [171-009-](#)
[202L031](#) [171-015-202L001](#) [171-015-202L011](#) [171-015-202L021](#) [171-015-202L031](#) [171-025-202L001](#) [171-025-](#)
[202L011](#) [171-025-202L021](#) [171-025-202L031](#) [171-037-202L001](#) [171-037-202L021](#) [171-037-202L031](#) [171-050-](#)
[202L001](#) [171-050-202L011](#) [171-050-202L021](#) [171-050-202L031](#) [171-009-113R051](#) [171-015-212-001](#) [171-015-212-](#)
[911](#) [171-025-112-001](#) [171-009-102-001](#) [171-009-112-001](#) [171-015-112-001](#) [171-050-112-001](#) [171-015-212-031](#)
[171-025-212-031](#) [171-015-102-001](#) [171-025-212-001](#) [171-025-102-001](#) [171-037-112-001](#) [171-050-212-001](#) [171-](#)
[037-102-001](#) [171-037-212-001](#)