

Relay connectors - ST-REL3-KG 24/ 1/SO38 - 2829564

Please be informed that the data shown in this PDF Document is generated from our Online Catalog. Please find the complete data in the user's documentation. Our General Terms of Use for Downloads are valid (<http://phoenixcontact.com/download>)



Relay connector for high inrush currents, contacts (AgCdO+capacitive W): medium to large loads, 1 N/O contact, input voltage 24 V DC, max. inrush current 10 A

Your advantages

- ✓ Can be snapped onto standard EN DIN rails
- ✓ Clear terminal marking using Phoenix Contact labeling material
- ✓ Modular DIN-rail mountable EMG housing with 17.5 mm design width
- ✓ User-friendly plug-in housing
- ✓ Easy maintenance



Key Commercial Data

Packing unit	10 pc
GTIN	 4 017918 078515
GTIN	4017918078515

Technical data

Dimensions

Width	20.8 mm
Height	42.5 mm
Depth	112 mm

Ambient conditions

Ambient temperature (operation)	-20 °C ... 50 °C
Ambient temperature (storage/transport)	-20 °C ... 70 °C

Coil side

Nominal input voltage U_N	24 V DC
Input voltage range in reference to U_N	0.85 ... 1.1
Typical input current at U_N	28 mA

Relay connectors - ST-REL3-KG 24/ 1/SO38 - 2829564

Technical data

Coil side

Typical response time	13 ms
Typical release time	15 ms
Protective circuit	Free-wheeling diode Damping diode
Operating voltage display	Yellow LED
Power dissipation for nominal condition	0.67 W

Contact side

Contact type	1 N/O contact with lead contact
Type of switch contact	Lead contact
Contact material	AgCdO
Note	Main contact silver cadmium oxide (AgCdO): lead contact tungsten
Maximum switching voltage	250 V AC
Maximum inrush current	80 A (20 ms)
Limiting continuous current	10 A
Interrupting rating (ohmic load) max.	2500 VA (for 250 V AC)

General

Test voltage relay winding/relay contact	2.5 kV AC (50 Hz, 1 min.)
Mechanical service life	approx. 10^7 cycles
Assembly instructions	Horizontal with zero spacing, vertical with spacing

Standards and Regulations

Standards/regulations	IEC 60664
	EN 50178
Insulation	Basic insulation
Degree of pollution	2
Overvoltage category	III

Environmental Product Compliance

REACH SVHC	Lead 7439-92-1
China RoHS	Environmentally Friendly Use Period = 50
	For details about hazardous substances go to tab "Downloads", Category "Manufacturer's declaration"

Drawings

Relay connectors - ST-REL3-KG 24/ 1/SO38 - 2829564

Circuit diagram

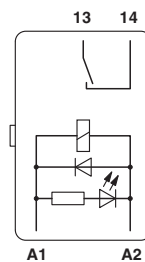

Approvals

Approvals

Approvals

EAC

Ex Approvals

Approval details

EAC



RU C-
DE.A*30.B.01082

Phoenix Contact 2018 © - all rights reserved
<http://www.phoenixcontact.com>

PHOENIX CONTACT GmbH & Co. KG
Flachsmarktstr. 8
32825 Blomberg
Germany
Tel. +49 5235 300
Fax +49 5235 3 41200
<http://www.phoenixcontact.com>

Mouser Electronics

Authorized Distributor

Click to View Pricing, Inventory, Delivery & Lifecycle Information:

Phoenix Contact:

2829564