

# WRAPOST RECEPTACLES

FOR .032" - .046" DIAMETER PINS

## 1052/1053

105X-X-17-XX-34-XX-02-0

Press-fit in .083 mounting hole

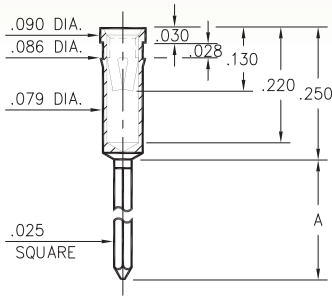

Basic Part Number	# of Wraps	Length A
1053-2	2	.360
1052-3	3	.515

## 0383

0383-X-17-XX-34-XX-02-0

Swage mount in .094 hole

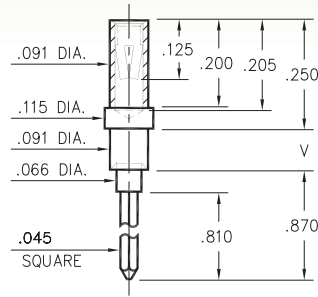

Basic Part Number	Board Thickness	Length V
0383-1	.062	.094
0383-2	.094	.125
0383-3	.125	.156

## 0382

0382-3-17-XX-34-XX-02-0

Press-fit in .089 mounting hole

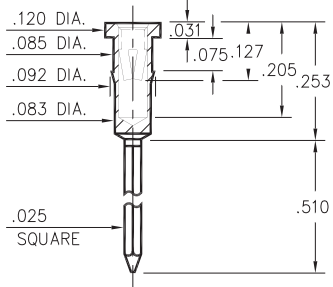

### SPECIFICATIONS:

**Shell Material:** Brass Alloy 360, 1/2 Hard

**Contact Material:** Beryllium Copper Alloy 172, HT

**Dimensions:** Inches

**Tolerances On:** Lengths: ±.005

Diameters: ±.002

Angles: ± 2°



ORDER CODE: XXXX - X - 17 - XX - 34 - XX - 02 - 0

BASIC PART #

SPECIFY SHELL FINISH:

- 01 200 μ" TIN/LEAD OVER NICKEL
- ◆ 80 200 μ" TIN OVER NICKEL (RoHS)
- ◆ 15 10 μ" GOLD OVER NICKEL (RoHS)

SPECIFY CONTACT FINISH:

- 01 200 μ" TIN/LEAD OVER NICKEL
- ◆ 80 200 μ" TIN OVER NICKEL (RoHS)
- ◆ 27 30 μ" GOLD OVER NICKEL (RoHS)

SELECT CONTACT:

#34 CONTACT (DATA ON PAGE 258)

(For alternate contact choices, see group E on page 248)



# Mouser Electronics

Authorized Distributor

Click to View Pricing, Inventory, Delivery & Lifecycle Information:

## Mill-Max:

[1053-2-17-01-34-01-02-0](#) [1053-2-17-01-34-27-02-0](#) [1052-3-17-01-34-27-02-0](#) [0383-3-17-01-34-01-02-0](#) [0383-3-17-01-34-27-02-0](#) [0383-2-17-01-34-01-02-0](#) [0383-2-17-01-34-27-02-0](#) [0383-1-17-01-34-01-02-0](#) [0383-1-17-01-34-27-02-0](#) [0382-3-17-01-34-01-02-0](#) [0382-3-17-01-34-27-02-0](#) [0382-3-17-15-34-27-02-0](#) [0383-1-17-15-34-27-02-0](#) [0383-2-17-15-34-27-02-0](#) [0383-3-17-15-34-27-02-0](#) [1052-3-17-15-34-27-02-0](#) [1053-2-17-15-34-27-02-0](#) [1052-3-17-01-34-01-02-0](#) [0383-3-17-00-00-00-02-0](#) [0383-2-17-00-00-00-02-0](#) [1053-2-17-00-00-00-02-0](#) [0382-3-17-00-00-00-02-0](#) [0383-1-17-00-00-00-02-0](#) [1052-3-17-00-00-00-02-0](#) [1052-3-17-01-34-14-02-0](#) [1052-3-17-80-34-14-02-0](#) [1053-2-17-01-34-14-02-0](#) [0382-3-17-01-34-14-02-0](#) [0382-3-17-80-34-14-02-0](#) [0383-1-17-80-34-14-02-0](#) [0383-2-17-01-34-14-02-0](#) [1053-2-17-80-34-14-02-0](#) [0383-3-17-01-34-14-02-0](#) [0383-1-17-01-34-14-02-0](#) [0383-2-17-80-34-14-02-0](#) [0383-3-17-80-34-14-02-0](#) [1052-3-17-15-34-14-02-0](#)