

THIS DRAWING IS UNPUBLISHED.

RELEASED FOR PUBLICATION

ALL RIGHTS RESERVED.

© COPYRIGHT - By -

LOC

AF

DIST

50

REVISIONS

P	LTR	DESCRIPTION	DATE	DWN	APVD
	R	REVISED PER ECR-13-001204	25JUN13	KH	PD

- CONTINUOUS STRIP ON REELS.
- TIN PLATE 0.00381 [0.000150] MIN OVER 0.00254 [0.000100] MIN THK COPPER OR TIN PLATE 0.00381 [0.000150] MIN OVER 0.00127 [0.000050] MIN THK NICKEL.
- REELED WITH INTERLEAVING PAPER
- OPTIONAL ID MARK, LOCATED APPROX AS SHOWN.
- PRELIMINARY - NOT FOR PRODUCTION
- PREPRODUCTION - FASR REQUIRED

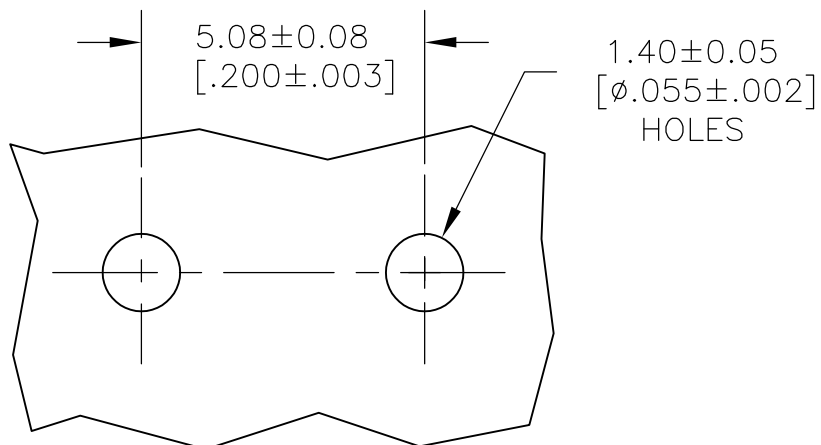

P.C. BOARD HOLE PATTERN

3 STANDARD	BRASS	6 63824-5
REVERSE	BRASS	63824-3
STANDARD	BRASS	5 63824-2
STANDARD	BRASS	63824-1
REELING	MATERIAL	PART NO.

THIS DRAWING IS A CONTROLLED DOCUMENT.

DWN	JR RUTH	20FEB01
CHK	MS FEHER	20FEB01
APVD	N DEIBERT	20FEB01
PRODUCT SPEC		

TE Connectivity

DIMENSIONS:	TOLERANCES UNLESS OTHERWISE SPECIFIED:
mm [INCHES]	
0 PLC	± -
1 PLC	± -
2 PLC	± 0.25 [0.010]
3 PLC	± -
4 PLC	± -
ANGLES	± -

MATERIAL SEE TABLE

FINISH 2

APPLICATION SPEC	114-2115
WEIGHT	-

TAB, FASTON, P.C.BOARD  
6.35 [0.250]

SIZE	CAGE CODE	DRAWING NO	RESTRICTED TO
A3	00779	C-63824	-

CUSTOMER DRAWING

SCALE 8:1 SHEET 1 of 1 REV R

# Mouser Electronics

Authorized Distributor

Click to View Pricing, Inventory, Delivery & Lifecycle Information:

[TE Connectivity:](#)

[63824-1 \(Mouser Reel\)](#) [63824-1 \(Cut Strip\)](#)