

Type PC910 Series

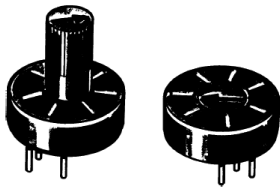

Specify the PC910 series, offering a number of Tyco quality features. This series is ideal for use in many types of professional and industrial equipment, the components have a higher power rating and offer the stability and reliability that come with cermet element technology. The finger adjust styles are widely used in v.d.u. brightness controls and as stable adjustment potentiometers in temperature control and timing applications.

Key Features

- Stable High Resolution Cermet Element
- Proven Reliability
- 1 Watt Power Rating at 40°C
- Resistant to Most PCB Washing Solvents
- Tag Solderability to BS2011 Part 2.1 TA
- Wiper Position Indicator
- Special Log Laws Available
- Replaces the MP Series

Characteristics - Electrical

Std. Resistance Range & Laws:	47 Ohms to 2M2 (Linear) 1 K Ohm to 1 M Ohm (Non-Linear)
Resistance Values:	1, 2.2 and 4.7 in each decade (2 & 5 also available to order)
Selection Tolerance:	± 20% (tighter by request)
Rated Dissipation at 40°C:	1 Watts (Linear); 0.5 Watts (Log)
Limiting Element Voltage:	315 V DC or AC
Electrical Rotation:	240° nominal
Rotational Noise: (C.R.V.)	5 ohms or 5% of total resistance maximum whichever is greater

Characteristics - Mechanical

Starting Torque:	30 mNm maximum
Mechanical Rotation:	270°
End Stop Torque:	90 mNm minimum

Characteristics - Environmental

Limits of Resistance Change:	3% (after 1000 hours endurance)
Temperature Characteristics of Resistance (20°C to 70°C):	0.75%
Climatic Category:	40/100/21
Mechanical Endurance:	200 operations minimum

Dimensions PC910

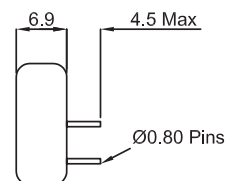
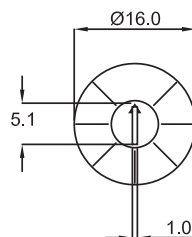

PC911

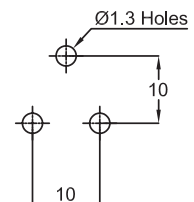
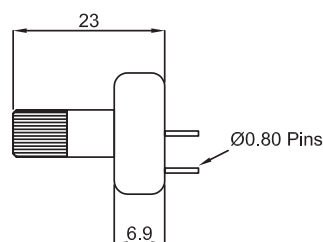
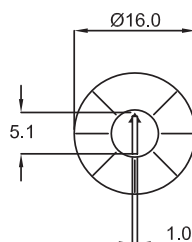

How to Order

PC910	102	M	A
Common Part	Inductance Value	Tolerance	Law
PC910 - Screwdriver Adjust PC911 - Finger Adjust	The first two digits are significant figures of resistance value and the third denotes the number of zeros following. e.g. 1K: 102 10K: 103 100K: 104	K - ±10% M - ±20%	A - Linear B - Stepped Log

We will advise a multidigit Tyco Part Number against this description

Mouser Electronics

Authorized Distributor

Click to View Pricing, Inventory, Delivery & Lifecycle Information:

[TE Connectivity:](#)

[1625940-7](#)