

“Stay Connected” with



Liquid Tight Cordgrips

a PennEngineering® Company



Heyco® -Tite Brass Liquid Tight Cordgrips

Straight-Thru, Pg Hubs

The Ultimate in Liquid Tight Strain Relief Protection

- Nickel plated brass construction for superior protection of flexible cables.
- Nickel-plated finish over brass provides excellent corrosion resistance and durability.
- IP 68 rated.
- For use in clearance or threaded holes.
- Long PG threads provide additional threads for easy locknut assembly.
- Multiple sizes for flexible cord diameters ranging from .138" (3,5 mm) to 1.378" (35,0 mm).
- We recommend using the smallest cordgrip that accommodates your cable size.
- Sealing gland is molded in Thermoplastic Polymer Elastomer (TPE) Material.
- **Locknuts not included.** For metal locknut specifications or to order locknuts separately, see page 3-48.
- DFARS Compliant

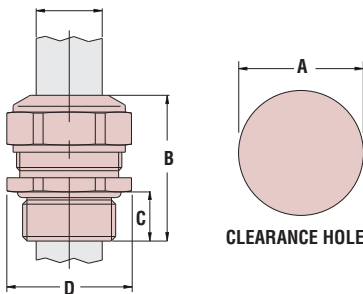

CABLE DIA. RANGE				PART NO.	THREAD SIZE	UL or IEC	PART DIMENSIONS							
Minimum		Maximum					A Clearance Hole Dia.	B Max. O.A. Length		C Thread Length		D Wrenching Nut Flat Size		
in.	mm.	in.	mm.				in.	mm.	in.	mm.	in.	mm.		

Standard Thread

.138	3,5	.197	5,0	4530	PG 7	cULUS	.492	12,5	1.063	27,0	.39	10,0	.59	15,0
.197	5,0	.256	6,5	4531										
.256	6,5	.315	8,0	4532										
.138	3,5	.177	4,5	4533	PG 9	cULUS	.598	15,2	1.18	30,0	.39	10,0	.71	18,0
.177	4,5	.236	6,0	4534										
.236	6,0	.315	8,0	4535										
.315	8,0	.413	10,5	4536	PG 9	cULUS	.598	15,2	1.26	32,0				
.157	4,0	.217	5,5	4537	PG 11	cULUS	.732	18,6	1.22	31,0	.39	10,0	.83	21,0
.217	5,5	.335	8,5	4538										
.335	8,5	.472	12,0	4539										
.236	6,0	.315	8,0	4540	PG 13.5	cULUS	.827	21,0	1.22	31,0	.39	10,0	.94	24,0
.315	8,0	.433	11,0	4541										
.433	11,0	.591	15,0	4542										
.236	6,0	.315	8,0	4543	PG 16	cULUS	.886	22,5	1.30	33,0	.39	10,0	.94	24,0
.315	8,0	.433	11,0	4544										
.433	11,0	.591	15,0	4545										
.374	9,5	.492	12,5	4546	PG 21	cULUS	1.114	28,3	1.57	40,0	.47	12,0	1.18	30,0
.492	12,5	.630	16,0	4547										
.630	16,0	.807	20,5	4548										
.630	16,0	.748	19,0	4549	PG 29	cULUS	1.469	37,3	1.57	40,0	.47	12,0	1.50	38,0
.748	19,0	.905	23,0	4550										
.906	23,0	1.083	27,5	4551										
.846	21,5	1.024	26,0	4552	PG 36	cULUS	1.874	47,6	1.85	47,0	.59	15,0	1.97	50,0
1.024	26,0	1.201	30,5	4553										
1.201	30,5	1.378	35,0	4554										

Short Thread

.138	3,5	.197	5,0	14530	PG 7	cULUS	.492	12,5	.91	23,0	.24	6,0	.59	15,0
.197	5,0	.256	6,5	14531										
.256	6,5	.315	8,0	14532										
.177	4,5	.236	6,0	14534	PG 9	cULUS	.598	15,2	1.02	26,0	.24	6,0	.71	18,0
.236	6,0	.315	8,0	14535										
.315	8,0	.413	10,5	14536										
.157	4,0	.217	5,5	14537	PG 11	cULUS	.732	18,6	1.06	27,0	.24	6,0	.83	21,0
.217	5,5	.335	8,5	14538										
.335	8,5	.472	12,0	14539										
.236	6,0	.315	8,0	14540	PG 13.5	cULUS	.803	20,4	1.06	27,0	.24	6,0	.94	24,0
.315	8,0	.433	11,0	14541										
.433	11,0	.591	15,0	14542										
.236	6,0	.315	8,0	14543	PG 16	cULUS	.886	22,5	1.14	29,0	.24	6,0	.94	24,0
.315	8,0	.433	11,0	14544										
.433	11,0	.591	15,0	14545										
.374	9,5	.492	12,5	14546	PG 21	cULUS	1.114	28,3	1.40	35,5	.30	7,5	1.18	30,0
.492	12,5	.630	16,0	14547										
.630	16,0	.807	20,5	14548										
.748	19,0	.906	23,0	14550	PG 29	cULUS	1.469	37,3	1.42	36,0	.32	8,0	1.50	38,0
.906	23,0	1.083	27,5	14551										
1.024	26,0	1.201	30,5	14553										
1.201	30,5	1.378	35,0	14554	PG 36	cULUS	1.874	47,6	1.85	47,0	.32	8,0	1.97	50,0

Material	Nickel-Plated Brass w/TPE Sealing Gland
Certifications	cULUS Certified by UL for Compliance with both Canadian and U.S. requirements under File E51579.
	cULUS Recognized under the Component Program of Underwriters' Laboratories File E51579 to both Canadian and U.S. requirements.
Temperature Range	-40°F (-40°C) to 212°F (100°C)
IP Rating	IP 68, IP 69K

Quick Specs

Mouser Electronics

Authorized Distributor

Click to View Pricing, Inventory, Delivery & Lifecycle Information:

Heyco:

[4545](#) [4535](#) [4536](#) [4542](#) [4551](#) [4534](#) [4531](#) [4539](#) [4530](#) [4532](#) [14532](#) [14547](#) [14530](#) [14545](#) [14551](#) [14540](#) [14531](#)
[14537](#) [14538](#) [14554](#) [14536](#) [14534](#) [14535](#) [14539](#) [14543](#) [14548](#) [14541](#) [14550](#) [14544](#) [14546](#) [14553](#) [14542](#) [4544](#)
[4553](#) [4552](#) [4546](#) [4555](#) [4549](#) [4550](#) [4547](#) [4541](#) [4543](#) [4557](#) [4554](#) [4556](#) [4540](#) [4533](#) [4548](#) [4537](#) [4538](#)