

## Interface module - DFLK-D25 SUB/S - 2280310

Please be informed that the data shown in this PDF Document is generated from our Online Catalog. Please find the complete data in the user's documentation. Our General Terms of Use for Downloads are valid (<http://phoenixcontact.com/download>)



The VARIOFACE feed-through module implements a 1:1 connection between screw connection terminal blocks and a D-SUB miniature pin strip (number of positions: 25). A separate ground tap is available.

### Product Features

- 9 to 50-pos.
- 9 to 37-pos.: separate ground tap
- 50-pos.: no ground tap
- According to IEC 60807-2
- 1:1 connection
- D-SUB 4-40 UNC thread
- Screw connection



### Key Commercial Data

Packing unit	1 pc
GTIN	 4 017918 054427
Weight per Piece (excluding packing)	87.24 g
Custom tariff number	85369010
Country of origin	Germany

### Technical data

#### Dimensions

Width	39 mm
Height	83.4 mm
Depth	33 mm

#### Ambient conditions

## Interface module - DFLK-D25 SUB/S - 2280310

### Technical data

#### Ambient conditions

Ambient temperature (operation)	-20 °C ... 50 °C
Ambient temperature (storage/transport)	-20 °C ... 70 °C

#### General

Max. perm. operating voltage	125 V AC/DC
Max. perm. current (per branch)	2.5 A
Max. permissible current (all branches)	50 A
Number of positions	25
Mounting position	any
Assembly instructions	In rows with zero spacing
Degree of protection	IP20
Standards/regulations	IEC 60664
	DIN EN 50178
	IEC 62103
Rated insulation voltage	125 V
Rated surge voltage	1.2 kV (Functional insulation)
Degree of pollution	2
Overvoltage category	II

#### Connection data for connection 1

Connection name	Field level
Connection in acc. with standard	IEC / EN
Connection method	Screw connection
Stripping length	8 mm
Screw thread	M3
Conductor cross section solid	0.2 mm <sup>2</sup> ... 4 mm <sup>2</sup>
Conductor cross section flexible	0.2 mm <sup>2</sup> ... 2.5 mm <sup>2</sup>
Conductor cross section AWG	24 ... 12

#### Connection data for connection 2

Connection name	Controller level
Connection method	D-SUB pin strip
Number of positions	25

#### Standards and Regulations

Connection in acc. with standard	CUL
Standards/regulations	IEC 60664
	DIN EN 50178
	IEC 62103

# Interface module - DFLK-D25 SUB/S - 2280310

## Technical data

### Standards and Regulations

Degree of pollution	2
Overvoltage category	II

## Classifications

### eCl@ss

eCl@ss 4.0	27250313
eCl@ss 4.1	27250313
eCl@ss 5.0	27250313
eCl@ss 5.1	27250313
eCl@ss 6.0	27242608
eCl@ss 7.0	27141152
eCl@ss 8.0	27141152
eCl@ss 9.0	27141152

### ETIM

ETIM 2.0	EC001434
ETIM 3.0	EC001604
ETIM 4.0	EC001604
ETIM 5.0	EC002780

### UNSPSC

UNSPSC 6.01	30211824
UNSPSC 7.0901	39121421
UNSPSC 11	39121421
UNSPSC 12.01	39121421
UNSPSC 13.2	39121421

## Approvals

### Approvals

---

#### Approvals

UL Recognized / cUL Recognized / EAC / cULus Recognized

---

#### Ex Approvals

---

# Interface module - DFLK-D25 SUB/S - 2280310

## Approvals

Approvals submitted

### Approval details

UL Recognized	
mm <sup>2</sup> /AWG/kcmil	30-12
Nominal current I <sub>N</sub>	2.5 A
Nominal voltage U <sub>N</sub>	125 V

cUL Recognized	
mm <sup>2</sup> /AWG/kcmil	30-12
Nominal current I <sub>N</sub>	2.5 A
Nominal voltage U <sub>N</sub>	125 V

EAC
-----

cULus Recognized
------------------

## Accessories

Accessories

System cable

Cable - CABLE-D25SUB/B/S/ 50/KONFEK/S - 2302120



Round shielded cable set, with 25-pos. D-SUB female and male connectors, cable length: 0.5 m

## Interface module - DFLK-D25 SUB/S - 2280310

### Accessories

Cable - CABLE-D25SUB/B/S/100/KONFEK/S - 2302133



Round shielded cable set, with 25-pos. D-SUB female and male connectors, cable length: 1 m

---

Cable - CABLE-D25SUB/B/S/150/KONFEK/S - 2302146



Round shielded cable set, with 25-pos. D-SUB female and male connectors, cable length: 1.5 m

---

Cable - CABLE-D25SUB/B/S/200/KONFEK/S - 2302159



Round shielded cable set, with 25-pos. D-SUB female and male connectors, cable length: 2 m

---

Cable - CABLE-D25SUB/B/S/300/KONFEK/S - 2302162



Round shielded cable set, with 25-pos. D-SUB female and male connectors, cable length: 3 m

---

Cable - CABLE-D25SUB/B/S/400/KONFEK/S - 2302175



Round shielded cable set, with 25-pos. D-SUB female and male connectors, cable length: 4 m

---

## Interface module - DFLK-D25 SUB/S - 2280310

### Accessories

Cable - CABLE-D25SUB/B/S/600/KONFEK/S - 2302188



Round shielded cable set, with 25-pos. D-SUB female and male connectors, cable length: 6 m

---

Cable - CABLE D-SUB-S/.../.../... - 2302340



Shielded round cable, assembled with one D-SUB male and one female connector, variable cable length

---

Cable - CABLE D-SUB-B-B-S/.../.../... - 2302421



Shielded round cable, assembled with two D-SUB female connectors, variable cable length

---

Cable - CABLE-D-25SUB/F/OE/0,25/S/0,5M - 2926153



Shielded cable with a 25-pos. D-SUB female connector and one open end. The individual wires are labeled 1 to 25 and fitted with ferrules. The braided shield is routed to a separate cable end. Cable length: 0.5 m.

---

Cable - CABLE-D-25SUB/F/OE/0,25/S/1,0M - 2926166



Shielded cable with a 25-pos. D-SUB female connector and one open end. The individual wires are labeled 1 to 25 and fitted with ferrules. The braided shield is routed to a separate cable end. Cable length: 1 m.

---

## Interface module - DFLK-D25 SUB/S - 2280310

### Accessories

Cable - CABLE-D-25SUB/F/OE/0,25/S/1,5M - 2926179



Shielded cable with a 25-pos. D-SUB female connector and one open end. The individual wires are labeled 1 to 25 and fitted with ferrules. The braided shield is routed to a separate cable end. Cable length: 1.5 m.

---

Cable - CABLE-D-25SUB/F/OE/0,25/S/2,0M - 2926182



Shielded cable with a 25-pos. D-SUB female connector and one open end. The individual wires are labeled 1 to 25 and fitted with ferrules. The braided shield is routed to a separate cable end. Cable length: 2 m.

---

Cable - CABLE-D-25SUB/F/OE/0,25/S/3,0M - 2926195



Shielded cable with a 25-pos. D-SUB female connector and one open end. The individual wires are labeled 1 to 25 and fitted with ferrules. The braided shield is routed to a separate cable end. Cable length: 3 m.

---

Cable - CABLE-D-25SUB/F/OE/0,25/S/4,0M - 2926205



Shielded cable with a 25-pos. D-SUB female connector and one open end. The individual wires are labeled 1 to 25 and fitted with ferrules. The braided shield is routed to a separate cable end. Cable length: 4 m.

---

Cable - CABLE-D-25SUB/F/OE/0,25/S/6,0M - 2926218



Shielded cable with a 25-pos. D-SUB female connector and one open end. The individual wires are labeled 1 to 25 and fitted with ferrules. The braided shield is routed to a separate cable end. Cable length: 6 m.

---

## Interface module - DFLK-D25 SUB/S - 2280310

### Accessories

Cable - CABLE-D-25SUB-F-OE-0,25-S/... - 2900906



Shielded cable with a 25-pos. D-SUB female connector and one open end. The individual wires are labeled 1 to 25 and fitted with ferrules. The braided shield is routed to a separate cable end. Cable length: variable.

### Drawings

Dimensional drawing

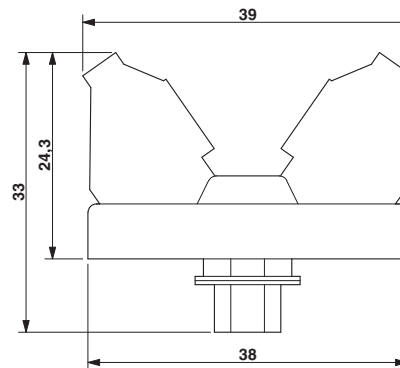



# Interface module - DFLK-D25 SUB/S - 2280310

Dimensional drawing

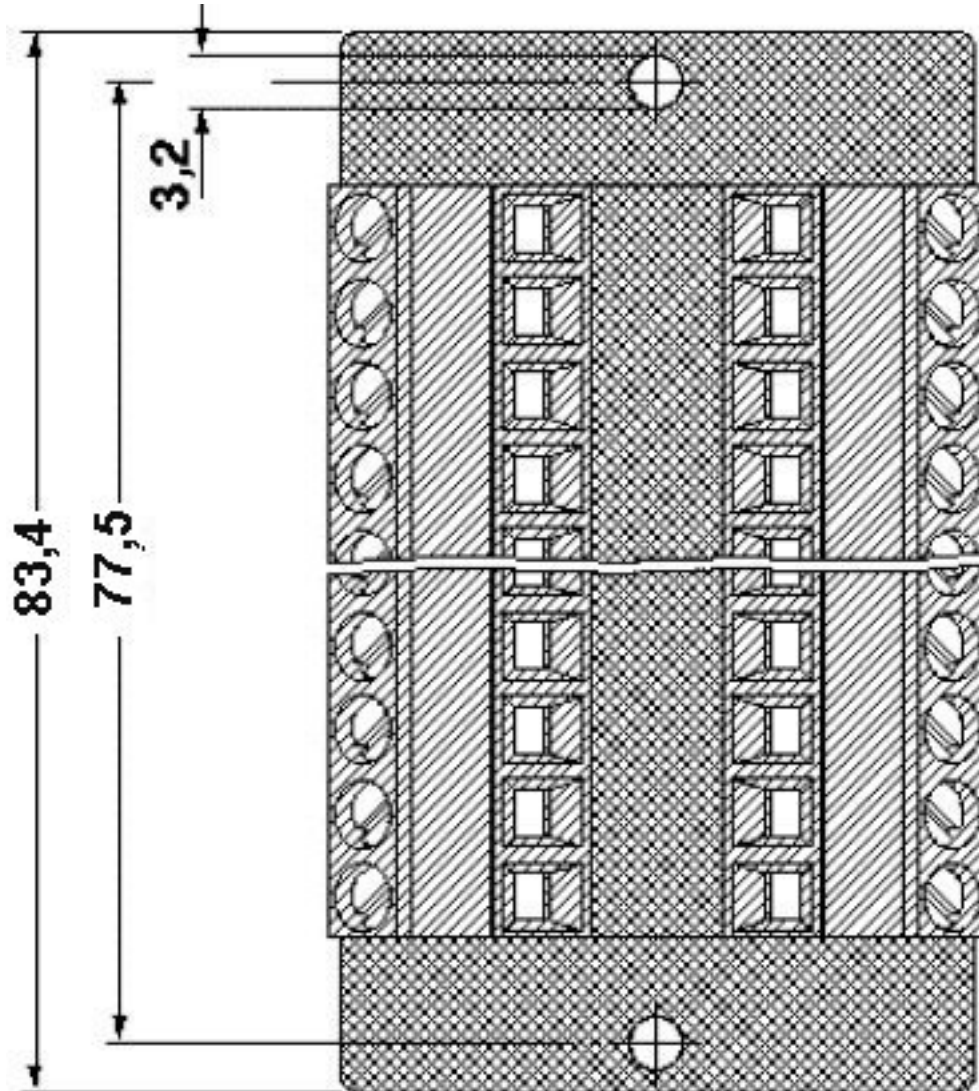

## Interface module - DFLK-D25 SUB/S - 2280310

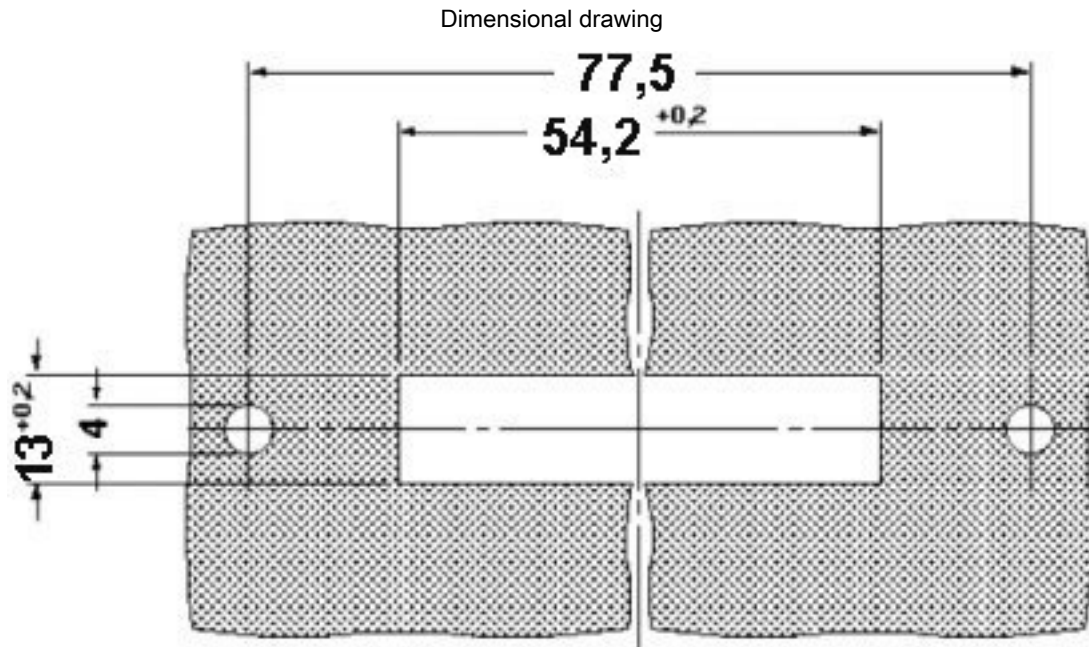

# Mouser Electronics

Authorized Distributor

Click to View Pricing, Inventory, Delivery & Lifecycle Information:

[Phoenix Contact:](#)

[2280310](#)