

Heavy Duty Cable Clamps

561-B0125, 561-B0187, 561-B0250, 561-B0312, 561-B0375, 561-B0437, 561-B0500, 561-B0562, 561-B0625, 561-B0750, 561-B1000, 561-B1250, 561-B1375, 561-B1500

Date Last Revised: 2/13/14

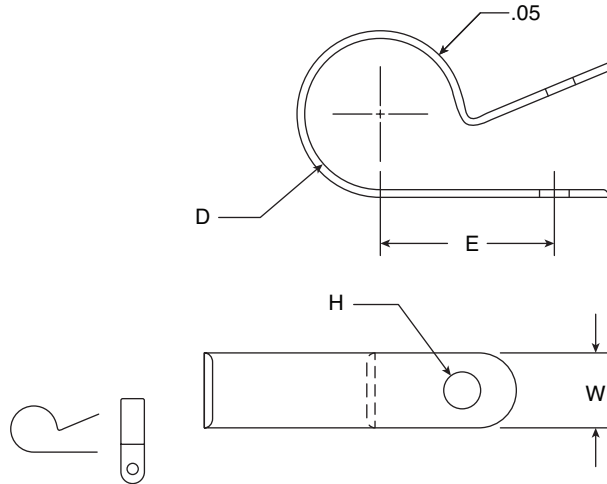

Molded nylon cable clamps secure, insulate, and route cable, wiring, tubing, piping, and fiber optics. These tough, durable, chemical resistant Nylon 6/6 cable clamps are perfect for applications in electronics, automotive, air craft, appliance, and many other industries.

The Heavy Duty Series provides a full 1/2" wide contact area to all critical and heavy duty industrial and commercial applications. All contact edges have a full radius for product protection. Sizes are clearly marked on each clamp.

Dimensions: in.

Part Number	Description	D	W	H	E
561-B0125	Heavy Duty Cable Clamp	0.125	0.500(±.015)	0.203(±.015)	0.315
561-B0187	Heavy Duty Cable Clamp	0.187	0.500(±.015)	0.203(±.015)	0.425
561-B0250	Heavy Duty Cable Clamp	0.250	0.500(±.015)	0.203(±.015)	0.410
561-B0312	Heavy Duty Cable Clamp	0.312	0.500(±.015)	0.203(±.015)	0.500
561-B0375	Heavy Duty Cable Clamp	0.375	0.500(±.015)	0.203(±.015)	0.530
561-B0437	Heavy Duty Cable Clamp	0.437	0.500(±.015)	0.203(±.015)	0.560
561-B0500	Heavy Duty Cable Clamp	0.500	0.500(±.015)	0.203(±.015)	0.595
561-B0562	Heavy Duty Cable Clamp	0.562	0.500(±.015)	0.203(±.015)	0.606
561-B0625	Heavy Duty Cable Clamp	0.625	0.500(±.015)	0.203(±.015)	0.655
561-B0750	Heavy Duty Cable Clamp	0.750	0.500(±.015)	0.203(±.015)	0.780
561-B1000	Heavy Duty Cable Clamp	1.000	0.500(±.015)	0.203(±.015)	0.910
561-B1250	Heavy Duty Cable Clamp	1.250	0.500(±.015)	0.203(±.015)	1.060
561-B1375	Heavy Duty Cable Clamp	1.375	0.500(±.015)	0.203(±.015)	1.125
561-B1500	Heavy Duty Cable Clamp	1.500	0.500(±.015)	0.203(±.015)	1.190

RoHS Compliant

Mouser Electronics

Authorized Distributor

Click to View Pricing, Inventory, Delivery & Lifecycle Information:

Eagle Plastic Devices:

[561-B1250](#) [561-B0437](#) [561-B0125](#) [561-B1000](#) [561-B0500](#) [561-B0625](#) [561-B1500](#) [561-B0375](#) [561-B0250](#) [561-B0750](#) [561-B0562](#) [561-B0187](#) [561-B0312](#)