

4 CIRCUIT SHOWN

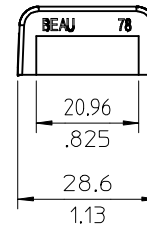

NOTES:

1. MATERIAL: SEE TABLE
2. FINISHES: SEE TABLE
3. "XX" REFERS TO THE QUANTITY OF CIRCUITS.
4. ALL COMPONENTS ARE ROHS COMPLIANT.

REF. REPLACES DRAWING SD-38789-003

8	2(XX)	SCREW W/WASHER, #6-32, PHIL-SLOT (OPT -49 -50)	BRASS	NICKEL PLATED
7	2(XX)	SCREW W/WASHER, #6-32, PHIL-SLOT (OPT -50)	STEEL	ZN, CLEAR CHROMATE
6	2(XX)	SCREW, #6-32, PHIL-SLOT (OPT -49)	BRASS	NICKEL PLATED
5	2(XX)	SCREW, #6-32, SLOTTED (OPT -45)	STEEL	ZN, CLEAR CHROMATE
4	2(XX)	SCREW, #6-32, PHIL-SLOT (STD)	STEEL	ZN, CLEAR CHROMATE
3	XX	TERMINAL (USE W/OPT -49 SCREW)	BRASS	TIN PLATED
2	XX	TERMINAL, PLATE	BRASS	NICKEL PLATED
1	1	INSULATOR, DOUBLE ROW	THERMOPLASTIC	BLACK
ITEM	QTY.	DESCRIPTION	MATERIAL	FINISH

<b>T201741608</b> EC NO: IPG2017-0902 TIDRWAHPURSUTANDEL 2017/09/20 CHKD: APPR: BRUPERT 2017/09/25 REV	QUALITY SYMBOLS ▽=0 ▽=0	GENERAL TOLERANCES (UNLESS SPECIFIED) <table border="1"> <tr> <th></th> <th>mm</th> <th>INCH</th> </tr> <tr> <td>4 PLACES</td> <td>± ---</td> <td>± ---</td> </tr> <tr> <td>3 PLACES</td> <td>± ---</td> <td>± .005</td> </tr> <tr> <td>2 PLACES</td> <td>± 0.13</td> <td>± .01</td> </tr> <tr> <td>1 PLACE</td> <td>± 0.3</td> <td>± ---</td> </tr> </table> ANGULAR ± 2°		mm	INCH	4 PLACES	± ---	± ---	3 PLACES	± ---	± .005	2 PLACES	± 0.13	± .01	1 PLACE	± 0.3	± ---	DIMENSION STYLE MM/IN DRAWN BY: W. HOWARD DATE: 08-28-03 CHECKED BY: R. KEMP DATE: 09-04-03 APPROVED BY: P. WALTZ DATE: 09-05-03	SCALE: 1:1 DESIGN UNITS: INCH THIRD ANGLE PROJECTION
		mm	INCH																
	4 PLACES	± ---	± ---																
	3 PLACES	± ---	± .005																
2 PLACES	± 0.13	± .01																	
1 PLACE	± 0.3	± ---																	
DRAFT WHERE APPLICABLE MUST REMAIN WITHIN DIMENSIONS			MATERIAL NO. SEE SHEET 2 SIZE B	TITLE: 11.11MM [.438] DR BTS, CB ASY MOLEX INCORPORATED DOCUMENT NO. SD-38780-001 SHEET NO. 1 OF 2															
THIS DRAWING CONTAINS INFORMATION THAT IS PROPRIETARY TO MOLEX INCORPORATED AND SHOULD NOT BE USED WITHOUT WRITTEN PERMISSION																			
THIS DRAWING CONTAINS INFORMATION THAT IS PROPRIETARY TO MOLEX INCORPORATED AND SHOULD NOT BE USED WITHOUT WRITTEN PERMISSION																			

Ⓢ

NUMBER OF CIRCUITS "XX"	DIM. "A"		DIM. "B"		DIM. "C"		MATERIAL NO. (STD)	MATERIAL NO. (-45 OPT)	MATERIAL NO. (-49 OPT)	MATERIAL NO. (-50 OPT)	MATERIAL NO. (-10A IMP OPT)	MATERIAL NO. (-49 -50 OPT)
02	41.3	[1.62]	11.11	[.438]	32.83	[1.293]	38780-0102		38780-0202	38780-0302	38780-0502	38789-0401
03	52.4	[2.06]	22.23	[.875]	43.94	[1.730]	38780-0103	38789-0206	38780-0203	38780-0303	38780-0503	
04	63.5	[2.50]	33.34	[1.313]	55.05	[2.168]	38780-0104	38789-0207	38780-0204	38780-0304	38780-0504	38789-0402
05	74.6	[2.94]	44.45	[1.750]	66.17	[2.605]	38780-0105		38780-0205	38780-0305	38780-0505	
06	85.7	[3.37]	55.56	[2.188]	77.28	[3.043]	38780-0106	38789-0209	38780-0206	38780-0306	38780-0506	
07	96.8	[3.81]	66.68	[2.625]	88.39	[3.480]	38780-0107		38780-0207	38780-0307	38780-0507	
08	107.9	[4.25]	77.79	[3.063]	99.50	[3.918]	38780-0108		38780-0208	38780-0308	38780-0508	38789-0403
09	119.0	[4.69]	88.90	[3.500]	110.62	[4.355]	38780-0109		38780-0209	38780-0309	38780-0509	
10	130.2	[5.12]	100.01	[3.938]	121.73	[4.793]	38780-0110	38789-0211	38780-0210	38780-0310	38780-0510	
11	141.3	[5.56]	111.13	[4.375]	132.84	[5.230]	38780-0111		38780-0211	38780-0311	38780-0511	
12	152.4	[6.00]	122.24	[4.813]	143.95	[5.668]	38780-0112		38780-0212	38780-0312	38780-0512	38789-0404
13	163.5	[6.44]	133.35	[5.250]	155.07	[6.105]	38780-0113		38780-0213	38780-0313	38780-0513	
14	174.6	[6.87]	144.46	[5.688]	166.18	[6.543]	38780-0114		38780-0214	38780-0314	38780-0514	
15	185.7	[7.31]	155.58	[6.125]	177.29	[6.980]	38780-0115		38780-0215	38780-0315	38780-0515	
16	196.8	[7.75]	166.69	[6.563]	188.40	[7.418]	38780-0116	38789-0212	38780-0216	38780-0316	38780-0516	
17	207.9	[8.19]	177.80	[7.000]	199.52	[7.855]	38780-0117		38780-0217	38780-0317	38780-0517	
18	219.1	[8.62]	188.91	[7.438]	210.63	[8.293]	38780-0118		38780-0218	38780-0318	38780-0518	
19	230.2	[9.06]	200.03	[7.875]	221.74	[8.730]	38780-0119		38780-0219	38780-0319	38780-0519	
20	241.3	[9.50]	211.14	[8.313]	232.85	[9.168]	38780-0120		38780-0220	38780-0320	38780-0520	
21	252.4	[9.94]	222.25	[8.750]	243.97	[9.605]	38780-0121		38780-0221	38780-0321	38780-0521	
22	263.5	[10.37]	233.36	[9.188]	255.08	[10.043]	38780-0122		38780-0222	38780-0322	38780-0522	
23	274.6	[10.81]	244.48	[9.625]	266.19	[10.480]	38780-0123		38780-0223	38780-0323	38780-0523	
24	285.7	[11.25]	255.59	[10.063]	277.30	[10.918]	38780-0124		38780-0224	38780-0324	38780-0524	
25	296.8	[11.69]	266.70	[10.500]	288.42	[11.355]	38780-0125		38780-0225	38780-0325	38780-0525	
26	308.0	[12.12]	277.81	[10.938]	299.53	[11.793]	38780-0126		38780-0226	38780-0326	38780-0526	
27	319.1	[12.56]	288.93	[11.375]	310.64	[12.230]	38780-0127		38780-0227	38780-0327	38780-0527	
28	330.2	[13.00]	300.04	[11.813]	321.75	[12.668]	38780-0128		38780-0228	38780-0328	38780-0528	
29	341.3	[13.44]	311.15	[12.250]	332.87	[13.105]	38780-0129		38780-0229	38780-0329	38780-0529	
30	352.4	[13.87]	322.26	[12.688]	343.98	[13.543]	38780-0130		38780-0230	38780-0330	38780-0530	

<b>T201741608</b> EC NO: IPG2017-0902 TIDRWAHPURSUTANDEL 2017/09/20 CHKD: APPR: BRUPERT 2017/09/25 REV	QUALITY SYMBOLS ▽=0 ▽=0	GENERAL TOLERANCES (UNLESS SPECIFIED) mm INCH 4 PLACES ± --- ± --- 3 PLACES ± --- ± .005 2 PLACES ± 0.13 ± .01 1 PLACE ± 0.3 ± --- ANGULAR ± 2 °	DIMENSION STYLE MM/IN DRAWN BY DATE W. HOWARD 08-28-03 CHECKED BY DATE R. KEMP 09-04-03 APPROVED BY DATE P. WALTZ 09-05-03	SCALE 1:1 DESIGN UNITS INCH THIRD ANGLE PROJECTION
	DRAFT WHERE APPLICABLE MUST REMAIN WITHIN DIMENSIONS			TITLE 11.11MM [.438] DR BTS, CB ASY
	MATERIAL NO.		DOCUMENT NO. SD-38780-001	SHEET NO. 2 OF 2
	THIS DRAWING CONTAINS INFORMATION THAT IS PROPRIETARY TO MOLEX INCORPORATED AND SHOULD NOT BE USED WITHOUT WRITTEN PERMISSION			

# Mouser Electronics

Authorized Distributor

Click to View Pricing, Inventory, Delivery & Lifecycle Information:

[Molex:](#)

[38780-0105](#)