

DC Power Plug

171-3209

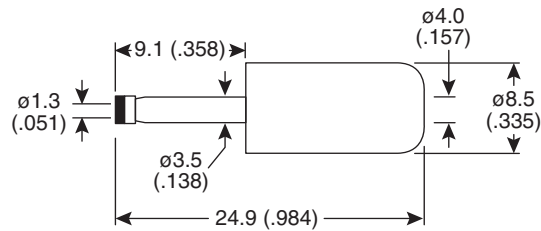

DC Power Plug

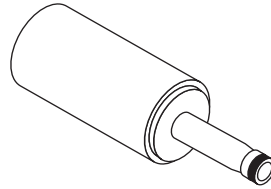

Dimensions: mm (In)

SPECIFICATIONS

Type:	Locking DC Power
Power Rating:	1A/12VDC
Insulation Resistance:	100M Ω min. @ 500VDC
Contact Resistance:	50m Ω max.
Voltage Breakdown:	500VAC for 1 Minute
Cap:	ABS Plastic
Inner Insulator:	Ebonite
Top Insulator:	Duracon
Body, Pin:	Nickel Plated Brass

Date Last Revised: 4-14-05

Available from Mouser Electronics
1-800-346-6873
www.mouser.com

KC-300465

171-3209

Mouser Electronics

Authorized Distributor

Click to View Pricing, Inventory, Delivery & Lifecycle Information:

[Kobiconn:](#)

[171-3209](#)