

## Cable lug - C-PCI 2,5/2 - 3240066

Please be informed that the data shown in this PDF Document is generated from our Online Catalog. Please find the complete data in the user's documentation. Our General Terms of Use for Downloads are valid (<http://phoenixcontact.com/download>)



Pin cable lug, blue, 1.5 - 2.5 mm<sup>2</sup>, L1=12 mm

### Your advantages

- ✓ Hard-soldered crimping zone for maximum pull-out forces
- ✓ Electrolytic tin plating
- ✓ Halogen-free
- ✓ 'EASY ENTRY' for easy and reliable conductor entry

### Key Commercial Data

Packing unit	100 pc
Minimum order quantity	100 pc
GTIN	 4 046356 452847
GTIN	4046356452847

### Technical data

#### Dimensions

Length (b)	23 mm
Maximum stripping length	8 mm
Length contact range	12 mm
Length of insulation sleeve (c)	11 mm
Inner dimension of the insulating collar (d)	4.5 mm
Inner diameter (f)	2 mm
Material thickness (g)	0.8 mm

#### Ambient conditions

Ambient temperature (operation)	-20 °C ... 105 °C
---------------------------------	-------------------

#### General

# Cable lug - C-PCI 2,5/2 - 3240066

## Technical data

### General

Color	blue
Stripping length	8 mm
Components	halogen-free
Flammability rating according to UL 94	V2
Material	Copper
Insulating material	PA
Coating	tin-plated

### Standards and Regulations

Flammability rating according to UL 94	V2
--	----

### Environmental Product Compliance

China RoHS	Environmentally friendly use period: unlimited = EFUP-e
	No hazardous substances above threshold values

## Drawings

Dimensional drawing

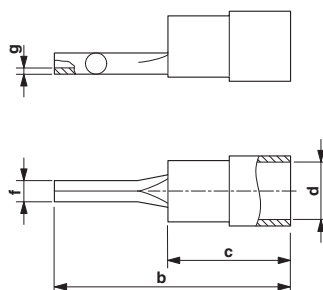

## Approvals

### Approvals

---

Approvals

EAC / EAC

---

Ex Approvals

---

### Approval details

EAC		7500651.22.01.00246
-----	--	---------------------

## Cable lug - C-PCI 2,5/2 - 3240066

### Approvals

EAC



EAC-Zulassung

Phoenix Contact 2019 © - all rights reserved  
<http://www.phoenixcontact.com>

PHOENIX CONTACT GmbH & Co. KG  
Flachsmarktstr. 8  
32825 Blomberg  
Germany  
Tel. +49 5235 300  
Fax +49 5235 3 41200  
<http://www.phoenixcontact.com>