

REVISIONS					
P	LTR	DESCRIPTION	DATE	DWN	APVD
	B	PANEL MOUNTING HOLES CHANGED	23JUN16	FP	NG

NOTES

PHYSICAL PROPERTIES:

HOUSING MATERIAL: PBT

FLAMMABILITY: UL94V-0

COLOR: BLACK

MAX BOW/WARP: .0056 IN/IN.

TERMINAL:

TERMINALS: BRASS, TIN PLATED. (UNLESS OTHERWISE STATED)

SCREWS: 8-32 STEEL, NICKEL PLATED. (UNLESS OTHERWISE STATED)

Q.C. TABS: BRASS, NICKEL PLATED.

MECHANICAL:

PITCH (TERMINAL SPACING): .563"

WIRE RANGE: 10-22 AWG

RECOMMENDED TIGHTENING TORQUE: 14IN-LBS MAX.

ELECTRICAL PROPERTIES:

MAXIMUM CURRENT: 30A

OPERATING VOLTAGE: 600V

ENVIRONMENTAL PROPERTIES:

OPERATING TEMP RANGE: -40° TO +120°C

- 1

NICKEL PLATED BRASS SCREWS.
- 2

PRELIMINARY PART NUMBER.

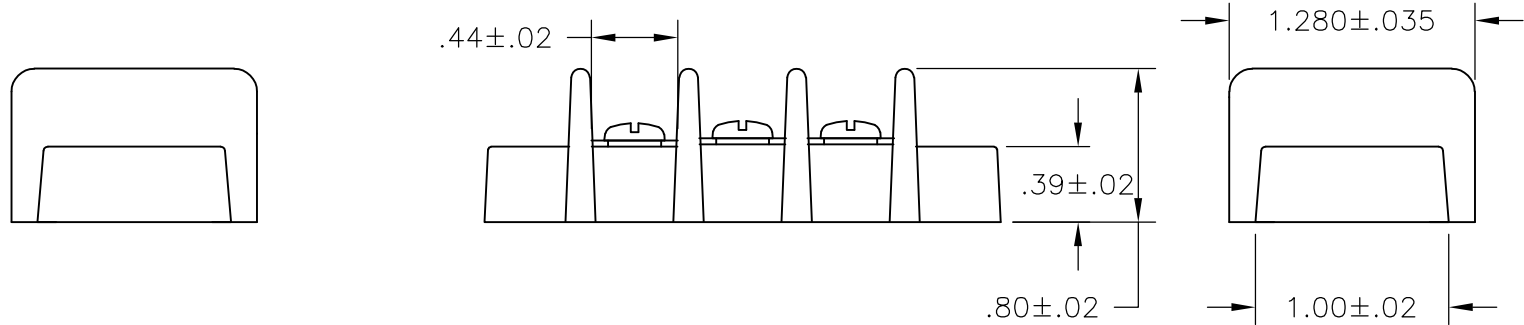
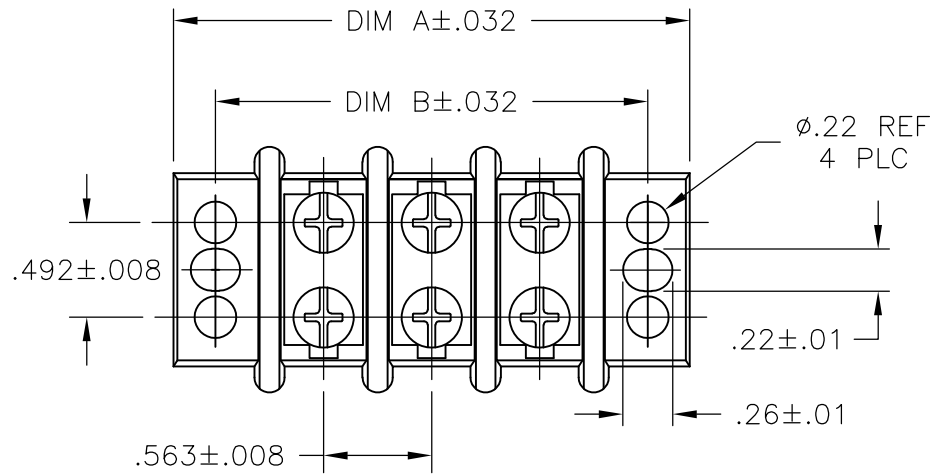

	-	-	-	-	-	-	-	-	-	10.701	11.138	18	1-1776544-8							
	-	-	-	-	-	-	-	-	-	10.138	10.575	17	1-1776544-7							
	-	-	-	-	-	-	-	-	-	9.575	10.012	16	1-1776544-6							
	-	-	-	-	-	-	-	-	-	9.012	9.449	15	1-1776544-5							
	-	-	-	-	-	-	-	-	-	8.449	8.886	14	2-1776544-4							
	-	-	-	-	-	-	-	-	-	8.449	8.886	14	1-1776544-4							
	-	-	-	-	-	-	-	-	-	7.886	8.323	13	1-1776544-3							
	-	-	-	-	-	-	-	-	-	7.323	7.760	12	1-1776544-2							
	-	-	-	-	-	-	-	-	-	6.760	7.179	11	2-1776544-3							
	-	-	-	-	-	-	-	-	-	6.760	7.179	11	1-1776544-1							
	-	-	-	-	-	-	-	-	-	6.197	6.634	10	2-1776544-2							
	-	-	-	-	-	-	-	-	-	6.197	6.634	10	1-1776544-0							
	-	-	-	-	-	-	-	-	-	5.634	6.071	9	1776544-9							
	-	-	-	-	-	-	-	-	-	5.071	5.508	8	2-1776544-5							
	-	-	-	-	-	-	-	-	-	5.071	5.508	8	1776544-8							
	-	-	-	-	-	-	-	-	-	4.508	4.945	7	1776544-7							
	-	-	-	-	-	-	-	-	-	3.945	4.382	6	2-1776544-1							
	-	-	-	-	-	-	-	-	-	3.945	4.382	6	1776544-6							
	-	-	-	-	-	-	-	-	-	3.382	3.819	5	1776544-5							
	-	-	-	-	-	-	-	-	-	2.819	3.256	4	2-1776544-0							
	-	-	-	-	-	-	-	-	-	2.819	3.256	4	1776544-4							
	-	-	-	-	-	-	-	-	-	2.256	2.693	3	1-1776544-9							
	-	-	-	-	-	-	-	-	-	2.256	2.693	3	1776544-3							
	-	-	-	-	-	-	-	-	-	1.693	2.130	2	1776544-2							
NOTES		.250 QC TAB 90° DOUBLE SIDE		.250 QC TAB 90°/45° DOUBLE SIDE		.250 QC TAB 90° DOUBLE SIDE		.250 QC TAB 45° DOUBLE SIDE		.250 QC TAB STRAIGHT DOUBLE SIDE		.250 QC TAB 90° SINGLE SIDE		.250 QC TAB 45° SINGLE SIDE		.250 QC TAB STRAIGHT SINGLE SIDE	DIM B	DIM A	NO. OF POSN	PART NUMBER

THIS DRAWING IS A CONTROLLED DOCUMENT.

DIMENSIONS:
INCHES

MATERIAL
-

TOLERANCES UNLESS
OTHERWISE SPECIFIED:

0 PLC ± -
1 PLC ± -
2 PLC ± -
3 PLC ± -
4 PLC ± -
ANGLES ± -
FINISH -

DWN
S SCHLEGEL
2/21/07

CHK
S YODER
2/21/07

APVD
S YODER
2/21/07

PRODUCT SPEC
-

APPLICATION SPEC
-

WEIGHT
0.000000

CUSTOMER DRAWING

TE Connectivity

NAME
14.3 (.563) DBL ROW BARRIER STRIP
W/O WASHER, 600v

SIZE
A2

CAGE CODE
00779

DRAWING NO
C=1776544

RESTRICTED TO
-

SCALE
NTS

SHEET
1 of 1

REV
B

Mouser Electronics

Authorized Distributor

Click to View Pricing, Inventory, Delivery & Lifecycle Information:

[TE Connectivity:](#)

[3-796608-1](#) [3-796612-1](#) [1776544-3](#) [JC6-E107-04](#) [1986158-5](#) [1776249-5](#) [1776544-4](#) [3PCR-10-008](#) [1776006-4](#)
[1776544-5](#)