

Terminals

159-2200 Series

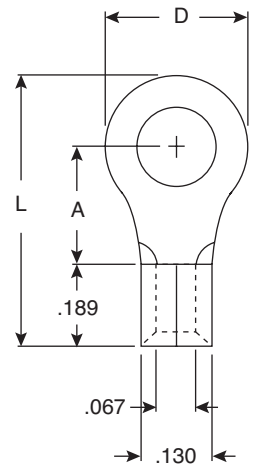

Terminals

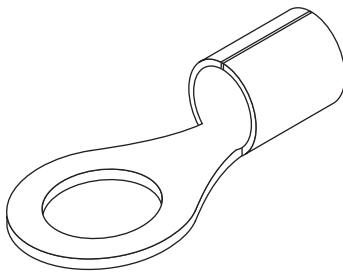

Dimensions: In.

SPECIFICATIONS	
Wire range:	22 -16 AWG
Material:	Copper
Material thickness:	0.032"

Mouser Stock No.	Stud Size	Dimensions (IN.)		
		D	L	A
159-2222	4	.224	.496	.194
159-2223	6	.224	.496	.194
159-2224	8	.314	.622	.275
159-2227	10	.314	.622	.275
159-2229	1/4	.457	.858	.437
159-2231	5/16	.457	.858	.437

1549-2200 Series

Date Last Revised: 10-18-05

Available from Mouser Electronics
 1-800-346-6873
 www.mouser.com

KC-300027

Specifications are subject to change without notice. No liability or warranty implied by this information. Environmental compliance based on producer documentation.

Mouser Electronics

Authorized Distributor

Click to View Pricing, Inventory, Delivery & Lifecycle Information:

[Kobiconn:](#)

[159-2223](#) [159-2222](#) [159-2227](#) [159-2224](#) [159-2229](#) [159-2231](#)