

DETAIL 1
SCALE 5:1

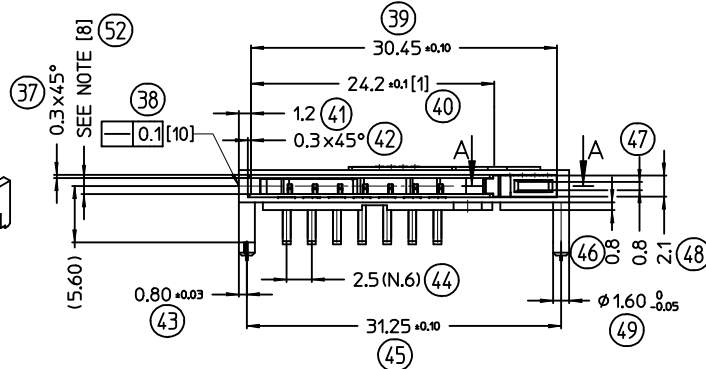

CO-PLANARITY OF
THE SOLDER TAILS
= 0.1 mm MAX

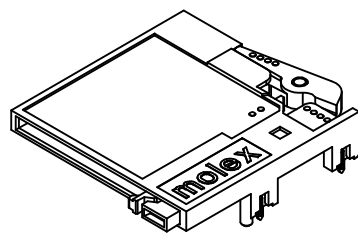
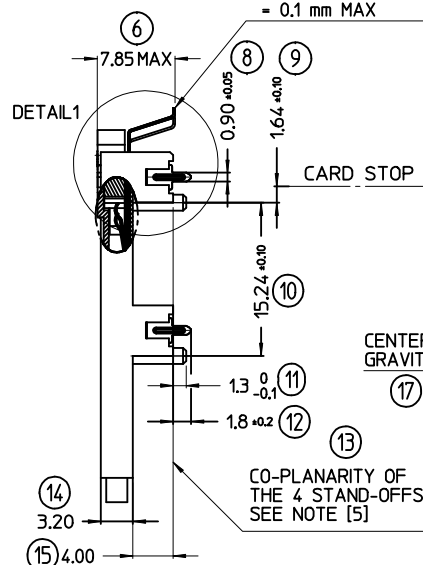

CENTER OF
GRAVITY

CO-PLANARITY OF
THE 4 STAND-OFFS:
SEE NOTE [5]

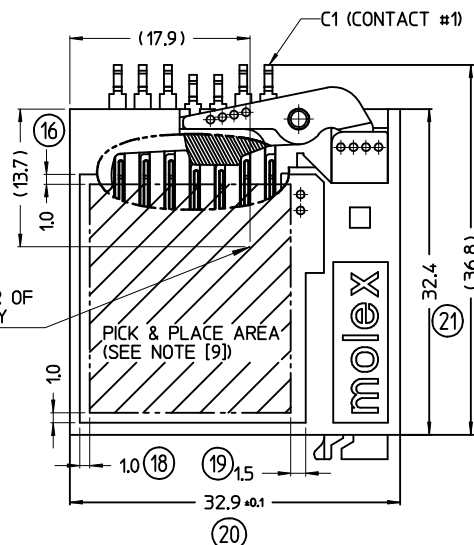

C1 (CONTACT #1)

PICK & PLACE AREA
(SEE NOTE [9])

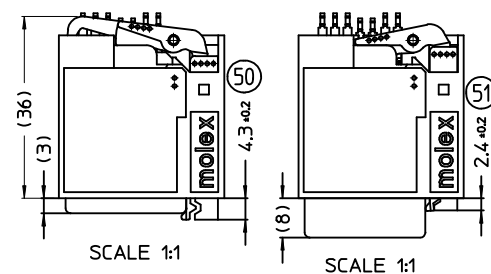

SCALE 1:1

SCALE 1:1

SEC. A-A (PARTIAL)
ACTUATOR BAR DETAIL

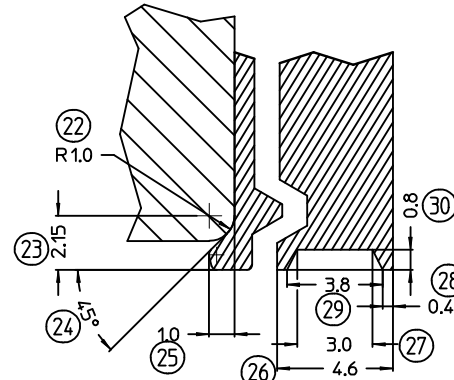

PCB LAYOUT (COMPONENT SIDE)
SCALE 1:1

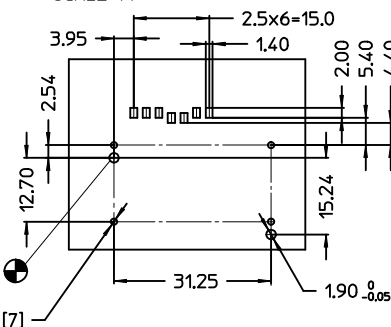

REFERENCE POINT (0,0)

MATERIALS:
PLASTIC COMPONENTS: LCP 30% G.F. BLACK (HOUSING)
PA 4,6 30% G.F. RAL 6034 (EJECTOR PARTS)
TERMINALS: Ph-Bz CuSn 8 0.20 THICK
PLATING: CONTACT AREA: 0.76 μ m Au MIN OVER 127 μ m Ni MIN
SOLDERING AREA: 3.8 μ m Sn MIN OVER 127 μ m Ni MIN
SOLDER PINS: PhBz CuSn 6 0.20 THICK, TIN PRE-PLATED

NOTES:

- [1] WIDTH OF THE CARD SLOT
- [2] PACKAGING: SEE DRAWING PK-94351-001
- [3] ALL DIMENSIONS SHALL CONFORM TO MMC SYSTEM SPECIFICATIONS
- [4] PRODUCT CHARACTERISTIC ACCORDING TO: PS-94351-001
- [5] WITH REFERENCE TO THE PLANE (THE SEATING PLANE) GIVEN BY THE LOWEST OF THE SEVEN SOLDER TAILS AND THE TWO FRONT STAND-OFFS, THE OTHER TWO STAND-OFFS, PROVIDED THAT THEIR HEIGHT IS ACCORDING TO THE DRAWING, SHALL NOT CROSS-OVER THE SEATING PLANE
- [6] MEASURED FROM THE REFERENCE PLANE
- [7] DIAMETER OF TINNING AROUND THE PCB HOLE = 1.9 mm, DIAMETER OF SOLDERING PASTE = 2.5 mm
- [8] HEIGHT OF THE CARD SLOT: 1.60 +0.10/-0.05 mm @ THE SIDES OF THE SLOT, 1.60 +0.10/-0.10 @ THE CENTER OF THE SLOT
- [9] PICK & PLACE AREA FREE OF FLASHES, GATE MARKS, FAT
- [10] STRAIGHTNESS OF THE CARD SLOT AXIS

Std Descr.: MMC CONN W/EJECTOR 4 HIGH*

EC NO: Z2010-0111 DRWN: GZUIN 2010/01/22 CHKD: L.SANTOS 2000/01/20 APPR: FBSELLO 2010/07/05	DESCRIPTION	QUALITY SYMBOLS	GENERAL TOLERANCES (UNLESS SPECIFIED)			SCALE 2:1	DESIGN UNITS METRIC	FIRST ANGLE PROJECTION		REVISE ON CAD ONLY					
						DIMENSION STYLE MM ONLY		TITLE MMC CONNECTOR WITH EJECTOR (H=4 MM)							
			4 PLACES	mm	INCH										
			3 PLACES	± ---	± ---	DRAWN BY DATE									
			2 PLACES	± 0.05	± ---	RDAGOSTI 2000/01/20									
			1 PLACE	± 0.15	± ---	CHECKED BY DATE									
						ANGULAR ± 2 °		MTESTAGU 2000/01/20		molex MOLEX INCORPORATED					
			DRAFT WHERE APPLICABLE			APPROVED BY DATE		GZUIN 2000/01/20		MATERIAL NO.		DOCUMENT NO.		SHEET NO.	
			MUST REMAIN WITHIN DIMENSIONS							94351-5002		SD-94351-001		1 OF 1	
			THIS DRAWING CONTAINS INFORMATION THAT IS PROPRIETARY TO MOLEX INCORPORATED AND SHOULD NOT BE USED WITHOUT WRITTEN PERMISSION											A3	

Mouser Electronics

Authorized Distributor

Click to View Pricing, Inventory, Delivery & Lifecycle Information:

Molex:

94351-5002