

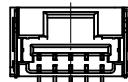

2 CKT.



5 CKT.



3 CKT.

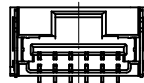

6 CKT.

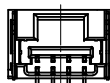

4 CKT.

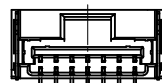

7 CKT.

極数の種類

KIND OF CKT. NO. (FRONT VIEW)

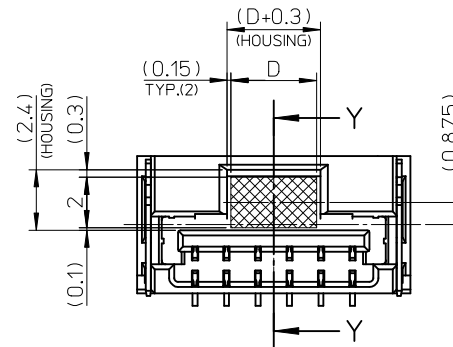

吸着範囲
VACUME AREA

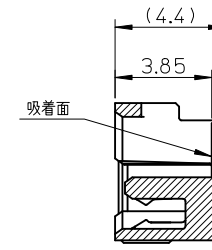

SECTION Y-Y

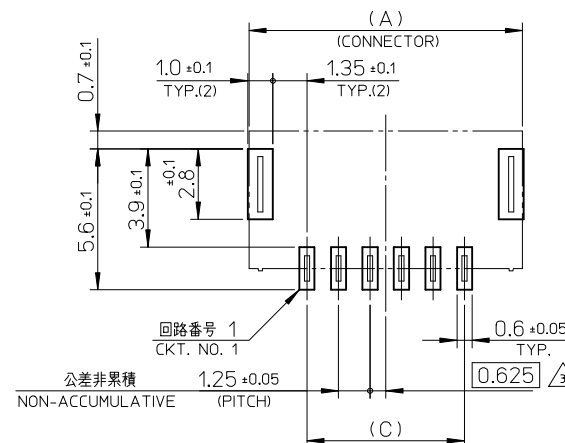

基板パターンレイアウト (参考)
RECOMMENDED P.C.B. PATTERN LAYOUT (REF.)

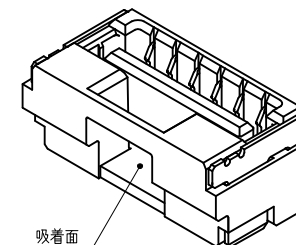

REVISED EC NO.: J2013-1131 TDRWN:SSAT002 CHKD:KASAKAWA APPR:Y01TO 2013/04/08 2013/04/08 2013/04/08	DESCRIPTION REV	GENERAL TOLERANCES (UNLESS SPECIFIED)		DIMENSION STYLE MM ONLY		SCALE 5:1	DESIGN UNITS METRIC	THIRD ANGLE PROJECTION		
		10 UNDER	± 0.2	DRAWN BY T.MIYAZAKI	DATE 2006/08/28	TITLE 1.25 W/B CONN. SINGLE S/T REC. ASS'Y 2-7CKT.				
		10 OVER 30 UNDER	± 0.25	CHECKED BY K.ASAKAWA	DATE 2006/08/28					
		30 OVER	± 0.3	APPROVED BY Y01.ITO	DATE 2006/08/28	molex				
		ANGULAR ±3 °		MATERIAL NO.						
		DRAFT WHERE APPLICABLE MUST REMAIN WITHIN DIMENSIONS		SEE TABLE		SD-502382-001			2 OF 3	
				SIZE A3	THIS DRAWING CONTAINS INFORMATION THAT IS PROPRIETARY TO MOLEX INCORPORATED AND SHOULD NOT BE USED WITHOUT WRITTEN PERMISSION					

	10	9	8	7	6	5	4	3	2	1	
F											F
E											E
D											D
C											C
B											B
A											A
WITH CAPTON TAPE											
HSG COLOR : GREEN		HSG COLOR : BLUE		HSG COLOR : RED		HSG COLOR : BLACK		HSG COLOR : NATURAL			
502382-0736	502382-**16	502382-0734	502382-**14	502382-0732	502382-**12	502382-0731	502382-**11	502382-0772	502382-**08	7	
502382-0636		502382-0634		502382-0632		502382-0631		502382-0672		6	
502382-0536		502382-0534		502382-0532		502382-0531		502382-0572		5	
502382-0436		502382-0434		502382-0432		502382-0431		502382-0472		4	
502382-0336		502382-0334		502382-0332		502382-0331		502382-0372		3	
502382-0236		502382-0234		502382-0232		502382-0231		502382-0272		2	
EMBOSSED TAPE PACKAGE	コネクタシリーズ	EMBOSSED TAPE PACKAGE	コネクタシリーズ	EMBOSSED TAPE PACKAGE	コネクタシリーズ	EMBOSSED TAPE PACKAGE	コネクタシリーズ	EMBOSSED TAPE PACKAGE	コネクタシリーズ	極数	
オーダー番号ORDER No.	CONNECTOR SERIES	オーダー番号ORDER No.	CONNECTOR SERIES	オーダー番号ORDER No.	CONNECTOR SERIES	オーダー番号ORDER No.	CONNECTOR SERIES	オーダー番号ORDER No.	CONNECTOR SERIES	極数	CT. NO.
WITHOUT CAPTON TAPE											
HSG COLOR : NATURAL											
502382-0770	502382-**09	502382-0670	502382-**09	502382-0570	502382-**09	502382-0470	502382-**09	502382-0370	502382-**09	7	
502382-0670		502382-0570		502382-0470		502382-0370		502382-0270		6	
502382-0570		502382-0470		502382-0370		502382-0270		502382-0170		5	
502382-0470		502382-0370		502382-0270		502382-0170		502382-0070		4	
502382-0370		502382-0270		502382-0170		502382-0070		502382-0000		3	
502382-0270		502382-0170		502382-0070		502382-0000		502382-0000		2	
EMBOSSED TAPE PACKAGE	コネクタシリーズ	EMBOSSED TAPE PACKAGE	コネクタシリーズ	EMBOSSED TAPE PACKAGE	コネクタシリーズ	EMBOSSED TAPE PACKAGE	コネクタシリーズ	EMBOSSED TAPE PACKAGE	コネクタシリーズ	極数	
オーダー番号ORDER No.	CONNECTOR SERIES	オーダー番号ORDER No.	CONNECTOR SERIES	オーダー番号ORDER No.	CONNECTOR SERIES	オーダー番号ORDER No.	CONNECTOR SERIES	オーダー番号ORDER No.	CONNECTOR SERIES	極数	CT. NO.
GENERAL TOLERANCES (UNLESS SPECIFIED)											
DIMENSION STYLE MM ONLY											
SCALE --- METRIC											
THIRD ANGLE PROJECTION											
1.25 W/B CONN. SINGLE S/T REC. ASS'Y 2-7CKT.											
molex											
SD-502382-001											
3 OF 3											
THIS DRAWING CONTAINS INFORMATION THAT IS PROPRIETARY TO MOLEX INCORPORATED AND SHOULD NOT BE USED WITHOUT WRITTEN PERMISSION											

Mouser Electronics

Authorized Distributor

Click to View Pricing, Inventory, Delivery & Lifecycle Information:

Molex:

502382-0672