

REV.	DATE	DESCRIPTION
A	01/30/04	UPDATE DRAWNG FORMAT
B	03/10/08	REVISE BODY, ADD KNURLED MID-SECTION

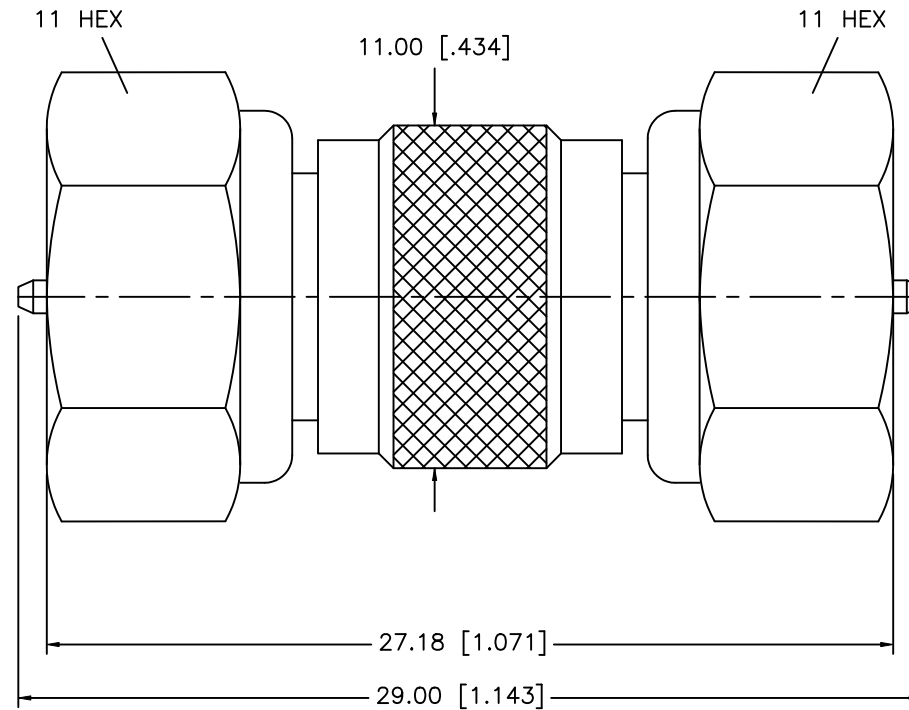

8				
7				
6				
5				
4				
3	CONTACT PIN	BRASS	NICKEL	1
2	INSULATOR	DELRIN	NATURAL	1
1	BODY	BRASS	NICKEL	2
	DESCRIPTION	MATERIAL	FINISH	QTY

UNLESS OTHERWISE SPECIFIED DIMENSIONS ARE IN MILLIMETERS. DIMENSIONS IN [] ARE IN INCHES AND FOR CUSTOMER REFERENCE ONLY.

UNLESS OTHERWISE SPECIFIED TOLERANCES FOR MILLIMETERS ARE:
0.5 - 8mm ± 0.20mm
8 - 30mm ± 0.40mm
30 - 120mm ± 0.50mm

UNLESS OTHERWISE SPECIFIED TOLERANCES FOR INCHES ARE:
.020 - .315 = ± 0.007"
.315 - 1.180 = ± 0.015"
1.180 - 4.724 = ± 0.020"

DO NOT SCALE DRAWING

APPROVALS	DATE
DRAWN G.R.S.	03/10/08
CHECKED	
ISSUED	
SHEET 1 OF 1	
CAD FILE	C:/222/222156.DWG

Amphenol Connex

PART DESCRIPTION

F MALE TO MALE

-

PART NO.

222156

DWG. NO.

222156.DWG

REV. B

SIZE A

SCALE NA

Mouser Electronics

Authorized Distributor

Click to View Pricing, Inventory, Delivery & Lifecycle Information:

[Amphenol:](#)

[222156](#)