

THIS DRAWING IS UNPUBLISHED. RELEASED FOR PUBLICATION  
 © COPYRIGHT - By - ALL RIGHTS RESERVED.

| REVISIONS |     |                           |           |        |
|-----------|-----|---------------------------|-----------|--------|
| P         | LTR | DESCRIPTION               | DATE      | APVD   |
| S10       |     | REVISED PER ECR-18-002594 | 27FEB2018 | BDA KR |

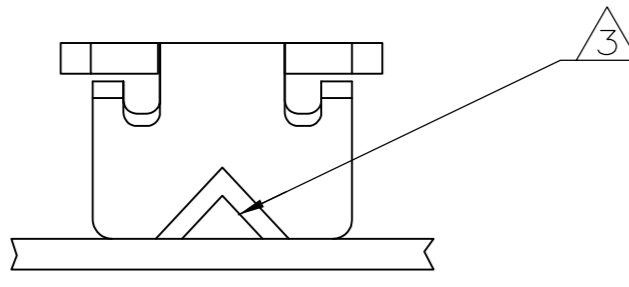

- 1 CONTINUOUS STRIP ON REELS WITH TERMINALS LOCATED ON 5.59±0.08 [.220±.003] CENTERS.
- 2 SLOT ACCEPTS 0.80-1.20mm [#20-#16.5] AWG COPPER MAGNET WIRE.  
SLOT ACCEPTS 0.95-1.15mm [#18.5-#17] AWG ALUMINUM MAGNET WIRE.  
ALUMINUM WIRE RANGE APPLIES FOR POST-TIN PLATED VERSIONS ONLY. A SINGLE WIRE ONLY.
- 3 POKE-IN ACCEPTS A 0.50-0.90mm<sup>2</sup> [#20-#18] AWG SOLID OR FUSED STRANDED LEAD WIRE.
- 4 TIN PLATED
- 5 PAPER SPLICED - RESTRICTED TO BSH GERMANY
- 6 SPLICE FREE
- 7 PRODUCT REELED ON PLASTIC REEL

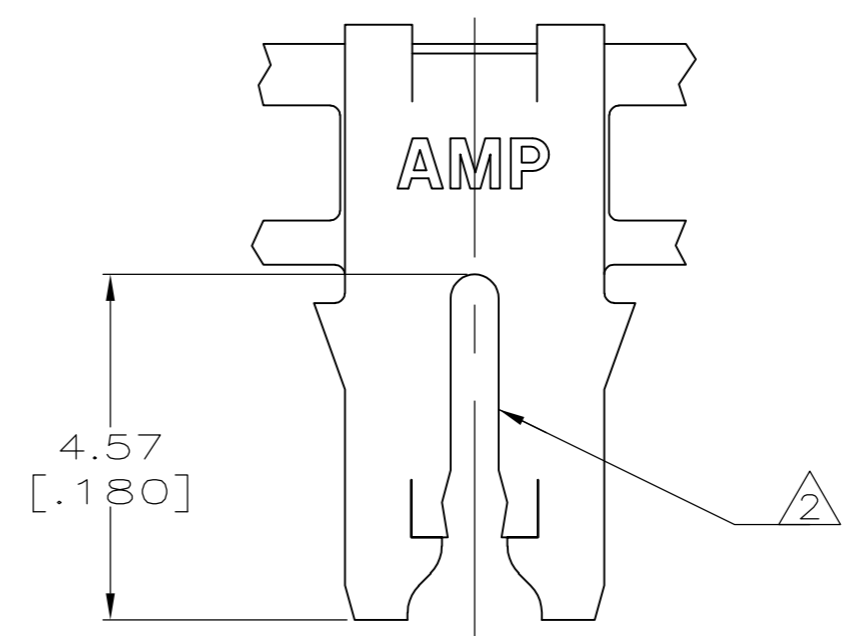
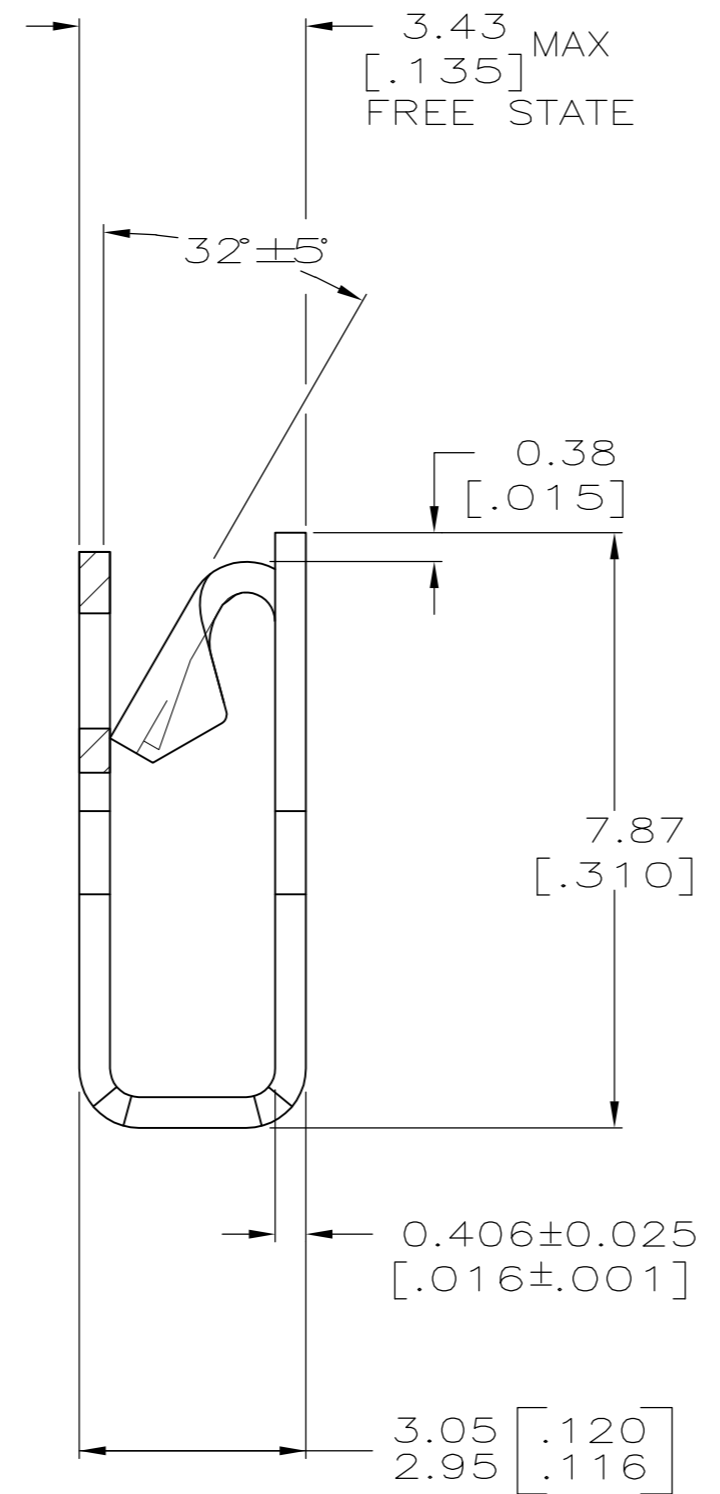
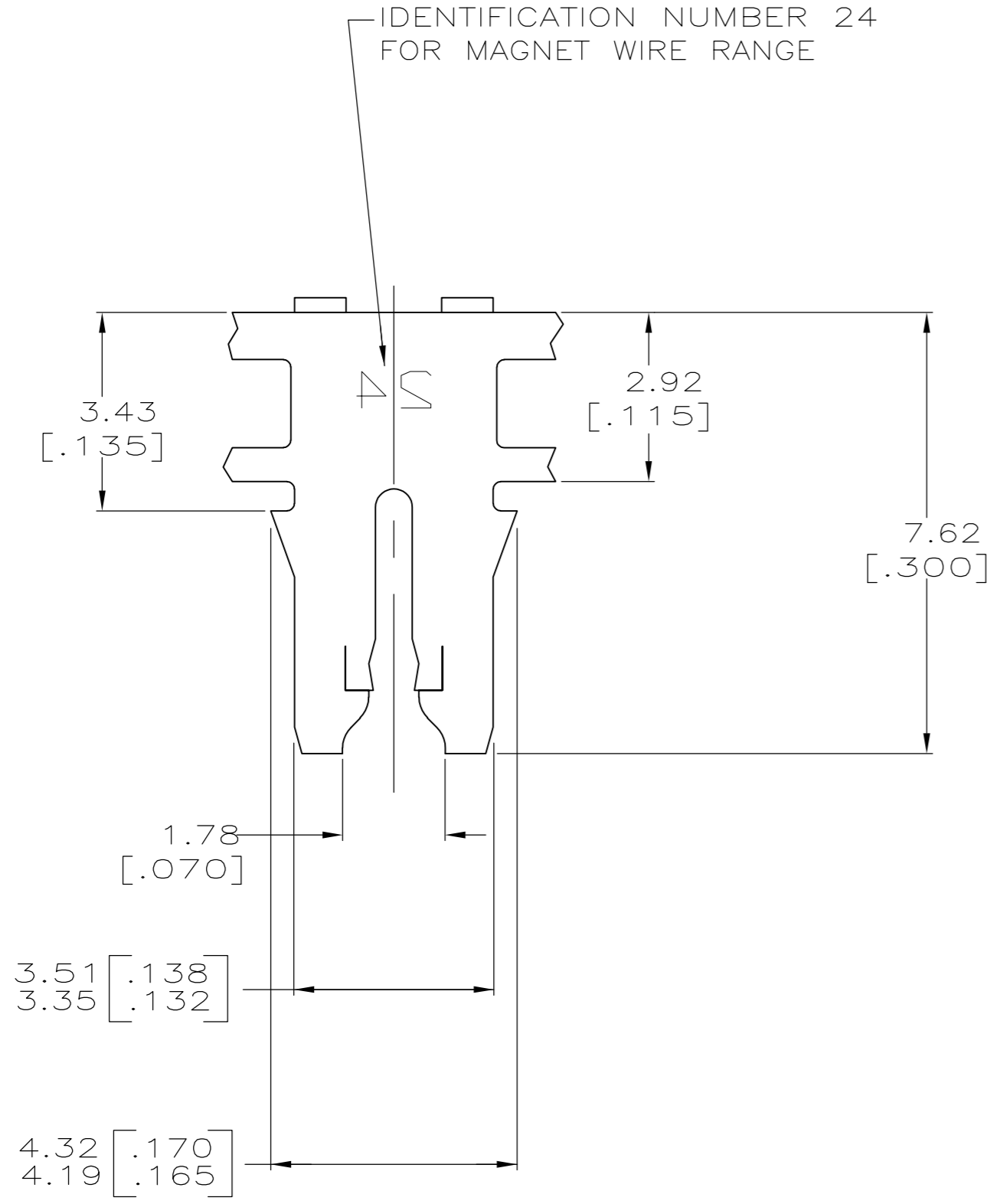

|                            |                     |                    |
|----------------------------|---------------------|--------------------|
| BRASS                      | STANDARD            | 1-62833-0          |
| CU-NI-SI                   | STANDARD            | 62833-9            |
| BRASS                      | STANDARD            | 62833-8            |
| BRASS                      | STANDARD            | 62833-6            |
| PHOSPHOR BRONZE            | STANDARD            | 62833-4            |
| <del>PHOSPHOR BRONZE</del> | <del>REVERSED</del> | <del>62833-3</del> |
| BRASS                      | REVERSED            | 62833-2            |
| BRASS                      | STANDARD            | 62833-1            |
| MATERIAL                   | REELING             | PART NO.           |

|  |  |   |   |            |
|--|--|---|---|------------|
| THIS DRAWING IS A CONTROLLED DOCUMENT. |  | DWN 1/SEP/94<br>R.R. BUCHHEISTER JR.<br>CHK 02SEP94 | <b>TE</b> TE Connectivity                 |            |
| DIMENSIONS: INCHES                     |  | MS FEHER<br>APVD 02SEP94                            |   |            |
| TOLERANCES UNLESS OTHERWISE SPECIFIED: |  | MS FEHER<br>PRODUCT SPEC                            | NAME                                      |            |
| 0 PLC ± -                              |  | 108-2012  | TERMINAL, POKE-IN,<br>300 SERIES MAG-MATE |            |
| 1 PLC ± -                              |  | APPLICATION SPEC                                    | -   |            |
| 2 PLC ± 0.25 [.010]                    |  | 114-2046  | SIZE                                      | CAGE CODE  |
| 3 PLC ± -                              |  | WEIGHT  | A2  | 00779      |
| 4 PLC ± -                              |  | FINISH  | SCALE                                     | DRAWING NO |
| ANGLES ± -                             |  | 4   | 10:1                                      | 62833      |
| MATERIAL SEE TABLE                     |  | CUSTOMER DRAWING                                    | SHEET                                     | REV        |
|  |  |   | 1 of 1                                    | S10        |