

Customer Information Sheet

DRAWING No.: M22-241XXXX

SHEET 3 OF 3

IF IN DOUBT - ASK

Ⓒ

NOT TO SCALE

THIRD ANGLE PROJECTION

ALL DIMENSIONS IN mm

SPECIFICATION:

MATERIAL:

MOULDING = NYLON 6T, UL94V-0, BLACK

CONTACT = BRASS

FINISH:

42 = GOLD ON CONTACT AREA, 100% TIN ON TAILS

46 = 100% TIN

ELECTRICAL:

CURRENT RATING = 2.0A

INSULATION RESISTANCE = 1,000M Ω MIN

CONTACT RESISTANCE = 20m Ω MAX

VOLTAGE PROOF = 500V AC

MECHANICAL:

DURABILITY = 500 OPERATIONS

ENVIRONMENTAL:

OPERATING TEMPERATURE = -40°C TO +105°C

PACKING:

TUBE OR TRAY

FOR COMPLETE SPECIFICATION, SEE COMPONENT SPECIFICATION C018XX (LATEST ISSUE)

ORDER CODE:

M22-241XXXX

No. OF CONTACTS PER ROW: 03 TO 25

FINISH:

42 = SELECTIVE GOLD + 100% TIN
46 = 100% TIN

2.00 x No. OF CONTACTS PER ROW ± 0.35

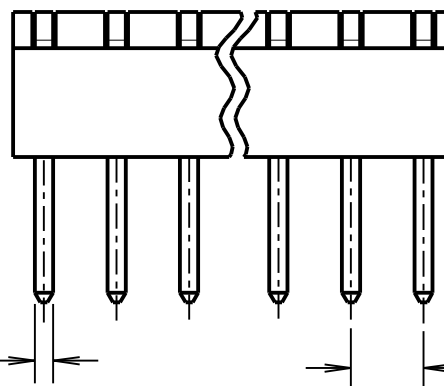

2.00 x (No. OF CONTACTS PER ROW - 1)

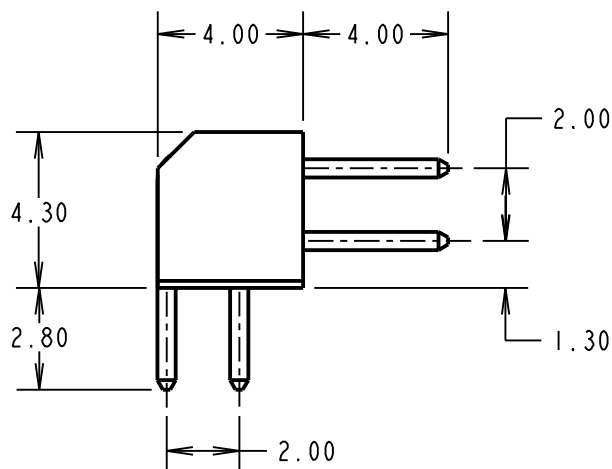
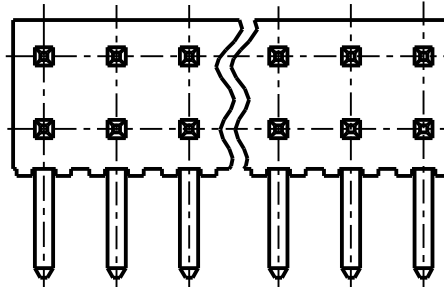

NOTES:

1. RECOMMENDED PCB MOUNTING HOLE SIZE = $\varnothing 0.90 \pm 0.05$ mm.
2. ALL TOLERANCES ARE ± 0.20 UNLESS OTHERWISE STATED.

MSP	12	17.06.15	12803
NAME	ISS.	DATE	C/NOTE
APPROVED:		M. PERREN	
CHECKED:		S. BENNETT	
DRAWN:		W. J. BOURNE	
CUSTOMER REF.:			
ASSEMBLY DRG:			

HARWIN

www.harwin.com
technical@harwin.com

THIS DRAWING AND ANY INFORMATION OR DESCRIPTIVE MATTER SET OUT HEREON ARE CONFIDENTIAL AND COPYRIGHT PROPERTY OF THE HARWIN GROUP AND MUST NOT BE DISCLOSED, LOANED, COPIED OR USED FOR MANUFACTURING, TENDERING OR FOR ANY OTHER PURPOSE WITHOUT THEIR WRITTEN PERMISSION.

TOLERANCES
~~X = ± 1 mm~~
~~X.X = ± 0.50 mm~~
~~X.XX = ± 0.10 mm~~
~~X.XXX = ± 0.01 mm~~
 ANGLES = $\pm 5^\circ$
 UNLESS STATED

MATERIAL:

SEE ABOVE

FINISH:

SEE ABOVE

S/AREA:

mm²

TITLE:

2mm PITCH 90° PIN HEADER

DRAWING NUMBER:

M22-241XXXX

SHT
3
OF
3

Mouser Electronics

Authorized Distributor

Click to View Pricing, Inventory, Delivery & Lifecycle Information:

Harwin:

[M22-2410342](#) [M22-2410346](#) [M22-2410442](#) [M22-2410446](#) [M22-2410542](#) [M22-2410546](#) [M22-2410642](#) [M22-2410646](#) [M22-2410742](#) [M22-2410746](#) [M22-2410842](#) [M22-2410846](#) [M22-2410942](#) [M22-2410946](#) [M22-2411042](#) [M22-2411046](#) [M22-2411142](#) [M22-2411146](#) [M22-2411242](#) [M22-2411246](#) [M22-2411342](#) [M22-2411346](#) [M22-2411442](#) [M22-2411446](#) [M22-2411542](#) [M22-2411546](#) [M22-2411642](#) [M22-2411646](#) [M22-2411742](#) [M22-2411746](#) [M22-2411842](#) [M22-2411846](#) [M22-2411942](#) [M22-2411946](#) [M22-2412042](#) [M22-2412046](#) [M22-2412142](#) [M22-2412146](#) [M22-2412242](#) [M22-2412342](#) [M22-2412346](#) [M22-2412442](#) [M22-2412446](#) [M22-2412542](#) [M22-2412546](#) [M22-2414246](#) [M22-2412246](#)