

REVISIONS				
P	LTR	DESCRIPTION	DATE	DWN APVD
B1		REVISED PER ECO-12-011352	20JUN2012	DLD SLM
B2		REVISED PER ECO-14-014610	26SEP2014	DLD SLM

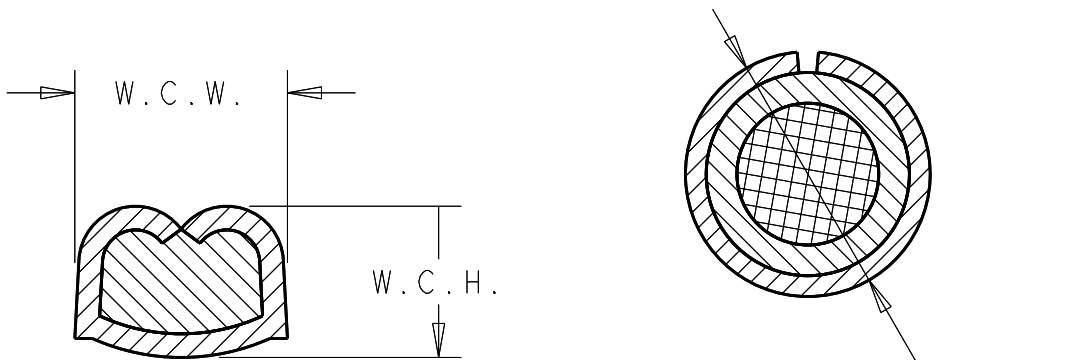

TE MCON 1.2-CB (CLEAN BODY)								
1670146-3	SILVER	3.6 ±0.3	20	1.4 TO 1.9	0.84 ±0.03	1.57 ±0.05	3.25±0.05	967067-1
1670146-2	GOLD							
1670146-1	TIN							
1418850-3	SILVER	3.6 ±0.3	18	1.9 TO 2.4	1.11 ±0.05	1.78 ±0.05	3.35±0.05	964972-1
			16		1.31 ±0.05			
1418850-2	GOLD		18		1.11 ±0.05			
			16		1.31 ±0.05			
1418850-1	TIN		18		1.11 ±0.05			
			16		1.31 ±0.05			
PART NUMBER	PLATING	WIRE STRIP LENGTH	AWG	INSL. RANGE	W.C.H.	W.C.W.	I.C.D.	WIRE SEAL PART NUMBER

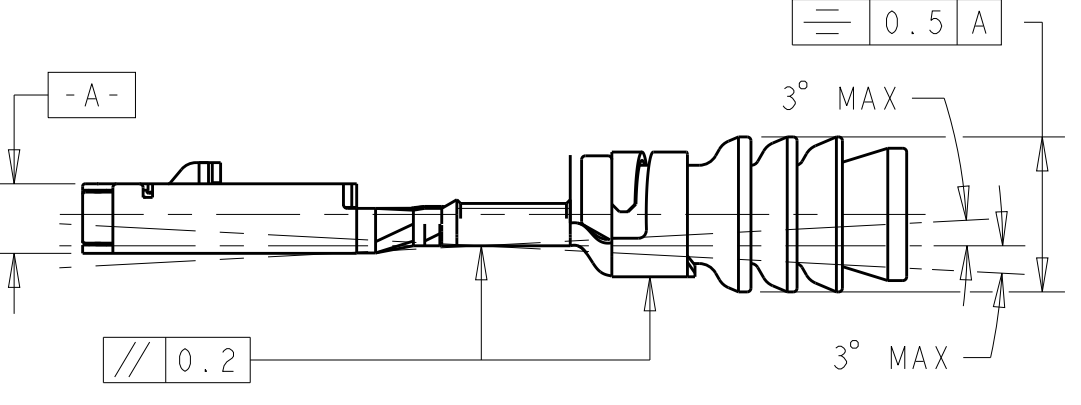
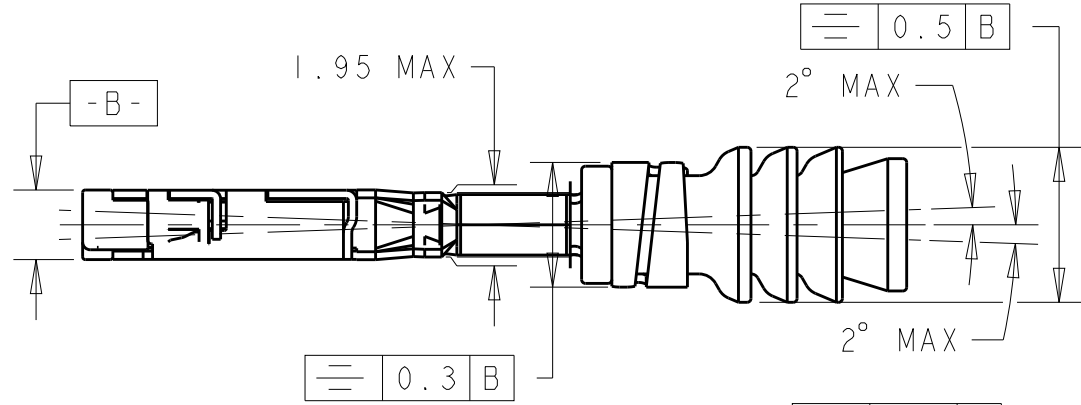
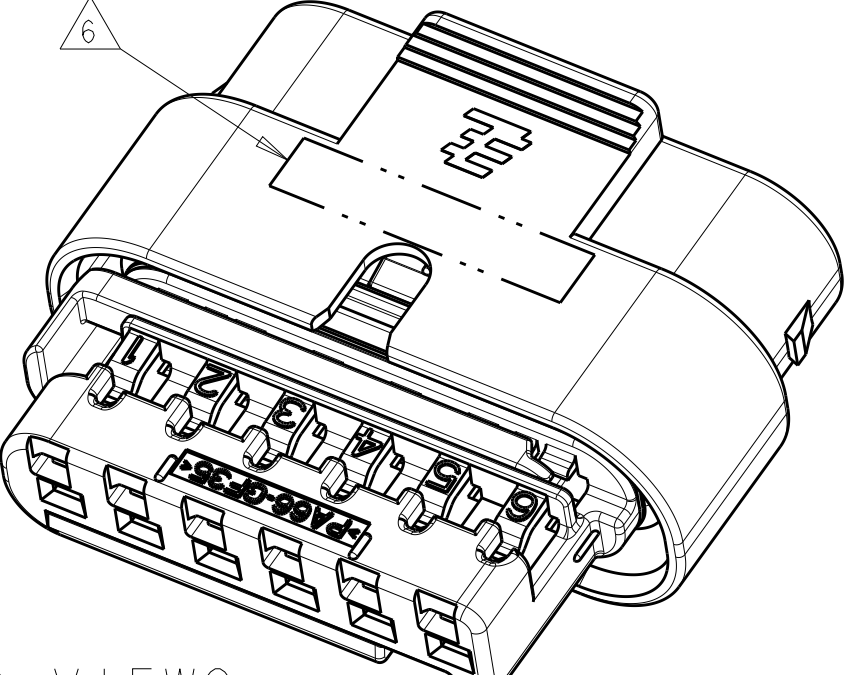
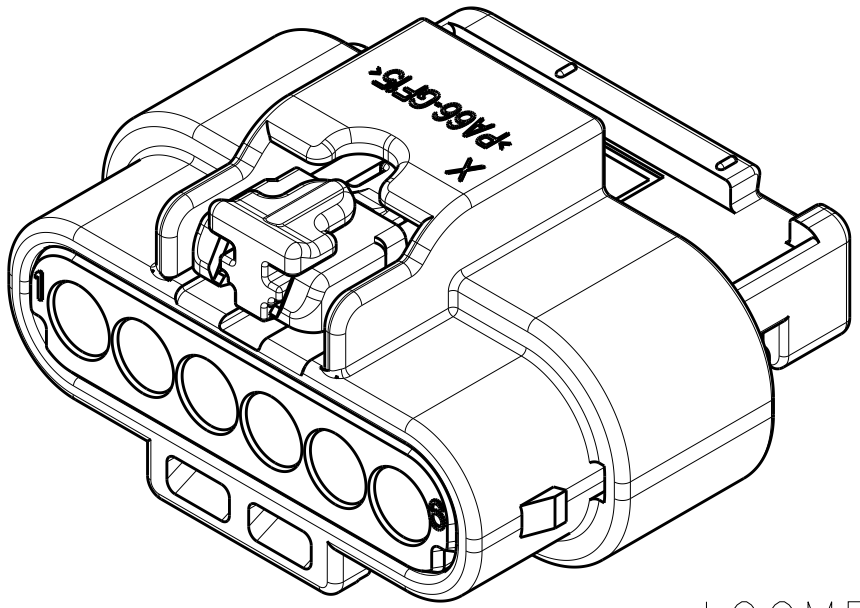

ISOMETRIC VIEWS
SCALE 3:1

RELEASED	2138907-1	GRAY	D	4-1924292-4
RELEASED	2138907-1	BLUE	C	4-1924292-3
RELEASED	2138907-1	NATURAL	B	4-1924292-2
RELEASED	2138907-1	BLACK	A	4-1924292-1
	1488787-1	GRAY	D	1924292-8
	1488787-1	BLUE	C	1924292-7
	1488787-1	NATURAL	B	1924292-6
RELEASED	1488787-1	BLACK	A	1924292-5
	N/A	GRAY	D	1924292-4
	N/A	BLUE	C	1924292-3
	N/A	NATURAL	B	1924292-2
STATUS	CPA	16	COLOR	KEY
		16	INNER HOUSING	PART NUMBER

THIS DRAWING IS A CONTROLLED DOCUMENT.		DWN	6 JAN 2007	TE Connectivity	
DIMENSIONS:		CHK	16 JAN 2007	CONNECTOR ASSEMBLY, FEMALE, 6 POSITION SEALED, 1.2mm MCON	
mm		APVD	16 JAN 2007	SIZE	
TOLERANCES UNLESS OTHERWISE SPECIFIED:		PRODUCT SPEC		CAGE CODE	
0 PLC ±0.3		APPLICATION SPEC		DRAWING NO	
1 PLC ±0.10		SEE NOTES		RESTRICTED TO	
2 PLC ±0.10		WEIGHT		A100779	
3 PLC ±0.10		CUSTOMER DRAWING		SCALE	
4 PLC ±0.10		SCALE		4:1	
ANGLES ±1		SHEET		1 OF 2	
FINISH		REV		B2	

REVISIONS					
P	LTR	DESCRIPTION	DATE	DWN	APVD
-	-	SEE SHEET 1	-	-	-

ISOMETRIC VIEWS

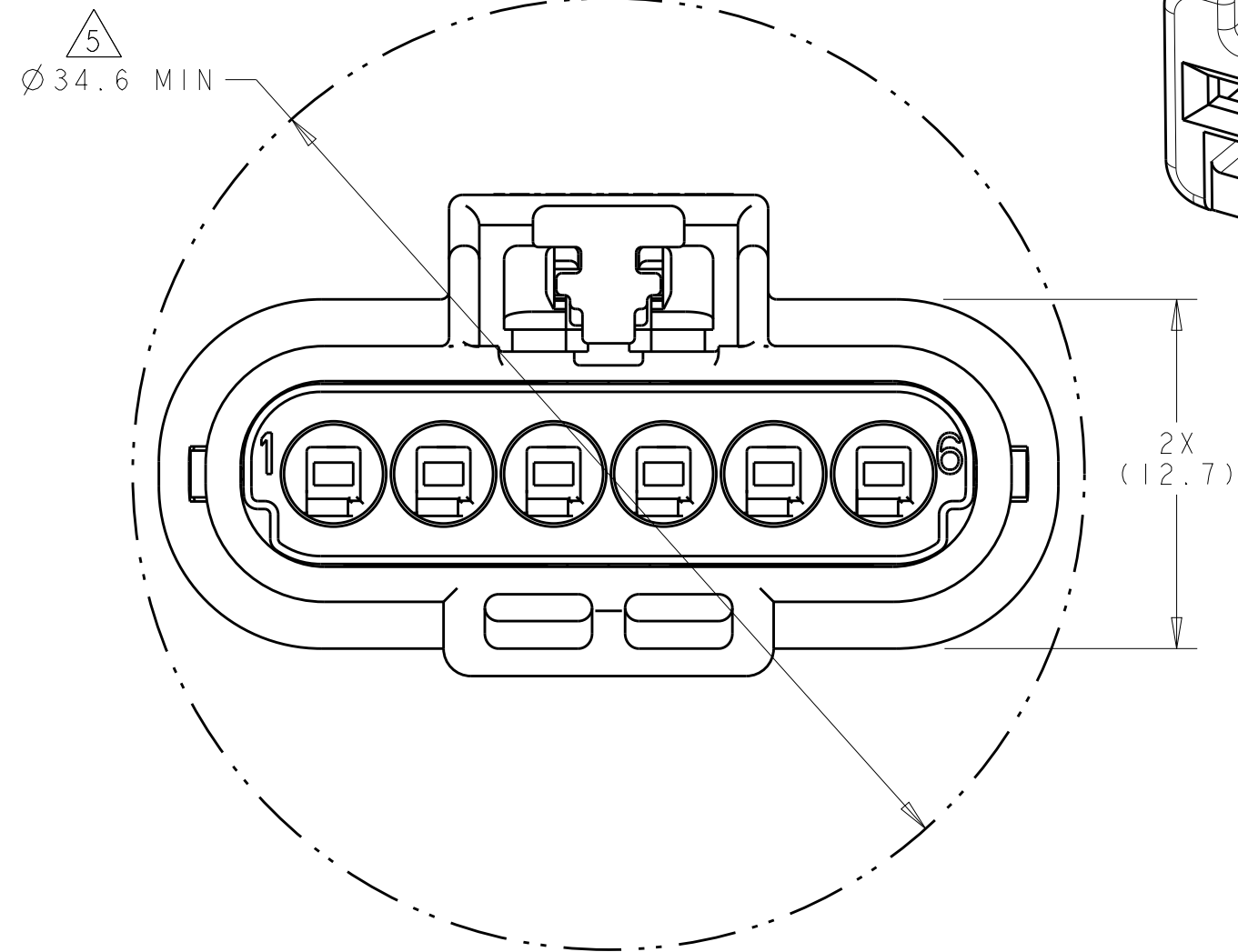
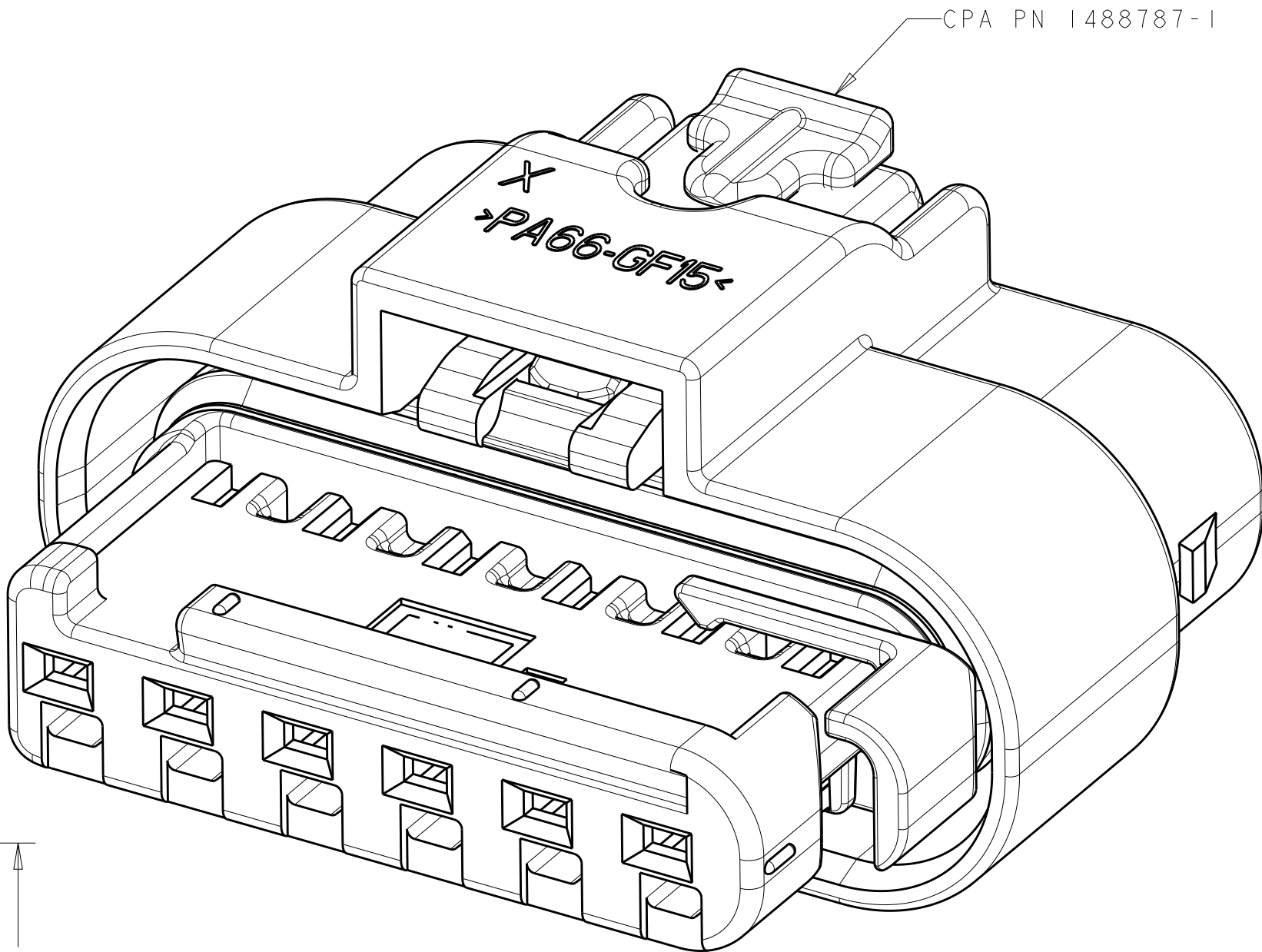

P/N 1924292-5 SHOWN
SCALE 6:1

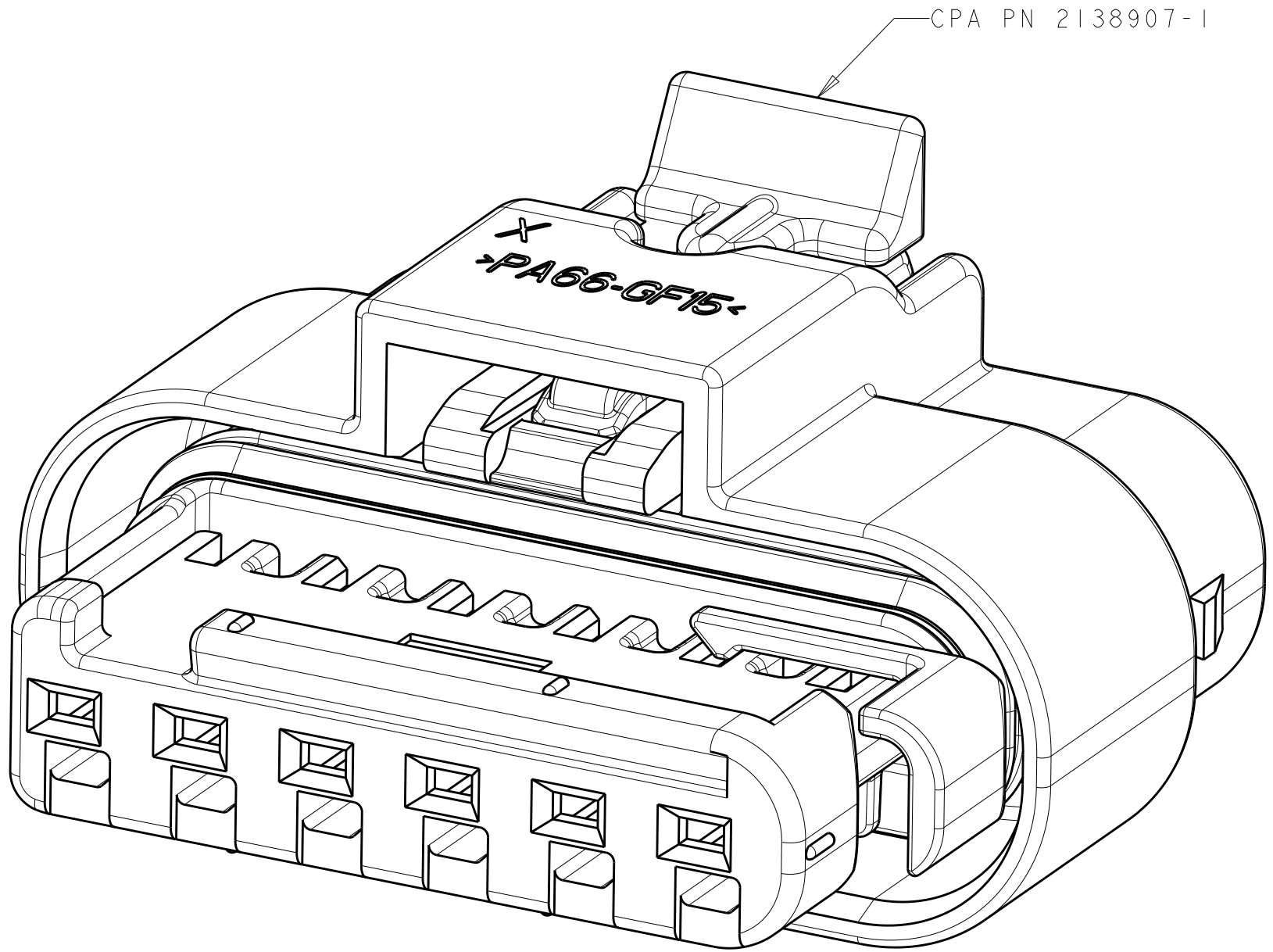

P/N 4-1924292-1 SHOWN
SCALE 6:1

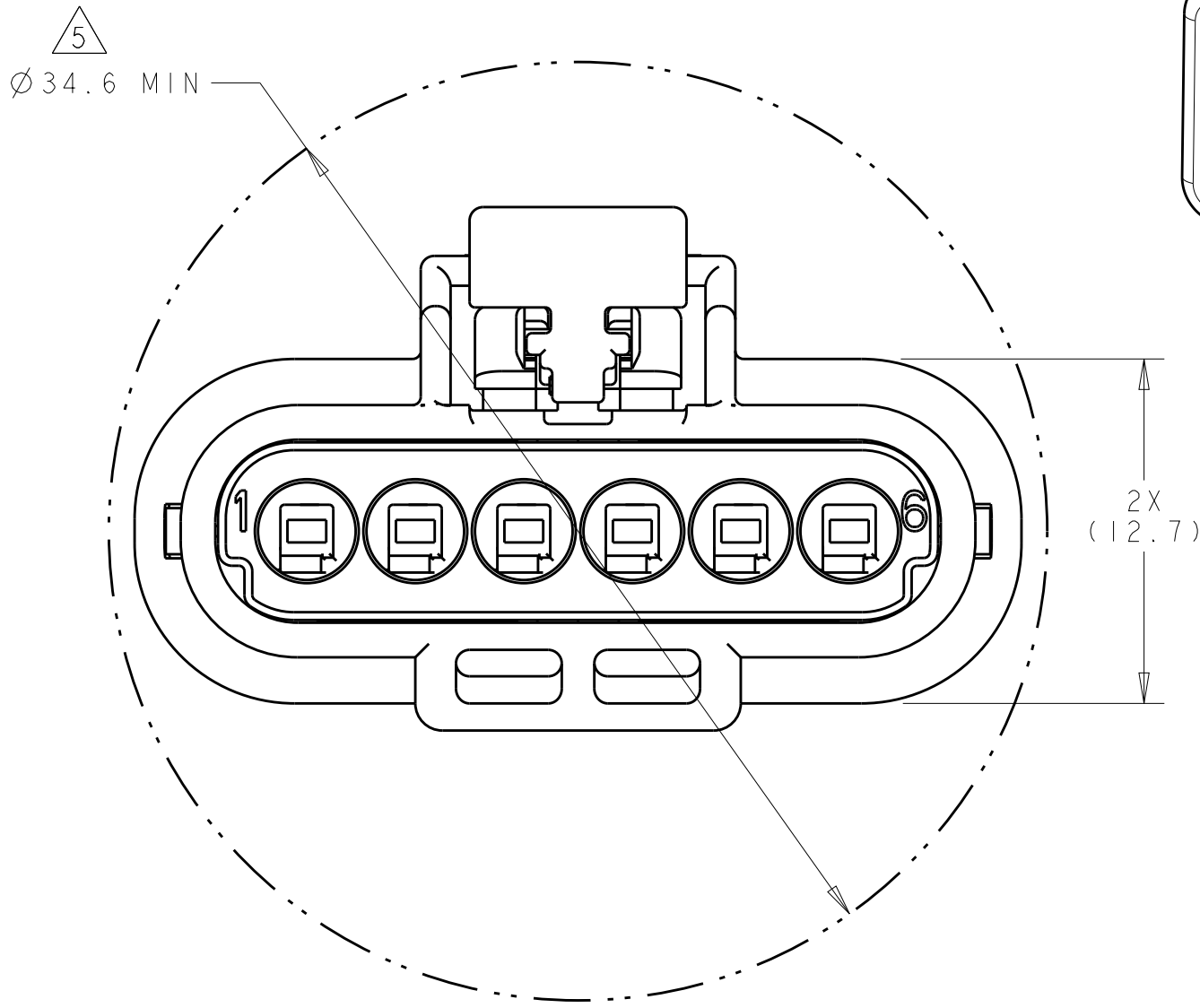

FEED THROUGH CONDITION

THIS DRAWING IS A CONTROLLED DOCUMENT.		DWN M. HITCHCOCK 16JAN2007	<div><div>TE</div>TE Connectivity</div>	
		CHK G. MARTIN 16JAN2007		
		APVD G. MARTIN 16JAN2007		
		PRODUCT SPEC		
DIMENSIONS:		TOLERANCES UNLESS OTHERWISE SPECIFIED:	NAME	
mm	0 PLC ±.3	1 PLC ±0.3	CONNECTOR ASSEMBLY, FEMALE, 6 POSITION SEALED, 1.2mm MCON	
	2 PLC ±0.10	3 PLC ±.		
	4 PLC ±.	ANGLES ±.1		
	FINISH			
MATERIAL	-	-	SIZE	RESTRICTED TO
SEE TABLE	-	-	CAGE CODE	
		WEIGHT	DRAWING NO	
		5.53 grams	A100779	
		CUSTOMER DRAWING	C=1924292	
		SCALE	SHEET	REV
		4:1	2 OF 2	B2

Mouser Electronics

Authorized Distributor

Click to View Pricing, Inventory, Delivery & Lifecycle Information:

[TE Connectivity:](#)

[1924292-3](#)