

This drawing involves proprietary design rights of Tyco Electronics Corporation, and all design, manufacture, reproduction, use and sale rights regarding the same are expressly reserved. It is submitted for a specific purpose and the recipient by accepting this drawing, assumes custody and control and agrees to take reasonable precautions; (a) that this drawing will not be copied and reproduced, in whole or in part, or its contents revealed in any manner, or to any person except to meet the purpose for which it was delivered and (b) that any special features peculiar to this design will not be incorporated in other projects without the expressed written permission of Tyco Electronics Corporation.

| REVISIONS |     |             |          |
|-----------|-----|-------------|----------|
| EC        | REV | DESCRIPTION | DATE     |
| CPR       | A   | NEW RELEASE | 11/08/05 |

6. THIS CONNECTOR MATE WITH PIN CONNECTOR 6643106-1.
5. ITEMS PROVIDED TO THIS SPECIFICATION TO BE PERMANENTLY IDENTIFIED PER THE FOLLOWING IDENTIFIER:

YEAR 11 WEEK 5

TYCO PART NUMBER      DATE CODE (e.g. 0525)

XXXXXXXX-X      XXXX

4. SOCKET CRIMP CONTACTS AND SHOULDER SCREWS SHALL BE PACKAGED AND PLACED IN THE BOX WITH THE CONNECTOR ASSEMBLY. THIS CONNECTOR ASSEMBLY SHALL BE PACKAGED AS A KIT.

3. FINISHES:

CONTACTS: SILVER PLATED PER ASTM B 700  
OVER NICKEL PER QQ-N-290.

2. MATERIALS:

HOUSINGS: THERMOPLASTIC, GLASS REINFORCED, COLOR-BLACK  
UL94V-0 FLAMMABILITY RATED.

SOCKET CONTACTS: LEAD COPPER.

CROWN BANDS: BERYLLIUM COPPER.

RETENTION CLIPS: BERYLLIUM COPPER OR STAINLESS STEEL.

1. PART NUMBER CHANGES AND OR DESIGN CHANGES AFFECTING ITEM INTERCHANGEABILITY REQUIRE PRIOR ELCON APPROVAL AND AUTHORIZATION BY REVISION TO THIS DRAWING.

NOTES: UNLESS OTHERWISE SPECIFIED

| TABLE FOR SOCKET CONNECTOR PN 6643107-1 |                                  |          |     |
|---|----------------------------------|----------|-----|
| PART NUMBER                             | DESCRIPTION                      | POSITION | QTY |
| 1648128-2                               | CONNECTOR, SOCKET                | N/A      | 1   |
| 6648318-1                               | CONTACT, SOCKET, SIZE #12, CRIMP | 1 - 8    | 8   |
| 1650575-1                               | SHOULDER SCREW, #8-32            | N/A      | 2   |

|   |                         |                  |  |                          |
|---|-------------------------|------------------|--|--------------------------|
| <div>INCH OR INCH (MM)</div> <div></div> <div>THIRD ANGLE PROJECTION</div> <div>UNLESS OTHERWISE SPECIFIED DIMENSIONS ARE IN INCHES (METRIC)</div> <div>TOLERANCES</div> <div>ANGLES ± .5°</div> <div>DECIMALS</div> <div>.XXX ± .010 (.25)</div> <div>.XX ± .02 (.3)</div> | DRAWN<br>HA NGUYEN      | DATE<br>11/08/05 | <div> Tyco Electronics Corporation<br/>Menlo Park, Ca 94025</div> <div></div> <div>TITLE</div> <div>CONNECTOR, SOCKET<br/>HV8P DRAWER<br/>PN 6643107-1</div> |                          |
|   | CHECKED                 |                  |  |                          |
|   | APPROVED                |                  |  |                          |
|   | APPROVED<br>D. CHAU     | 11/08/05         | SIZE<br>B  | DWG NUMBER<br>C= 6643107 |
|   | DCA APPROVED<br>M. ALIM | 11/08/05         | REV.<br>A  |                          |
| ACAD FILE NUMBER C6643107A.DWG  |                         |                  | DWG SCALE 1=1  | SH 1 OF 3                |

This drawing involves proprietary design rights of Tyco Electronics Corporation, and all design, manufacture, reproduction, use and sale rights regarding the same are expressly reserved. It is submitted for a specific purpose and the recipient by accepting this drawing, assumes custody and control and agrees to take reasonable precautions; (a) that this drawing will not be copied and reproduced, in whole or in part, or its contents revealed in any manner, or to any person except to meet the purpose for which it was delivered and (b) that any special features peculiar to this design will not be incorporated in other projects without the expressed written permission of Tyco Electronics Corporation.

| REVISIONS |     |             |      |
|-----------|-----|-------------|------|
| EC        | REV | DESCRIPTION | DATE |
|           |     | SEE SHEET 1 |      |

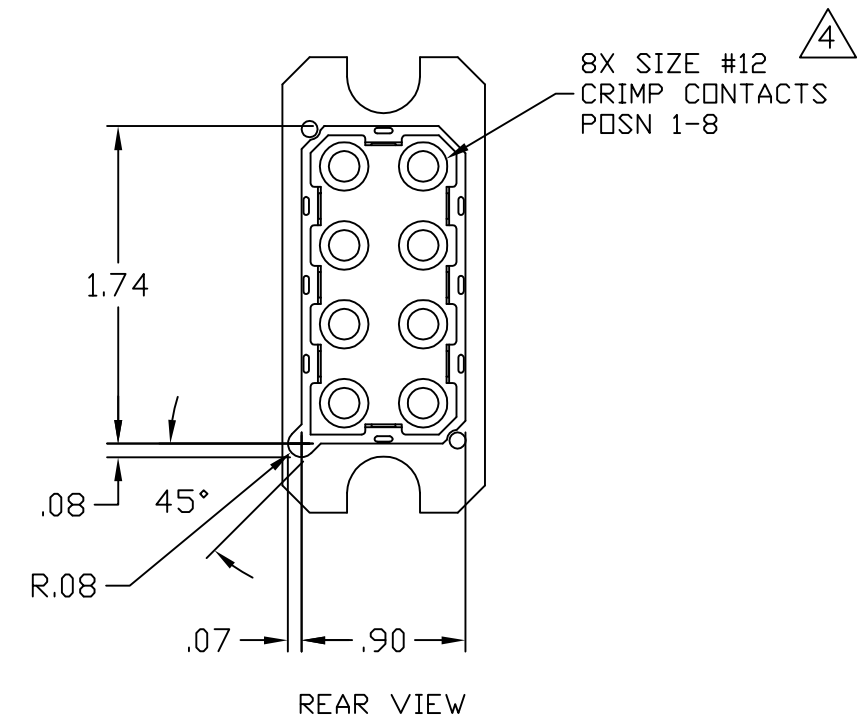
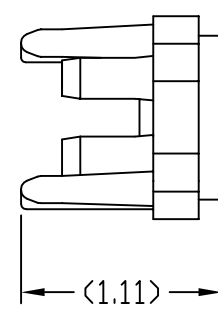
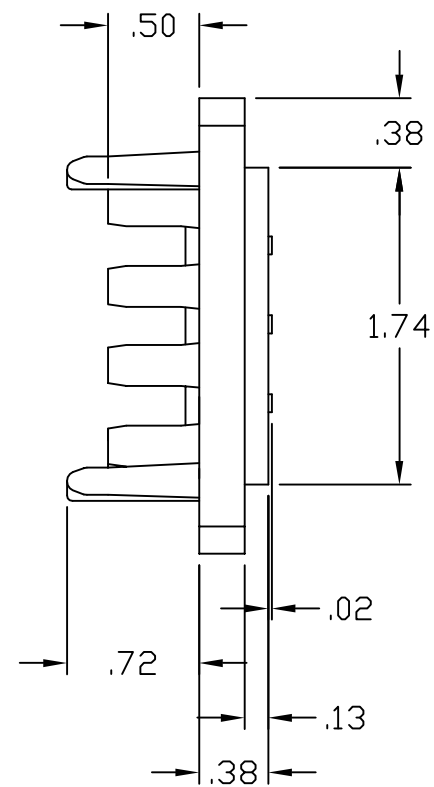
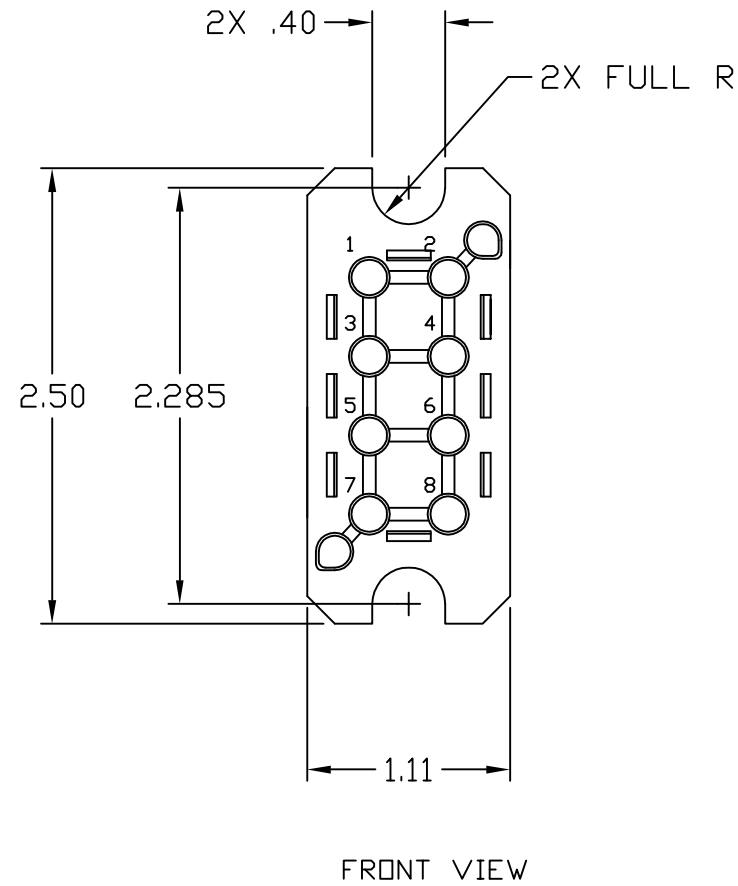

|   |                  |               |   |            |
|---|------------------|---------------|---|------------|
| <div><div>INCH OR INCH (MM)</div><div>MM</div><div></div><div>THIRD ANGLE PROJECTION</div><div>UNLESS OTHERWISE SPECIFIED DIMENSIONS ARE IN INCHES (METRIC)</div><div>TOLERANCES</div><div>ANGLES ± .5°</div><div>DECIMALS</div><div>.XXX ± .010 (.25)</div><div>.XX ± .02 (.3)</div></div> | DRAWN            | DATE          | <div><div><div>tyco</div><div>Electronics</div></div><div>Tyco Electronics Corporation<br/>Menlo Park, Ca 94025</div><div>ELCON</div></div> |            |
|   | HA NGUYEN        | 11/08/05      |   |            |
|   | CHECKED          |               | TITLE   |            |
|   | APPROVED         |               |   |            |
|   | APPROVED         |               | CONNECTOR, SOCKET<br>HV8P DRAWER<br>PN 6643107-1  |            |
|   | D. CHAU          | 11/08/05      |   |            |
|   | DCA APPROVED     | 11/08/05      |   |            |
|   | M. ALIM          | 11/08/05      | SIZE  | DWG NUMBER |
|   | ACAD FILE NUMBER | C6643107A.DWG | B   | C= 6643107 |
|   |                  |               | DWG SCALE   | 1=1        |
|   |                  |               | SH  | 2 OF 3     |
|   |                  |               | REV.  | A          |

This drawing involves proprietary design rights of Tyco Electronics Corporation, and all design, manufacture, reproduction, use and sale rights regarding the same are expressly reserved. It is submitted for a specific purpose and the recipient by accepting this drawing, assumes custody and control and agrees to take reasonable precautions; (a) that this drawing will not be copied and reproduced, in whole or in part, or its contents revealed in any manner, or to any person except to meet the purpose for which it was delivered and (b) that any special features peculiar to this design will not be incorporated in other projects without the expressed written permission of Tyco Electronics Corporation.

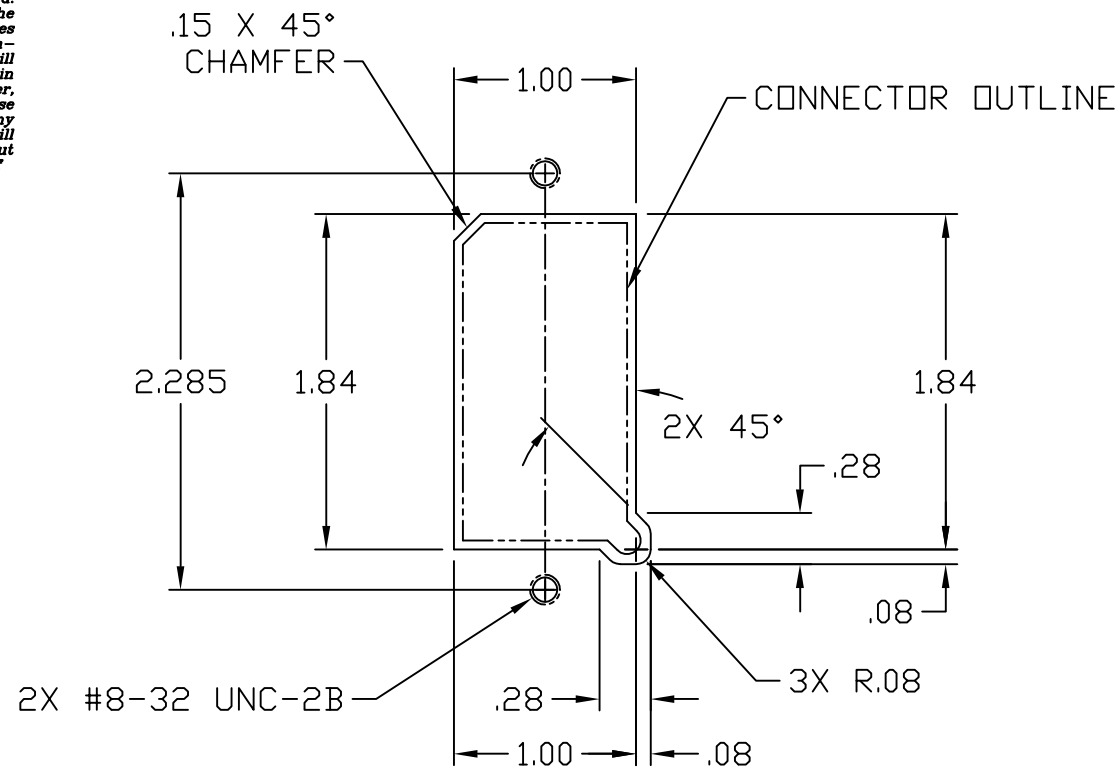

SUGGESTED PANEL CUTOUT  
VIEWED FROM CONNECTOR MOUNTING SIDE

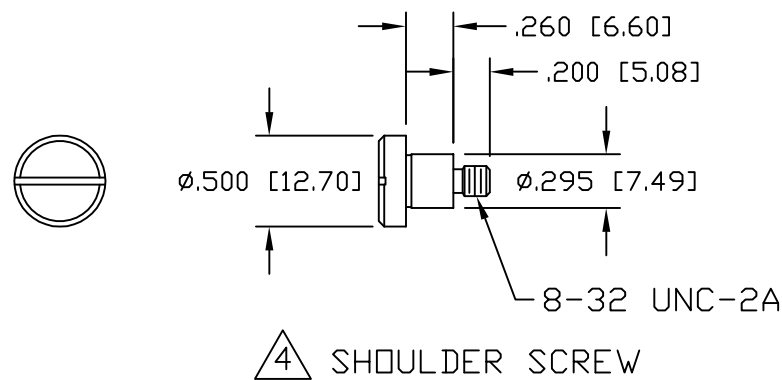

| REVISIONS |     |             |      |
|-----------|-----|-------------|------|
| EC        | REV | DESCRIPTION | DATE |
|           |     | SEE SHEET 1 |      |

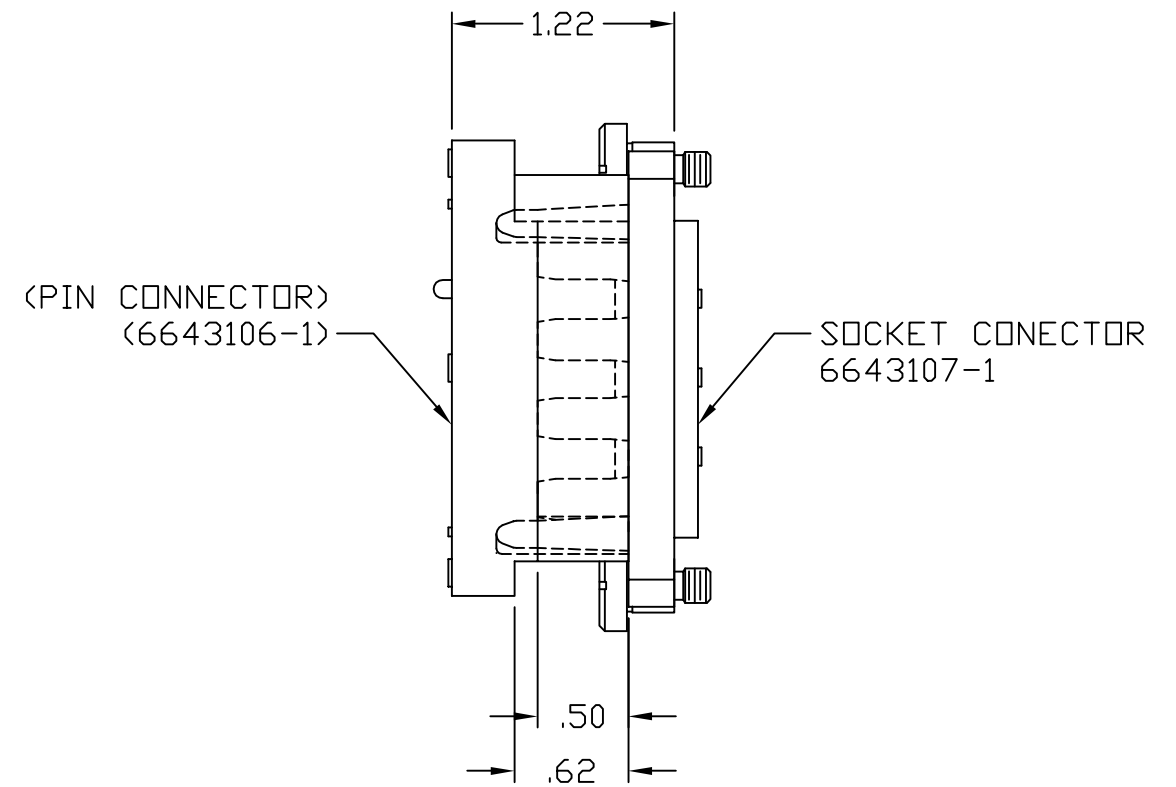

MATED CONDITION

|   |                     |                  |   |                          |
|---|---------------------|------------------|---|--------------------------|
| <div><div>INCH<br/>MM</div><div>OR INCH (MM)</div><div></div><div>THIRD ANGLE PROJECTION</div></div> <div>UNLESS OTHERWISE SPECIFIED DIMENSIONS ARE IN INCHES (METRIC)</div> <div>TOLERANCES</div> <div>ANGLES ± .5°</div> <div>DECIMALS</div> <div>.XXX ± .010 (.25)</div> <div>.XX ± .02 (.3)</div> | DRAWN<br>HA NGUYEN  | DATE<br>11/08/05 | <div><div><b>tyco</b></div><div>Tyco Electronics Corporation</div><div>Menlo Park, Ca 94025</div></div> <div><b>ELCON</b></div> |                          |
|   | CHECKED             |                  | TITLE   |                          |
|   | APPROVED            |                  | USER INFORMATION<br>RECOMMENDED PANEL CUTOUT<br>AND MATED CONDITION   |                          |
|   | APPROVED<br>D. CHAU | 11/08/05         | SIZE<br>B   | DWG NUMBER<br>C= 6643107 |
| ACAD FILE NUMBER<br>C6643107A.DWG   |                     | DWG SCALE<br>1=1 |   | REV.<br>A                |

# Mouser Electronics

Authorized Distributor

Click to View Pricing, Inventory, Delivery & Lifecycle Information:

[TE Connectivity:](#)

[6643107-1](#)