

STRAIGHT PLUG RECEPTACLE FOR PCB

SOLDER LEGS

R115.427.000

Series : SMB-A

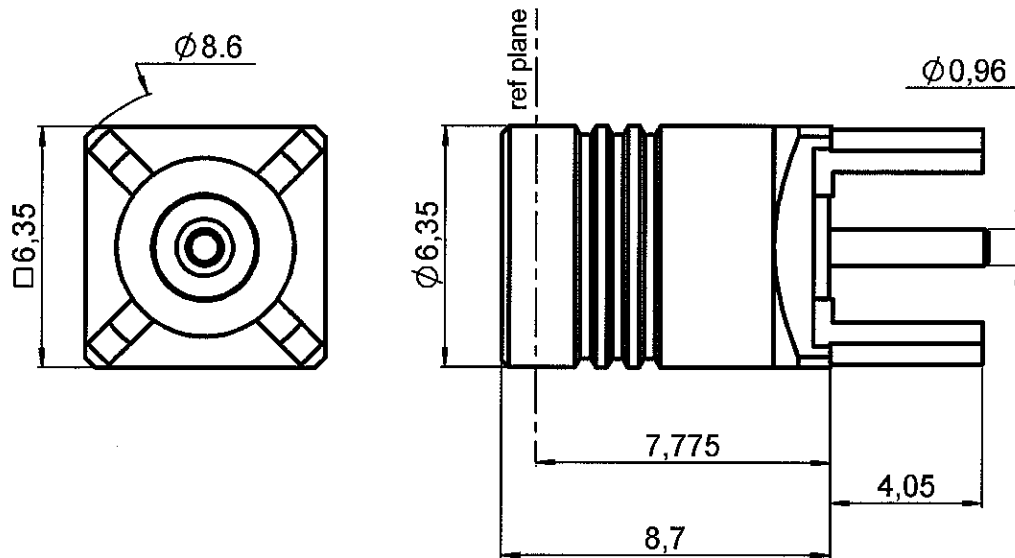

scale:1/1

All dimensions are in mm.

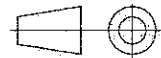

COMPONENTS	MATERIALS	PLATINGS (μm)
BODY	BRASS	GOLD 0.2 OVER NICKEL 2
CENTER CONTACT	BERYLLIUM COPPER	GOLD 1.3 OVER NICKEL 2
OUTER CONTACT	BRASS	GOLD 0.5 OVER NICKEL 2
INSULATOR	PTFE	
GASKET	-	-
OTHERS PARTS	-	-
-	-	-
-	-	-

Issue : 0523 Y

In the effort to improve our products, we reserve the right to make changes judged to be necessary.



STRAIGHT PLUG RECEPTACLE FOR PCB**SOLDER LEGS****R115.427.000**

Series : SMB-A

PACKAGING

Standard	Unit	Other
1	-	Contact us

SPECIFICATION**ELECTRICAL CHARACTERISTICS**

Impedance	50 Ω
Frequency	0-4 GHz
VSWR	NA + 0.000 x F(GHz) Maxi
Insertion loss	NA $\sqrt{F}(\text{GHz})$ dB Maxi
RF leakage	NA - F(GHz) dB Maxi
Voltage rating	335 Veff Maxi
Dielectric withstanding voltage	1000 Veff mini
Insulation resistance	1000 M Ω mini

ENVIRONMENTAL

Operating temperature	-65/+165 °C
Hermetic seal	NA Atm.cm ³ /s
Panel leakage	NA

OTHERS CHARACTERISTICS

Assembly instruction

Others :

-

MECHANICAL CHARACTERISTICS

Center contact retention	
Axial force – Mating end	10 N mini
Axial force – Opposite end	10 N mini
Torque	NA N.cm mini
Recommended torque	
Mating	NA N.cm
Panel nut	NA N.cm
Mating life	500 Cycles mini
Weight	1.593 g

Issue : 0523 Y

In the effort to improve our products, we reserve the right to make changes judged to be necessary.

**RADIALL®**

Mouser Electronics

Authorized Distributor

Click to View Pricing, Inventory, Delivery & Lifecycle Information:

Radial:

[R115427000](#)