

LOC	DIST	REVISIONS					
—	—	P	LTR	DESCRIPTION	DATE	DWN	APVD
NUMMER 825435		F		Contact pin base material change from CuSn (Phosphor bronze) to CuZn (Brass). Plating changed to min. 0.7 microns Pd Ni + 0.1 microns gold flash at contact area (Area F).	24JUN2014	TJ	JK
VERWENDET FÜR E 75-9233							
WAR —							

POLZ.	L±0.5	BESTELL-NR.
—	—	—
2	5.08	825 435 -2
3	7.62	— -3 ³ / ₃
4	10.16	— -4
5	12.70	— -5 ³ / ₃
6	15.24	— -6 ³ / ₃
7	17.78	— -7
8	20.32	— -8 ³ / ₃
9	22.86	— -9 ³ / ₃
10	25.40	1- -0 ³ / ₃
11	27.94	1- -1
12	30.48	1- -2
13	33.02	1- -3
14	35.56	1- -4 ³ / ₃
15	38.10	1- -5
16	40.64	1- -6
17	43.18	1- -7
18	45.72	1- -8
19	48.26	1- -9
20	50.80	2- -0 ³ / ₃
21	53.34	2- -1 ² / ₂
22	55.88	2- -2 ³ / ₃
23	58.42	2- -3
24	60.96	2- -4
25	63.50	2- -5
26	66.04	2- -6
27	68.58	2- -7 ³ / ₃
28	71.12	2- -8
29	73.66	2- -9 ³ / ₃
30	76.20	3- -0 ³ / ₃
31	78.74	3- -1
32	81.28	3- -2
33	83.82	3- -3
34	86.36	3- -4
35	88.90	3- -5
36	91.44	3- -6
37	93.98	3- -7 ³ / ₃
38	96.52	3- -8
39	99.06	3- -9
40	101.60	4- -0
41	104.14	4- -1
42	106.68	4- -2
43	109.22	4- -3
44	111.76	4- -4
45	114.30	4- -5
46	116.84	4- -6
47	119.38	4- -7
48	121.92	4- -8
49	124.46	4- -9
50	127.00	5- 825 435 -0

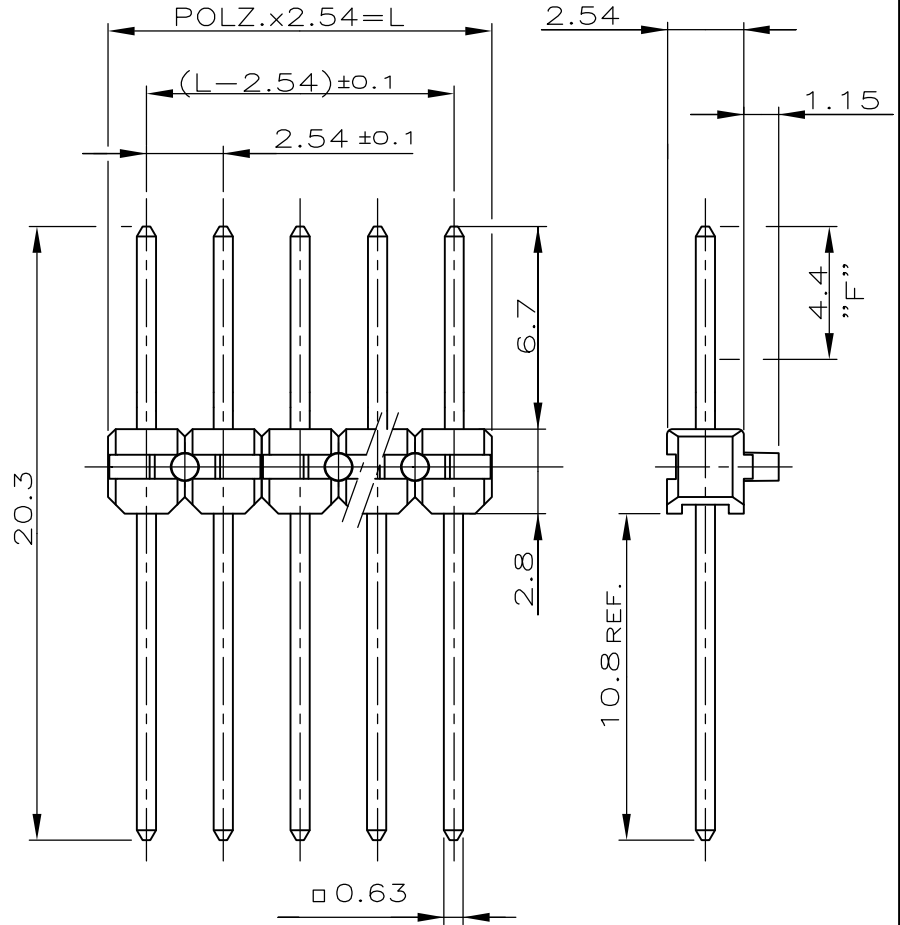

- ¹ STECKSEITE: IM BEREICH "F" MIN. 0.7µm PdNi+0.1µm GOLD FLASH ÜBER 1.27µm NICKEL.
- ² OBSOLETE PARTS: OBSOLETE CIS STREAMLINING PER D.RENAUD/D.SINISI
- ³ OBSOLETE

CAD-ORIGINAL
ZEICHNUNG NICHT ÄNDERN

KONTAKTSTIFT	Cu Zn	¹
STIFTGEHÄUSE	PBT GV	GRÜN
BENENNUNG	WERKSTOFF	OBERFLÄCHE FARBE

ZEICHNUNG GÜLTIG AB KW 39/96

THIS DRAWING IS UNPUBLISHED.

COPYRIGHT - By - ALL RIGHTS RESERVED.

DIMENSIONS: mm	DWN	11.04.84	MATERIAL	FINISH			
	CHK	11.04.84	-				
TOLERANCES UNLESS OTHERWISE SPECIFIED: ±0.2mm	APVD	-	TE Connectivity				
	PRODUCT SPEC	108-18012					
0 PLC ± - 1 PLC ± - 2 PLC ± - 3 PLC ± - 4 PLC ± - ANGLES ± -	APPLICATION SPEC	-	NAME AMPMODU II PIN HEADER, SINGLE ROW				
	WEIGHT	-	SIZE	CAGE CODE	DRAWING NO	RESTRICTED TO	
CUSTOMER DRAWING		A4	00779	C-825435	-		
		SCALE	4:1	SHEET	1 OF 1	REV	F

Mouser Electronics

Authorized Distributor

Click to View Pricing, Inventory, Delivery & Lifecycle Information:

[TE Connectivity:](#)

[825435-2](#)