

CODINGS

P/N°: 0987861011	P/N°: 0987861019	P/N°: 0987861018	P/N°: 0987861016
COLOR BLACK	COLOR BROWN	COLOR GREY	COLOR BLUE

MINIMUM FREE SPACE FOR ASSEMBLY

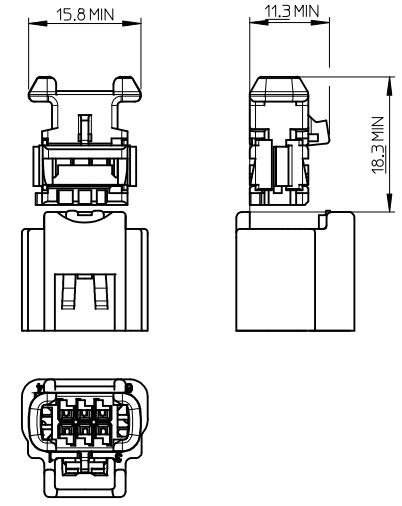

NECESSARY VOLUME FOR THE HOUSING ASSEMBLY.
ALLOW AN ADDITIONAL VOLUME FOR THE UNMATING

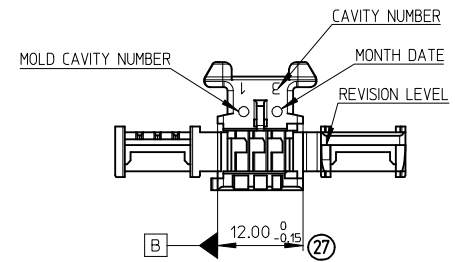
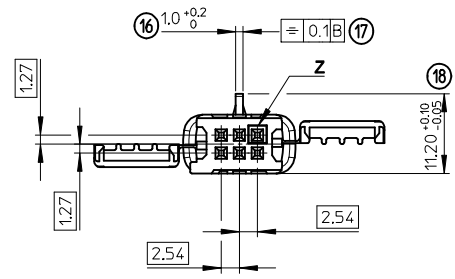
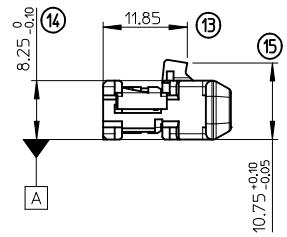
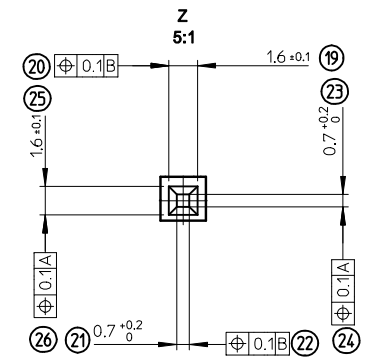
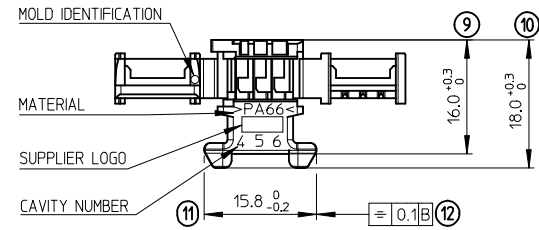

NOTES:

- 1- MATERIAL : POLYAMIDE (PA66) UNFILLED UL94V-2
- 2- USE WITH : 98658 (MOX 0.63 TERMINAL)
- 3- APPLICATION SPECIFICATION : AS-98787-001
- 4- MATE WITH : SERIES 98780 (HEADER)
- 5- WEIGHT : 1,060 g

ISO VIEW

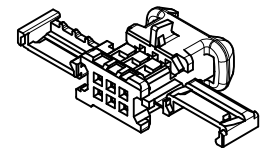

REVISÉ EC NO: G2013-0071 DRWN:DDSSANTOS 2011/02/22 CHKD:HERBELIN 2012/09/17 APPR:PLESSIS 2012/11/23	DESCRIPTION [REDACTED]	GENERAL TOLERANCES (UNLESS SPECIFIED)		DIMENSION STYLE MM ONLY		SCALE 2:1	DESIGN UNITS METRIC	FIRST ANGLE PROJECTION	
		4 PLACES ± --- ± ---	mm INCH	DRAWN BY VGUERIN	DATE 2008/03/07	TITLE MOX RCPT HSG 0.635 CEM 6CKT			
		3 PLACES ± --- ± ---		CHECKED BY JLDUCLOS	DATE 2008/03/07	MATERIAL NO.			
		2 PLACES ± 0.05 ± ---		APPROVED BY LSTICKEIR	DATE 2008/03/07	DOCUMENT NO. SD-98786-001			
1 PLACE ± 0.1 ± ---		ANGULAR ± 2 °		SEE CHART		SHEET NO. 1 OF 1			
0 PLACE ± --- ± ---		DRAFT WHERE APPLICABLE MUST REMAIN WITHIN DIMENSIONS		SIZE A2		THIS DRAWING CONTAINS INFORMATION THAT IS PROPRIETARY TO MOLEX INCORPORATED AND SHOULD NOT BE USED WITHOUT WRITTEN PERMISSION			

CODINGS

P/N°: 0987861011	P/N°: 0987861019	P/N°: 0987861018	P/N°: 0987861016
COLOR: BLACK	COLOR: BROWN	COLOR: GREY	COLOR: BLUE

MINIMUM FREE SPACE FOR ASSEMBLY

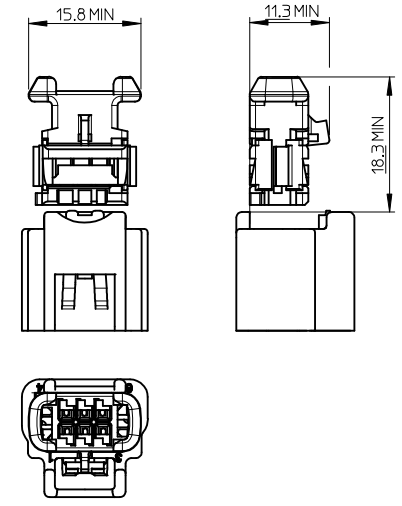

NECESSARY VOLUME FOR THE HOUSING ASSEMBLY.
ALLOW AN ADDITIONAL VOLUME FOR THE UNMATING

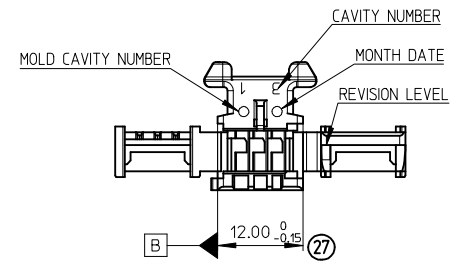
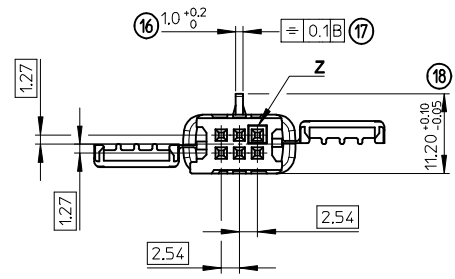
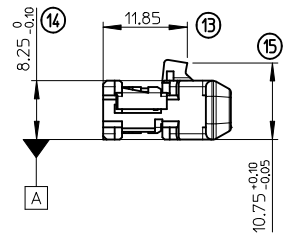
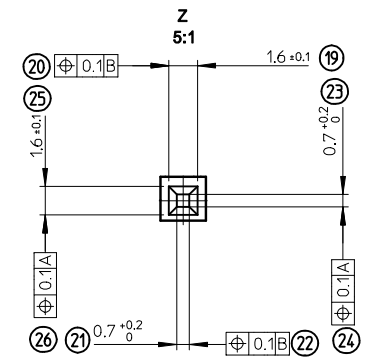
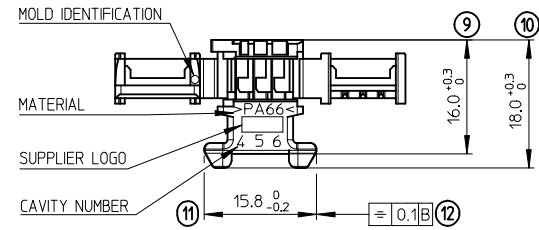

NOTES:

- 1- MATERIAL : POLYAMIDE (PA66) UNFILLED UL94V-2
- 2- USE WITH : 98658 (MOX 0.63 TERMINAL)
- 3- APPLICATION SPECIFICATION : AS-98787-001
- 4- MATE WITH : SERIES 98780 (HEADER)
- 5- WEIGHT : 1,060 g

ISO VIEW

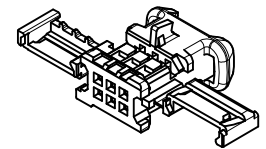

REVISED EC NO: G2013-0071 DRW: RDDSSANTOS 2011/02/22 CHK: AHERBELIN 2012/09/17 APPR: OPLESSIS 2012/11/23	DESCRIPTION [REDACTED]	GENERAL TOLERANCES (UNLESS SPECIFIED)		DIMENSION STYLE MM ONLY		SCALE 2:1	DESIGN UNITS METRIC	FIRST ANGLE PROJECTION	
		4 PLACES ± --- ± ---	mm INCH	DRAWN BY VGUERIN	DATE 2008/03/07	TITLE MOX RCPT HSG 0.635 CEM 6CKT			
		3 PLACES ± --- ± ---		CHECKED BY JLDUCLOS	DATE 2008/03/07	MATERIAL NO. SD-98786-001			
		2 PLACES ± 0.05 ± ---		APPROVED BY LSTICKEIR	DATE 2008/03/07	DOCUMENT NO. SD-98786-001			
1 PLACE ± 0.1 ± ---		ANGULAR ± 2 °		SEE CHART		SHEET NO. 1 OF 1			
0 PLACE ± --- ± ---		DRAFT WHERE APPLICABLE MUST REMAIN WITHIN DIMENSIONS		SIZE A2		THIS DRAWING CONTAINS INFORMATION THAT IS PROPRIETARY TO MOLEX INCORPORATED AND SHOULD NOT BE USED WITHOUT WRITTEN PERMISSION			