

NOTES: REFERENCE STANDARD IEC60169-11	332120		REVISIONS			
	DRAWING NO.	REV	DESCRIPTION	DATE	ECO	APPR
	THIRD ANGLE PROJ. 	A	RELEASE TO MFG.	13-Dec-13	--	AAP/BG

I. ELECTRICAL PERFORMANCE -

NOMINAL IMPEDANCE	: 50 Ω
FREQUENCY RANGE	: DC-3.0 GHz
VSWR	: 1.100 MAX.
PIM	: -160dBc MAX.(2x43dBm)
INSERTION LOSS	: 0.010 dB MAX.
INSULATION RESISTANCE	: 5000 MΩ MIN.
D.W.V	: 3000 VRMS
CONDUCTOR RESISTANCE	: OUTER CONDUCTOR 0.5 mΩ MAX.
	: INNER CONDUCTOR 1.0 mΩ MAX.

II. MECHANICAL PERFORMANCE -

(NUT) TORQUE	: 10-12 N.m
(NUT) WHORL PULL	: 500 N
TENSILE FORCE(CABLE-CONNECTOR)	: 500 N
TORSION(CABLE-CONNECTOR)	: 5 N-m

III. MATERIAL AND PLATING -

INNER CONDUCTOR	: SPRING COPPER ALLOY, PLATING = Ag (5µm MIN.)
OUTER CONDUCTOR	: BRASS, PLATING = COPPER-TIN-ZINC (2µm MIN.)
NUT	: BRASS, PLATING = NI (5µm MIN.)
GASKET	: SILICONE RUBBER
INSULATOR	: TPX

IV. ENVIRONMENTAL -

TEMP. RANGE	: -40°C TO +85°C
WEATHER STANDARD	: IEC 60068 40/ 085/ 21
THERMAL SHOCK	: IEC 60068-2-14-NA
VIBRATION	: IEC 60068-2-6-FC
SHOCK	: IEC 60068-2-27
WATERPROOFING STANDARD	: IP68

V. ASSEMBLY : INNER AND OUTER CONDUCTOR INSTALLED

VI. ROHS COMPLIANT

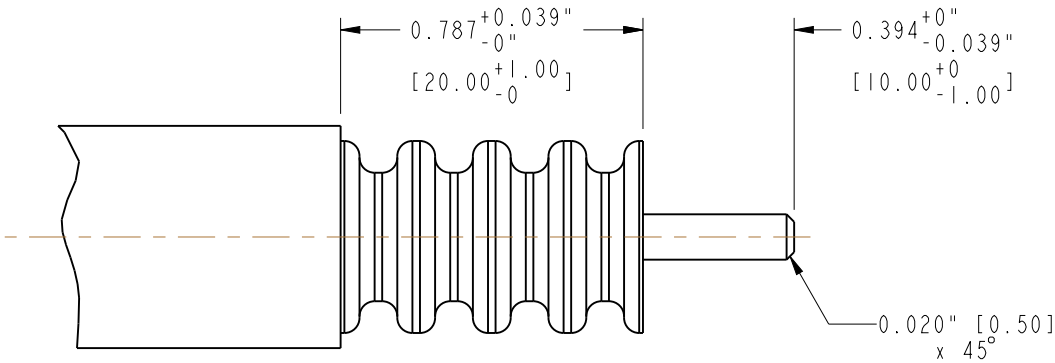

RECOMMENDED CABLE STRIPPING DIMENSIONS

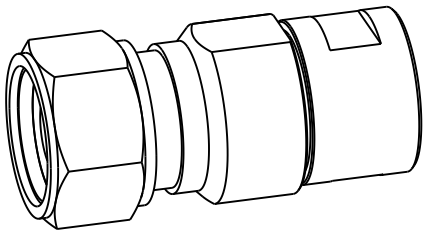

SCALE 1.000

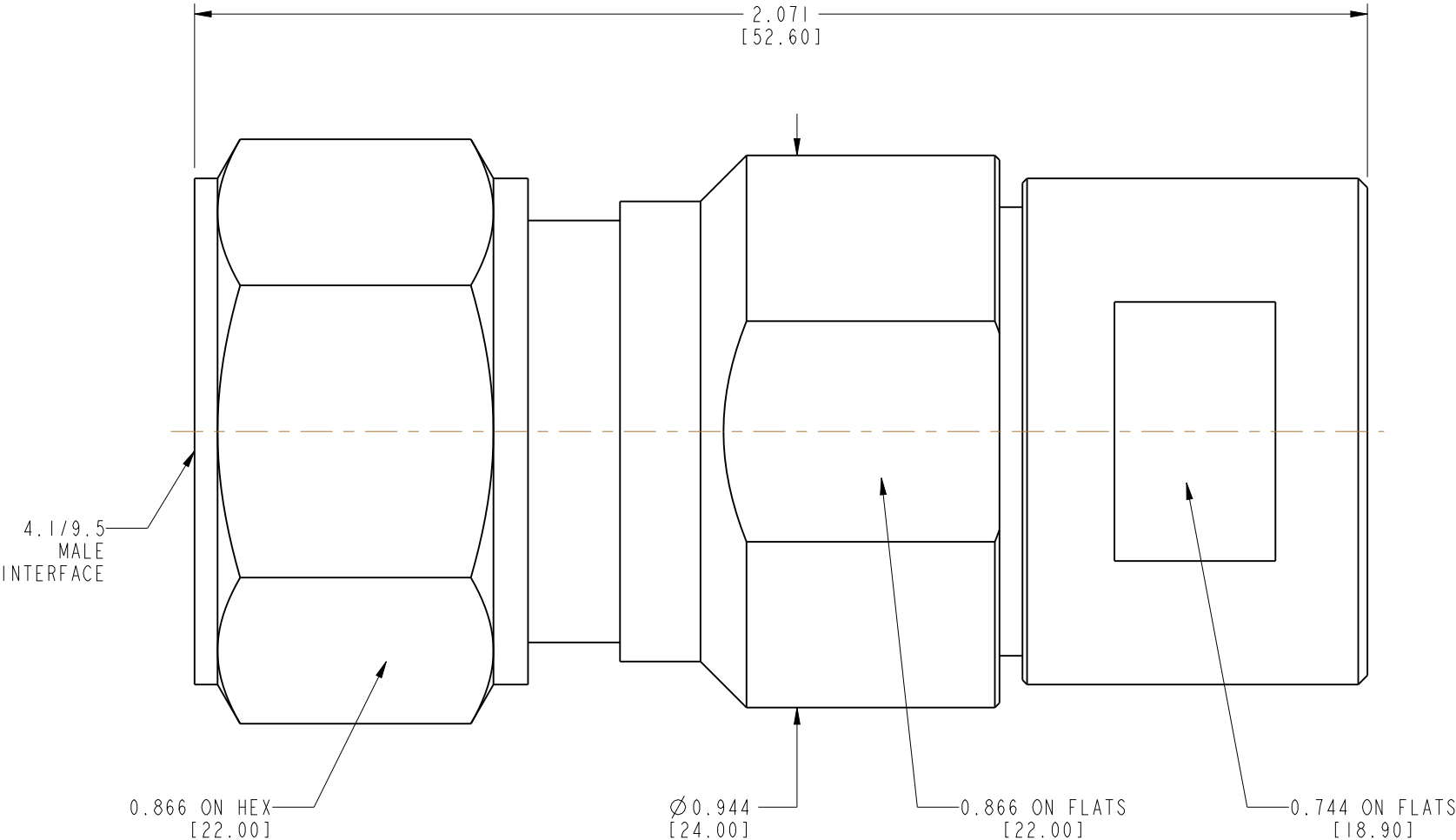

CUSTOMER OUTLINE DRAWING
ALL OTHER SHEETS ARE FOR INTERNAL USE ONLY

UNLESS OTHERWISE SPECIFIED, DIMENSIONS ARE IN INCHES AND TOLERANCES ARE: 2 PLACE DECIMAL 3 PLACE DECIMAL ANGLES ±.015 (0,381 mm) ±.005 (0,127 mm) ± 1°	MATERIAL SEE NOTES	DRAWN A ARUN PRABU	DATE 04-Oct-13	TITLE 4.1/9.5 MALE FOR 1/2" HELICAL CABLE		Amphenol Connex	
		ENGINEER A ARUN PRABU	DATE 04-Oct-13				
	REFERENCE	APPROVED B.C. GLEISSNER	DATE 13-Dec-13				
		CAD FILE		DWG SIZE B	DRAWING NO. 332120	SCALE: 3.5:1	SHEET 1 OF 1

Mouser Electronics

Authorized Distributor

Click to View Pricing, Inventory, Delivery & Lifecycle Information:

[Amphenol:](#)

[332120](#)