

LOC		DIST		REVISIONS			
P	LTN	DESCRIPTION	DATE	DMN	APVD		
A4		ECO-16-018646	17DEC2016	SZ	SZ		
A5		ECO-16-018684	30DEC2016	SZ	SZ		
A6		ECO-17-007909	01JUN2017	SZ	SZ		
B		ECO-19-003551	11MAR2019	SZ	SZ		

- NOTES, UNLESS OTHERWISE SPECIFIED
- MATERIAL:  
HOUSING - THERMOPLASTIC, GLASS PREINFORCED, COLOR, BLACK, UL 94V-0  
CONTACTS- COPPER ALLOY.
  - FINISH:  
MATING AREA - NOBLE METAL OVERALL NICKEL.  
PRESS FIT - MATTE TIN OVERALL NICKEL.
  - MARK P/N AND DATA CODE IN APPROX. AREA AS SHOWN.
  - NO BURRS AND/OR SHARP EDGES ARE PERMISSIBLE.
  - DATUMS AND BASIC DIMENSIONS ESTABLISHED BY CUSTOMER.
  - THE MARK "N" MEANS NUMBER OF THE CAVITY.

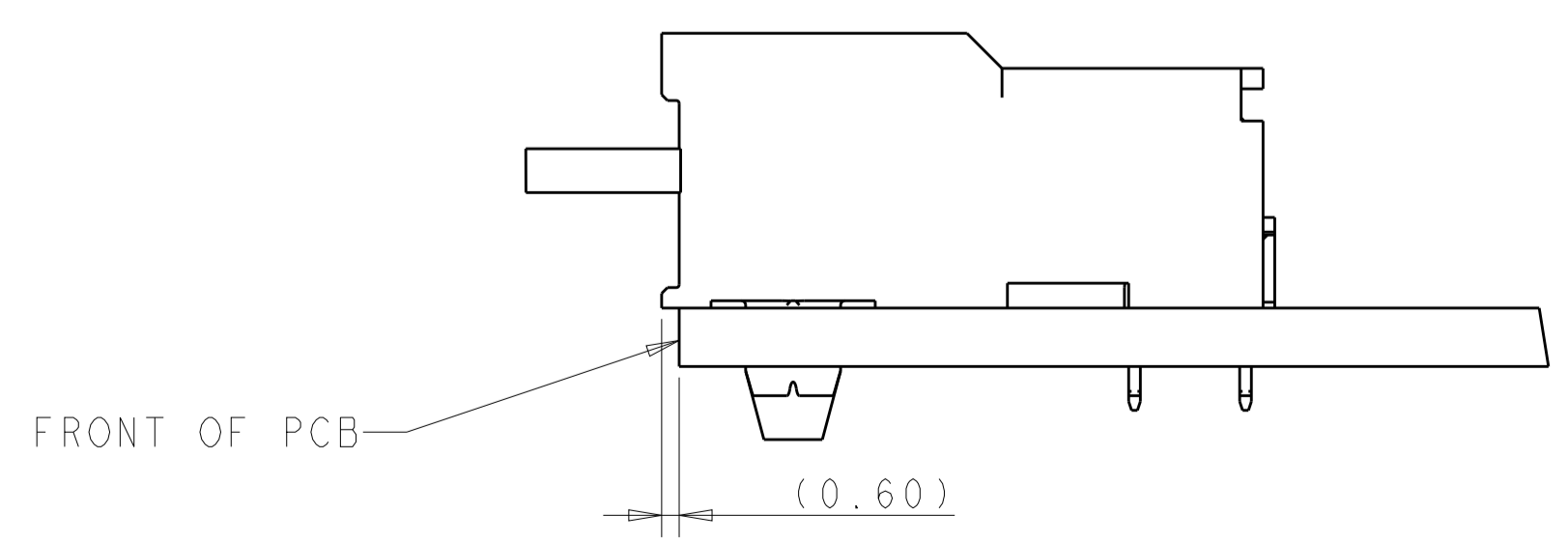
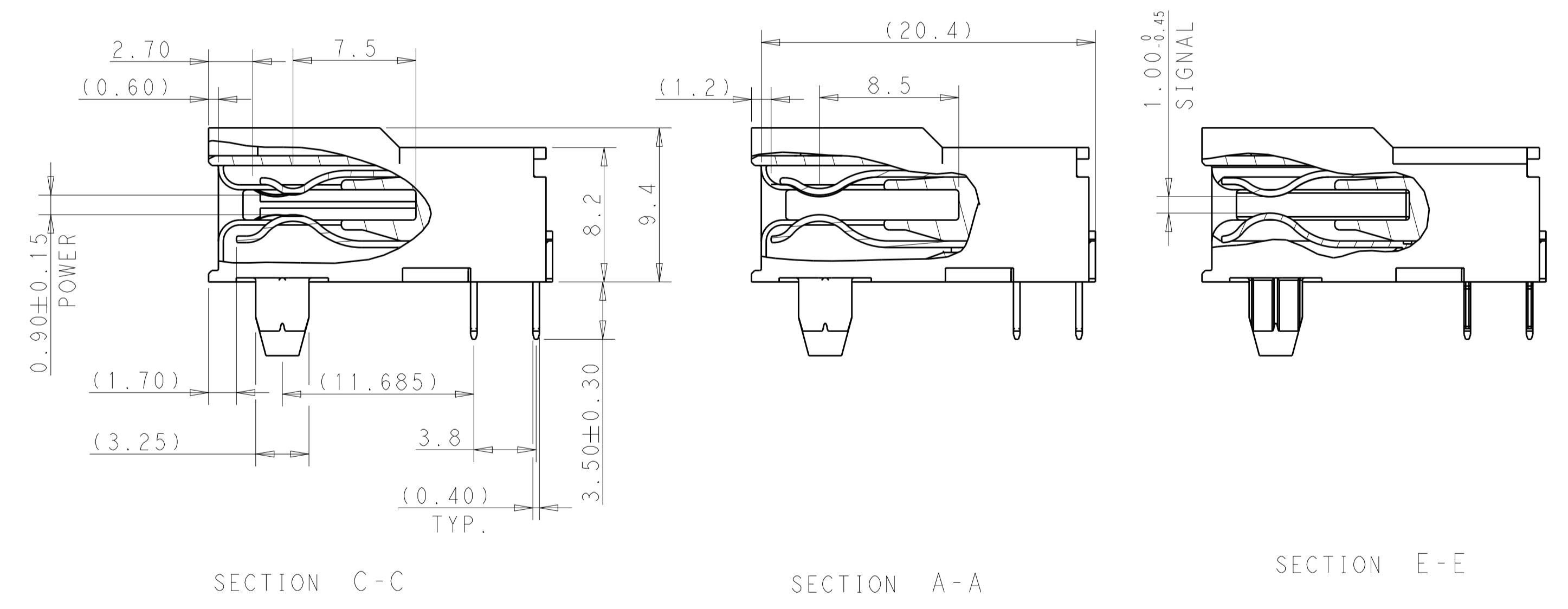
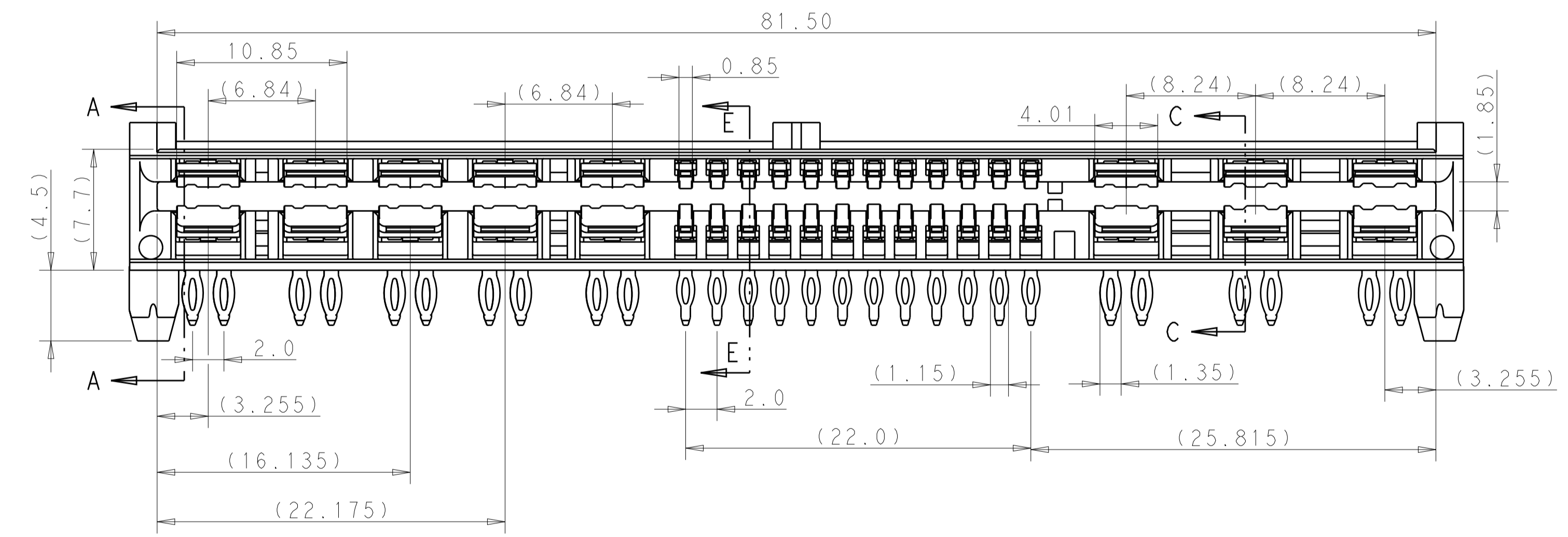
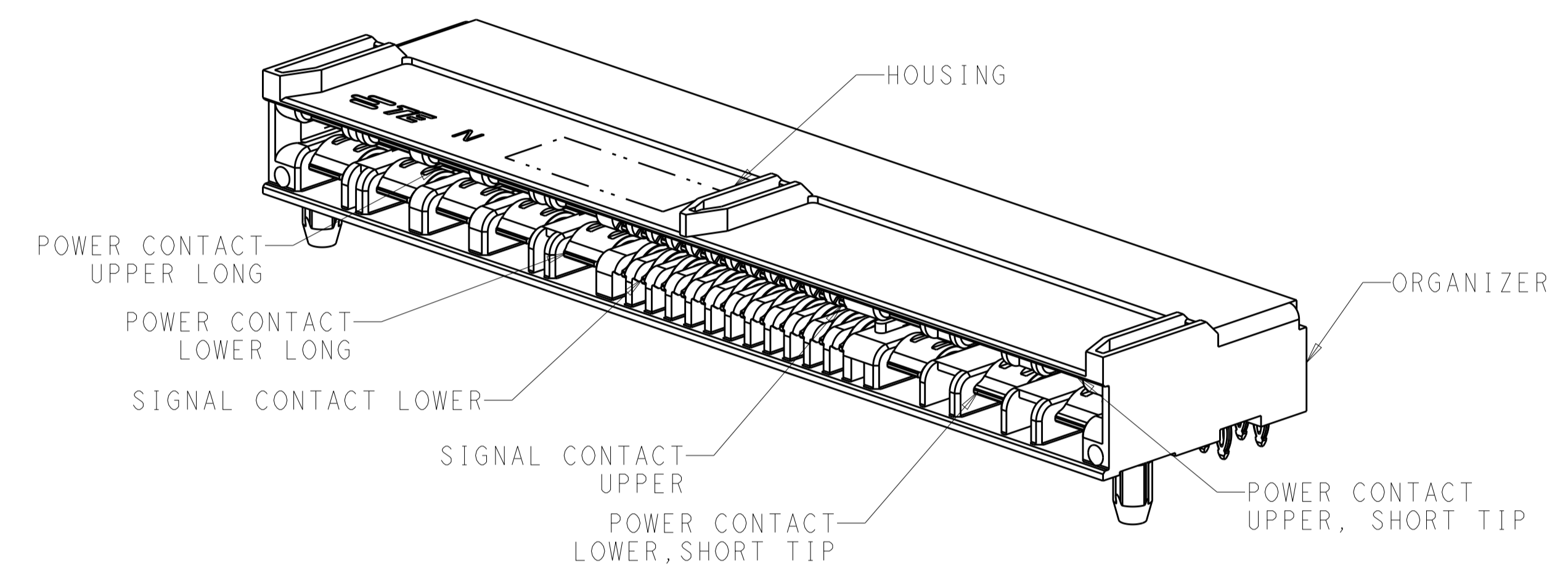
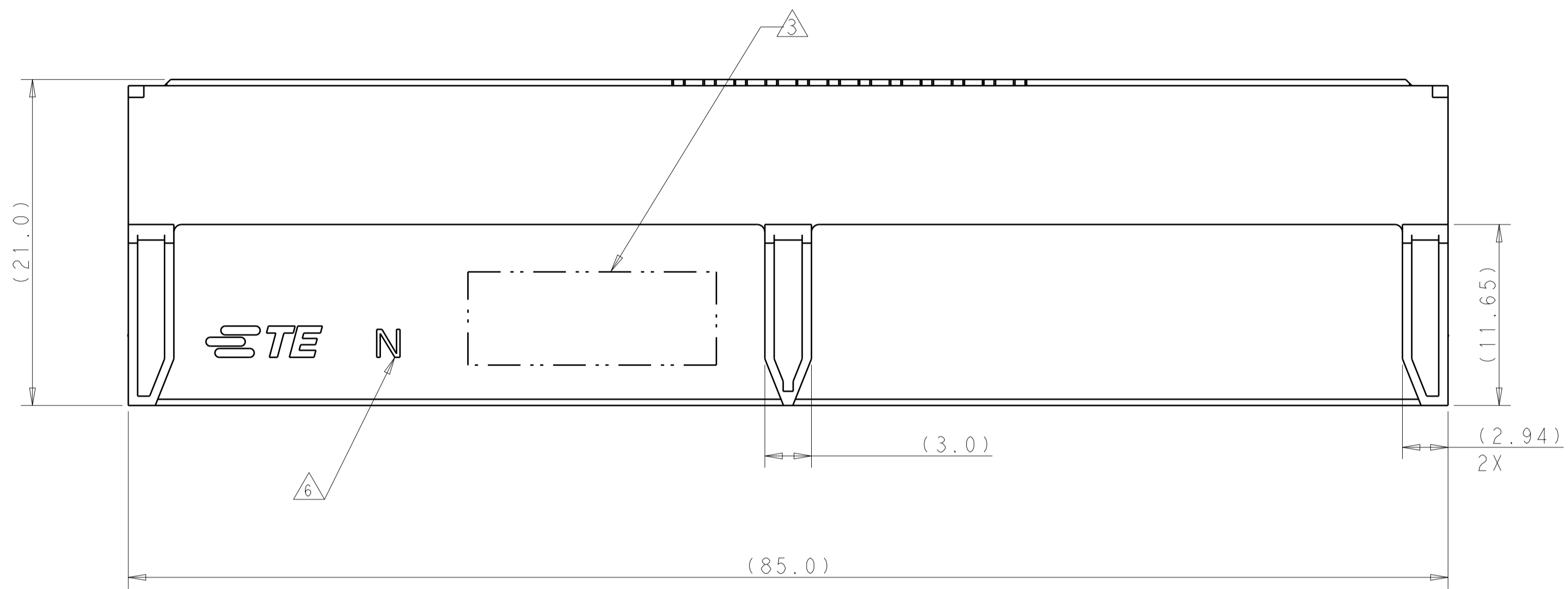

2170231-2	POWER CONTACT, LOWER, SHORT TIP	2
	POWER CONTACT, UPPER, SHORT TIP	2
	SIGNAL CONTACT, UPPER	2
	SIGNAL CONTACT, LOWER	2
	POWER CONTACT UPPER LONG	6
	POWER CONTACT LOWER LONG	6
	ORGANIZER	1
2170231-1	POWER CONTACT, LOWER, SHORT TIP	2
	POWER CONTACT, UPPER, SHORT TIP	2
	SIGNAL CONTACT, UPPER	12
	SIGNAL CONTACT, LOWER	12
	POWER CONTACT UPPER LONG	6
	POWER CONTACT LOWER LONG	6
	ORGANIZER	1
PRODUCT P/N	DESCRIPTION	Q'TY

THIS DRAWING IS A CONTROLLED DOCUMENT. DWN: JEFF GONG 10JAN2012  
CHK: ALEX SHOAL 10JAN2012  
APVD: MANGIAN WANG 10JAN2012

STE TE Connectivity

HYBRID POWER CARD EDGE PRESS FIT LOW PROFILE

108-60092 APPLICATION SPEC

A100779C=2170231

SCALE 4:1 SHEET 1 OF 2 REV B

LOC		DIST		REVISIONS			
P	LTN	DESCRIPTION	DATE	DMN	APVD		
-	-	SEE SHEET 1	-	-	-		

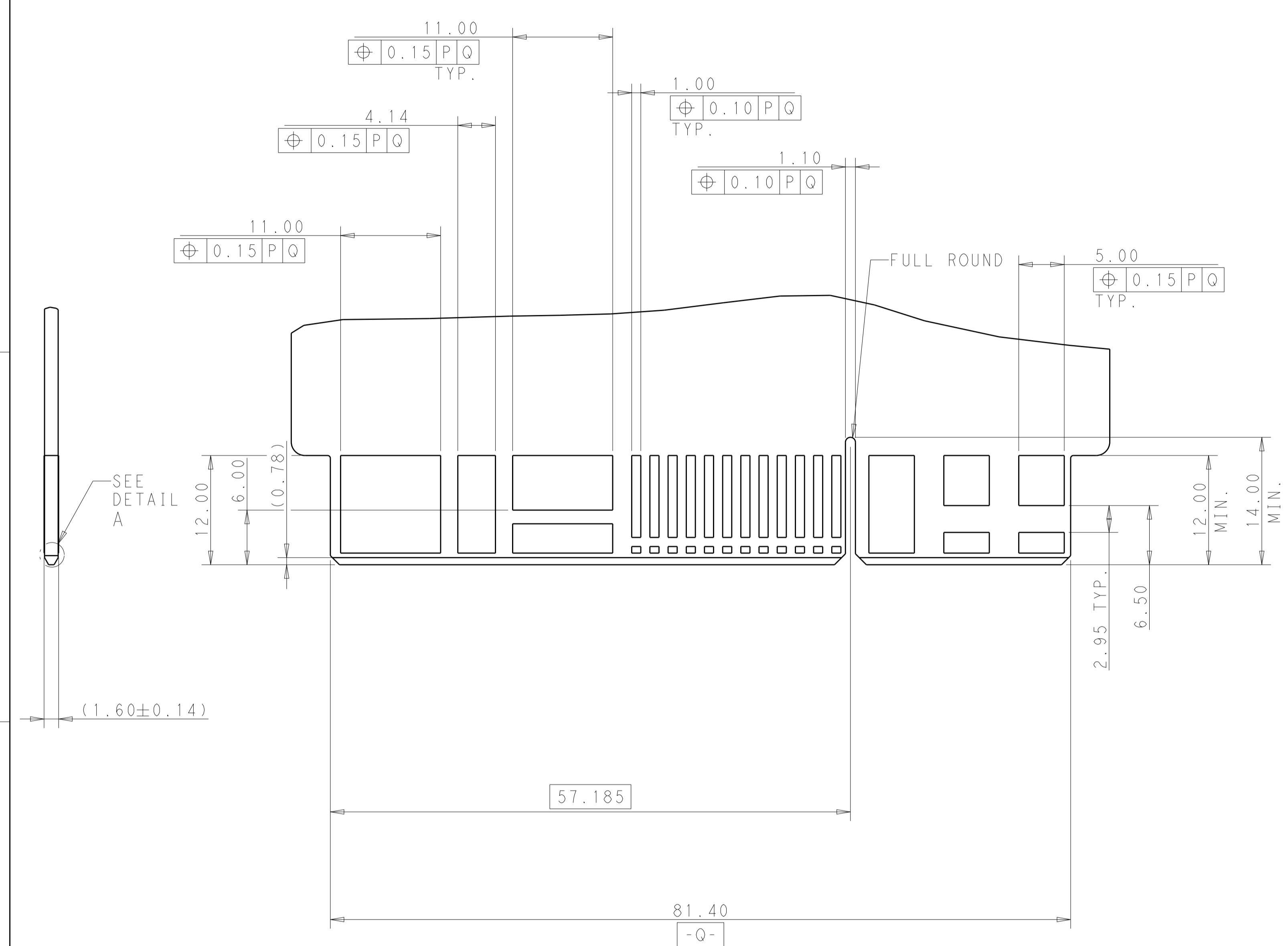

RECOMMENDED CARD EDGE CONFIGURATION  
TYP. BOTH SIDE

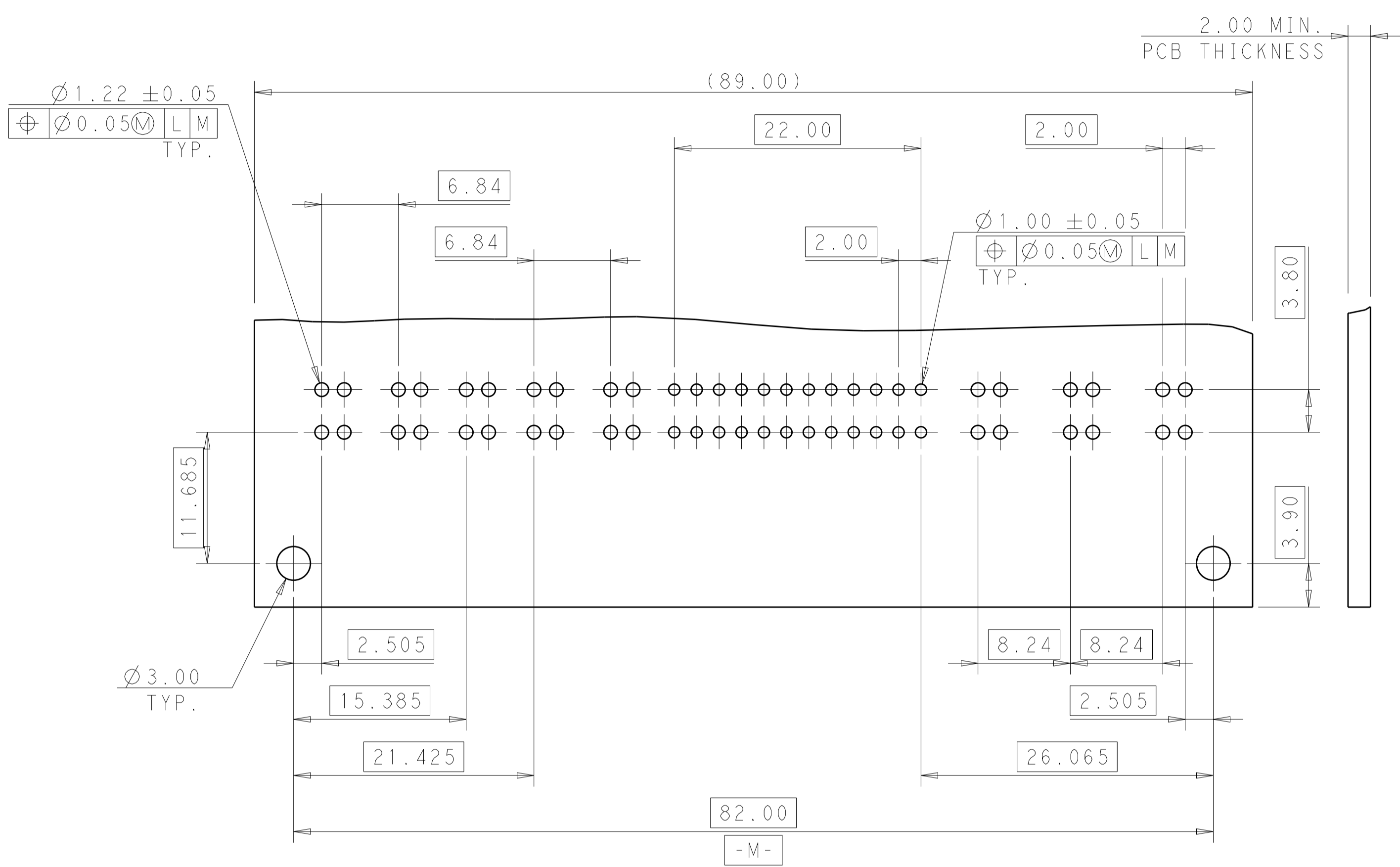

RECOMMENDED PRINTED CIRCUIT BOARD LAYOUT  
COMPONENT SIDE

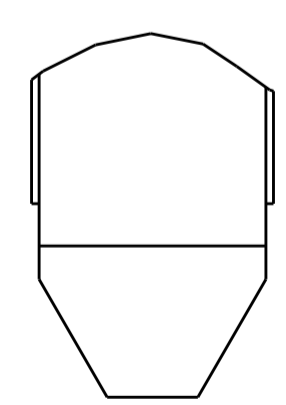

DETAIL A  
SCALE 20:1

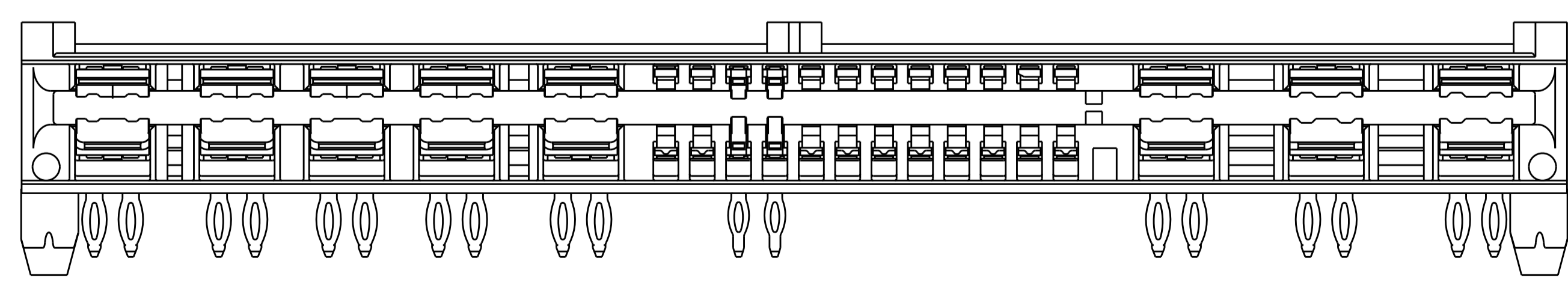

P/N: 2170231-2

NOTES, UNLESS OTHERWISE SPECIFIED:

1. PLATED THROUGH HOLE, SIGNAL:  
FINISHED HOLE SIZE: 1.00mm.  
DRILL HOLE SIZE: 1.10 ± 0.025mm.
2. PLATED THROUGH HOLE, POWER:  
FINISHED HOLE SIZE: 1.22mm.  
DRILL HOLE SIZE: 1.32 ± 0.025mm.
3. COPPER PLATING THICKNESS: 0.025~0.05mm.
4. SURFACE FINISH: OSP OR IMMERSION TIN PLATING IS RECOMMENDED.

THIS DRAWING IS A CONTROLLED DOCUMENT.		DMN: JEFF GONG 10JAN2012	TE Connectivity
DIMENSIONS: mm		CHK: ALEX SHOAL 10JAN2012	
TOLERANCES UNLESS OTHERWISE SPECIFIED:		APVD: MANGIAN WANG 10JAN2012	NAME: HYBRID POWER CARD EDGE PRESS FIT LOW PROFILE PRODUCT SPEC: 108-60092 APPLICATION SPEC:
0 PLC ±0.2 2 PLC ±0.1 3 PLC ±0.05 4 PLC ±0.05 ANGLES ±0.2		SIZE: A1 CAGE CODE: 100779 DRAWING NO: 2170231	
MATERIAL:		WEIGHT:	RESTRICTED TO:
FINISH:		CUSTOMER DRAWING	SCALE: 4:1 SHEET 2 OF 2 REV B