

NUMBER 178141
 METRIC
 DIMENSIONS IN MILLIMETERS. DO NOT SCALE PRINT
 PRINT DIST

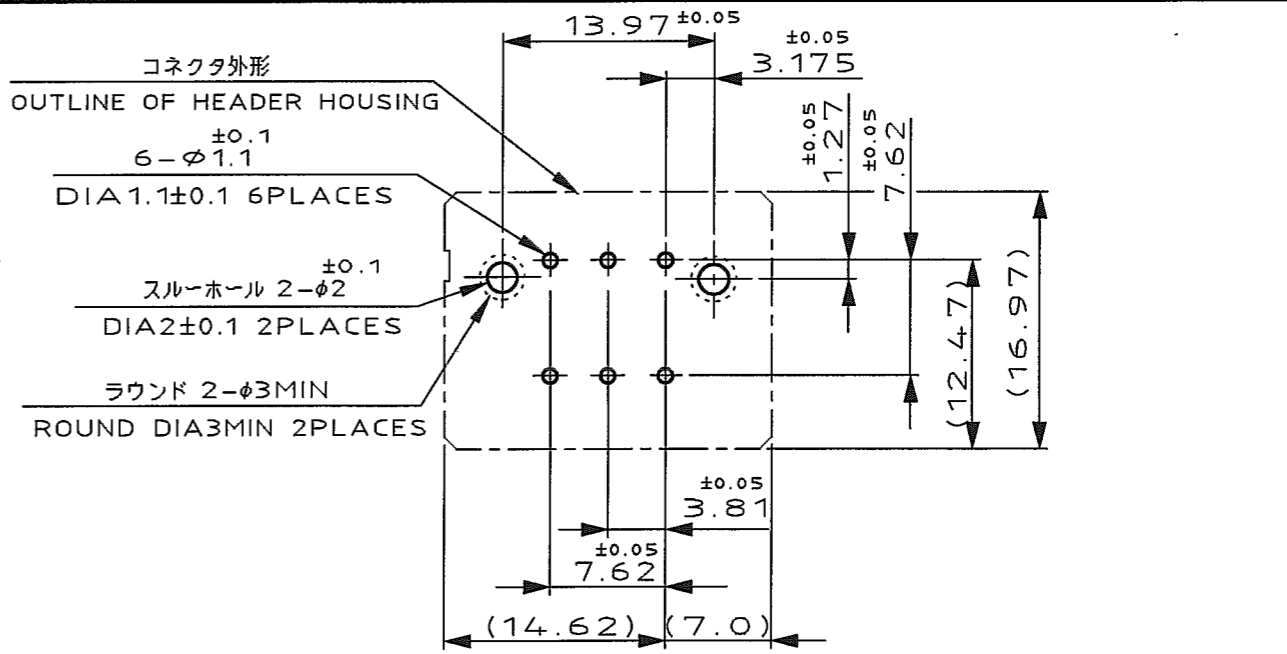
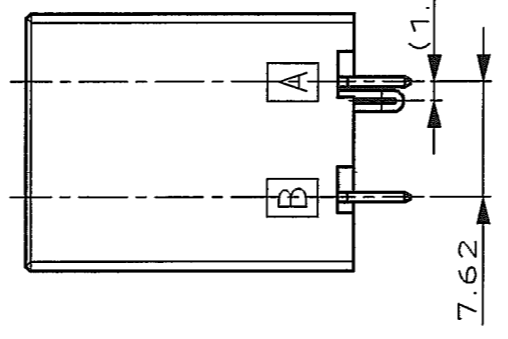
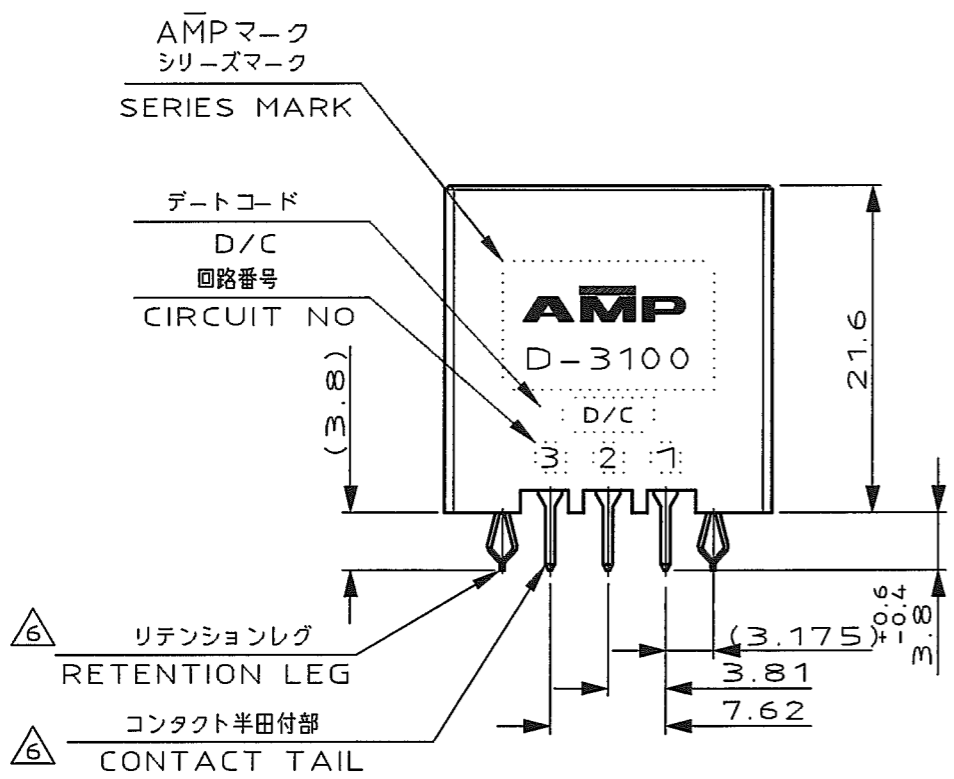
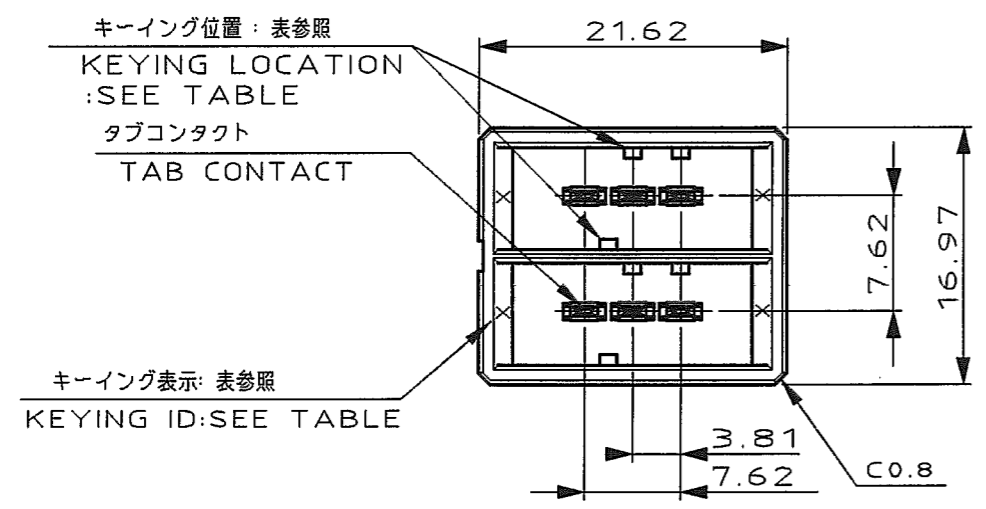

推奨基板取付け寸法
 PC 基板厚: 1.6±0.1 (非累積公差) (コネクタ搭載面)
 RECOMEND PC BOARD HOLE PATTERN
 PC BOARD THICKNESS: 1.6±0.1 (NOT ACCUMULATE TOLERANCE) (CONNECTOR MOUNT SIDE)

NOTES

- MATERIAL: HOUSING: GLASS FILLED THERMO PLASTIC, POLYESTER (94V-0), COLOR: BLACK
 CONTACT: COPPER ALLOY
 RETENTION LEG: COPPER ALLOY
- △1. FINISH (CONTACT AREA): 0.38μm MIN GOLD PLATING OVER Ni PLATING
- △2. FINISH (CONTACT AREA): 0.76μm MIN GOLD PLATING OVER Ni PLATING
- △3. FINISH (CONTACT AREA): 2.0 μm MIN TIN PLATED OVER NICKEL
- △4. FINISH (RETENTION LEG): TIN-LEAD PLATED (CONTACT TAIL) OVER NICKEL
- △5. FINISH (RETENTION LEG): TIN PLATED (CONTACT TAIL) OVER NICKEL

注記

- 材料: ハウジング: ガラス入り熱可塑性ポリエステル樹脂 (94V-0), 色: 黒
 コネクタ: 銅合金
 リテンションレグ: 銅合金
- △1. めっき: コネクタ: 全面Ni下地
 接触部: 0.38μm MIN金めっき
- △2. めっき: コネクタ: 全面Ni下地
 接触部: 0.76μm MIN金めっき
- △3. めっき: コネクタ: 全面Ni下地
 接触部: 2.0 μm MINスズめっき
- △4. めっき: リテンションレグとコネクタ半田付部
 : ニッケル下地の上に半田めっき
- △5. めっき: リテンションレグとコネクタ半田付部
 : ニッケル下地の上にスズめっき

A ROW		X	Y	△6	△4	3-178141-5	
B ROW				△6	△3	3-178141-3	
A ROW		X	X	△6	△4	1-178141-5	
B ROW				△6	△3	1-178141-3	
				△6	△2	1-178141-2	
KEYING LOCATION				A ROW KEYING	B ROW KEYING	FINISH	製品番号 PART NO.



WIRE RANGE	INSULATION DIA	NAME	DYNAMIC D-3100 3.81X7.62PITCH(V) 6 POS.HDR CONN.ASS'Y		
mm(AWG)	mmφ		SIZE	LOC	NUMBER
SEE NOTE	SEE NOTE		A3	J	C-178141
DR. 19 APR 94 N. Matsubara	DE. 19 APR 94 N. Matsubara	一般公差 (GENERAL TOLERANCE)	SCALE	REV.	SHEET
CHK. S. MANABE	APP. S. MANABE	100% ±0.3 100% 300% ±0.4 300% 100% ±0.45 角度: ±3'	2-1	E1	1 OF 1

E1	REVISED PER ECO-11-005030	RK	HMR	28MAR 11
LTR	REVISION RECORD	DR	CHK	DATE

Mouser Electronics

Authorized Distributor

Click to View Pricing, Inventory, Delivery & Lifecycle Information:

[TE Connectivity:](#)

[3-178141-5](#)