

NOTES:

1. ALL DIMENSIONS ARE IN  $\frac{\text{INCHES}}{[\text{MILLIMETERS}]}$ ;  $\frac{\text{LBS}}{[\text{GRAMS}]}$

2. DIMENSIONS APPEARING IN TABLE ARE AS FOLLOWS:

- a AS SUPPLIED
- b AFTER UNRESTRICTED RECOVERY

**△** COATING (ADHESIVE) IS OPTIONAL. AS SUPPLIED DIMENSIONS APPEARING IN TABLE ARE FOR UNCOATED PARTS. WHEN COATING IS ADDED, ENTRY DIAMETERS WILL BE REDUCED BY .06 MAX.

**△** MOLDING PORTS ARE OPTIONAL. WHEN -00 MODIFICATION NUMBER IS SPECIFIED MOLDING PORTS WILL BE LOCATED AS SHOWN.

ON SIZES 222A111 AND 222A121 THE 0.18 INCH DIAMETER MOLDING PORT AT "T" WILL BE ELIMINATED. THE 0.12" DIA MOLDING PORT WILL BE ENLARGED TO 0.18 INCHES

5. WEIGHT SHOWN IN TABLE OF DIMENSIONS IS BASED ON POLYOLEFIN PART

6. ORDERING INFORMATION 222A1XX -XX -XX /XXX /0

- BASE PART NUMBER \_\_\_\_\_
- MATERIAL DASH NUMBER \_\_\_\_\_
- 3 POLYOLEFIN, SEMI RIGID (RT-301)
  - 4 POLYOLEFIN, FLEXIBLE (RT-1304)
  - 5 ELASTOMER, FLEXIBLE (RT-501)
  - 6 SILICONE (RT-602)
  - 12 FLUORO ELASTOMER, FLEXIBLE (RT-1312)
  - 25 ELASTOMER, FLUID RESISTANT (RW-2070)
  - 100 POLYOLEFIN, SEMI-FLEXIBLE ZEROHAL (RT-1323)

MODIFICATION NUMBER \_\_\_\_\_

ADHESIVE SLASH NUMBER \_\_\_\_\_  
SEE COMPATIBILITY CHART BELOW

COLOR DESIGNATOR \_\_\_\_\_

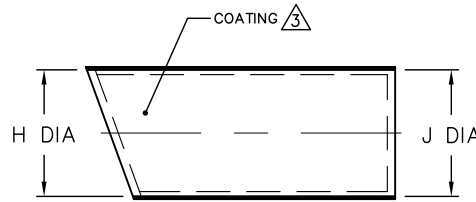

AS SUPPLIED

REVISIONS		
LTR	DESCRIPTION	DATE
V	REVISED PER ECO-15-010088	07/01/15

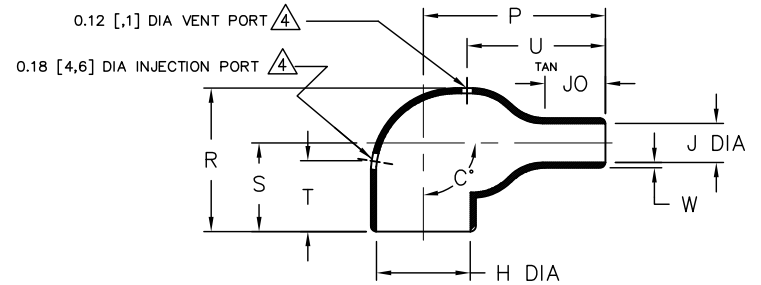

AFTER UNRESTRICTED RECOVERY

PART DESCRIPTION	H		J			P	R	S	T	U	JO	W	C*		WEIGHT REF
	MIN	MAX	MIN	MIN	MAX	±10%	±10%	±10%	±10%	±10%	±10%	±20%	±10%	±5%	
	-3,-4,-5,-6 -12,-25,-100 a	b	-3,-4 -6,-25 a	-5,-12 -100 a	b	b	b	b	b	b	b	b	a	b	b
222A111	.70 [17,8]	.31 [7,9]	.70 [17,8]	.39 [9,9]	.15 [3,8]	.68 [17,3]	.79 [20,1]	.61 [15,5]	N/A	.45 [11,4]	.17 [4,3]	.04 [1,02]	180	90	.002 [0,91]
222A121	.98 [24,9]	.40 [10,2]	.98 [24,9]	.71 [18,0]	.21 [5,3]	.84 [21,3]	.89 [22,6]	.65 [16,5]	N/A	.58 [14,7]	.23 [5,8]	.05 [1,3]	180	90	.003 [1,36]
222A132	1.18 [30,0]	.56 [14,2]	1.18 [30,0]	.81 [20,6]	.25 [6,4]	1.06 [26,9]	1.05 [26,7]	.73 [18,5]	.75 [19,1]	.70 [17,8]	.28 [7,1]	.06 [1,5]	180	90	.006 [2,72]
222A142	1.28 [32,5]	.68 [17,3]	1.28 [32,5]	.90 [22,9]	.27 [6,9]	1.44 [36,6]	1.20 [30,5]	.81 [20,6]	.75 [19,1]	.98 [24,9]	.40 [10,2]	.07 [1,8]	180	90	.014 [6,35]
222A152	1.42 [36,1]	.86 [21,8]	1.42 [36,1]	1.04 [26,4]	.33 [8,4]	1.72 [43,7]	1.38 [35,1]	.90 [22,9]	.75 [19,1]	1.18 [30,0]	.50 [12,7]	.07 [1,8]	180	90	.019 [8,62]
222A163	1.73 [43,9]	1.08 [27,4]	1.73 [43,9]	1.08 [27,4]	.37 [9,4]	2.11 [53,6]	1.73 [43,9]	1.15 [29,2]	.75 [19,1]	1.34 [34,0]	.68 [17,3]	.08 [2,0]	180	90	.029 [13,15]
222A174	2.09 [53,1]	1.33 [33,8]	2.09 [53,1]	1.84 [46,7]	.59 [15,0]	2.98 [75,7]	2.08 [52,8]	1.34 [34,0]	1.00 [25,4]	2.10 [53,3]	1.26 [32,0]	.13 [3,3]	180	90	.077 [34,93]
222A185	2.66 [67,6]	1.74 [44,2]	2.66 [67,6]	2.14 [54,4]	.80 [20,3]	3.84 [97,5]	2.60 [66,0]	1.66 [42,2]	1.00 [25,4]	2.80 [71,1]	1.60 [40,6]	.15 [3,8]	180	90	.143 [64,86]
222A196	3.45 [87,6]	2.18 [55,4]	3.45 [87,6]	2.48 [63,0]	.92 [23,4]	5.04 [128,0]	3.12 [79,2]	1.93 [49,0]	1.00 [25,4]	3.45 [87,6]	2.22 [56,4]	.18 [4,6]	180	90	.310 [140,6]

IF THIS DOCUMENT IS PRINTED IT BECOMES UNCONTROLLED. CHECK FOR THE LATEST REVISION.

COMPATIBILITY CHART

MATERIAL DASH NO.	ADHESIVE (COATING) SLASH NO.	ADHESIVE (COATING) S NO.
-3; -4	/42; /86	S-1017; S-1048;
-5	/42	S-1017
-6; -12	NOT APPLICABLE	N/A
-25	/42; /86; /225	S-1017; S-1048; S-1206
-100	/86; /180; /184	S-1017; S-1030

UNLESS OTHERWISE SPECIFIED DIMENSIONS ARE INCHES. METRIC DIMENSIONS ARE IN BRACKETS.

DECIMAL TOLERANCES  
 .XXX ± 0.005 [0.13 mm]  
 .XX ± 0.01 [0.25 mm]  
 .X ± 0.1 [0.50 mm]

ANGLE TOLERANCE  
 .X ± 1 DEG.

TE CONNECTIVITY RESERVES THE RIGHT TO AMEND THIS DRAWING AT ANY TIME. USERS SHOULD EVALUATE THE SUITABILITY OF THE PRODUCT FOR THEIR APPLICATION.

© 2015 Tyco Electronics Corporation. A TE Connectivity Ltd. company. All rights reserved.

DRAWN  
YUNGUYEN

APPROVED  
DHURRELL

THIRD ANGLE PROJECTION

**TE Connectivity** Raychem Molded Parts  
305 Constitution Dr  
Menlo Park, CA 94025

TITLE  
**BOOT, 90 DEGREE, THIN WALL**

SIZE B CODE IDENT. NO. 06090 DWG. NO. 222A111thru196

DO NOT SCALE THIS DRAWING SHEET 1 OF 1

# Mouser Electronics

Authorized Distributor

Click to View Pricing, Inventory, Delivery & Lifecycle Information:

## TE Connectivity:

[222A121-3/86-0](#) [222A121-3-0](#) [222A132-3-0-CS5501](#) [222A142-4-0-CS5059](#) [222A174-25-0](#) [222A163-3-00-0](#)  
[222A111-25-00-0](#) [222A163-25-00-0](#) [222A132-4-0](#) [222A152-4-0](#) [222A174-25/225-0](#) [222A152-25-G03-0](#) [222A111-](#)  
[100-0](#) [222A152-3-00-0](#) [222A132-3-0-CS5059](#) [222A132-100-0](#) [222A142-4/42-0](#) [222A132-4/86-0](#) [222A152-12-0](#)  
[222A163-4/86-0](#) [222A121-4/42-0](#) [222A132-3-00-0](#) [222A111-25-G07/225-0](#) [222A142-25/42-0](#) [222A121-25/42-0](#)  
[222A111-25/42-0](#) [222A142-3/86-0](#) [222A142-100/180-0](#) [222A121-15-0](#) [222A111-100/180-0](#) [222A196-3-0](#) [222A121-](#)  
[25/86-0](#)