

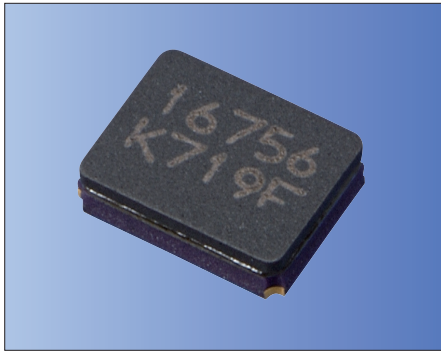

3.2×2.5mm for Consumer Products



RoHS Compliant

### Features

- Crystal unit for Consumer Products
- Small and low profile 0.9mm max. (3.2×2.5×0.8mm)
- Ceramic package
- Reflow compatible

### Applications

- Digital Electronics
- Consumer Products

### How to Order

CX3225GB 27000 D0 H E Q CC  
 ① ② ③ ④ ⑤ ⑥ ⑦

- ①Series
- ②Frequency
- ③Load Capacitance
- ④Frequency Tolerance
- ⑤Operating Temp. Range
- ⑥Frequency Temp. Stability
- ⑦Individual Specification (STD Specification is "CC")

Ⓜ Packaging (Tape & Reel 3000 pcs./ reel)

### Specifications

Item	Symbol	Specification	Unit	Remarks
Frequency Range	f <sub>nom</sub>	12000 to 54000	kHz	
Overtone Order	OT	Fundamental	—	
Load Capacitance	CL	8	pF	Please contact us for other CL requirements.
Frequency Tolerance	f <sub>tol</sub>	±20	×10 <sup>-6</sup>	25°C±3°C
Motional Series Resistance	R1	Table 1	ohm	
Drive Level	DL	Table 2	μW	
Operating Temp. Range	T <sub>use</sub>	-10 to +70	°C	
Storage Temp. Range	T <sub>stg</sub>	-40 to +85	°C	
Frequency Temp. Characteristics	f <sub>tem</sub>	±30	×10 <sup>-6</sup>	Freq. deviation from the value at 25°C

Please contact us for other specifications.

Table 1 Motional Series Resistance

Frequency Range	Motional Series Resistance
12000 ≤ f <sub>nom</sub> < 13000kHz	150 Ω max.
13000 ≤ f <sub>nom</sub> < 14000kHz	100 Ω max.
14000 ≤ f <sub>nom</sub> < 20000kHz	80 Ω max.
20000 ≤ f <sub>nom</sub> < 27000kHz	60 Ω max.
27000 ≤ f <sub>nom</sub> ≤ 54000kHz	50 Ω max.

Table 2 Level of Drive

Frequency Range	Level of Drive
12000 ≤ f <sub>nom</sub> ≤ 54000kHz	10μW (100μW max.)

### Dimensions

(Unit: mm)

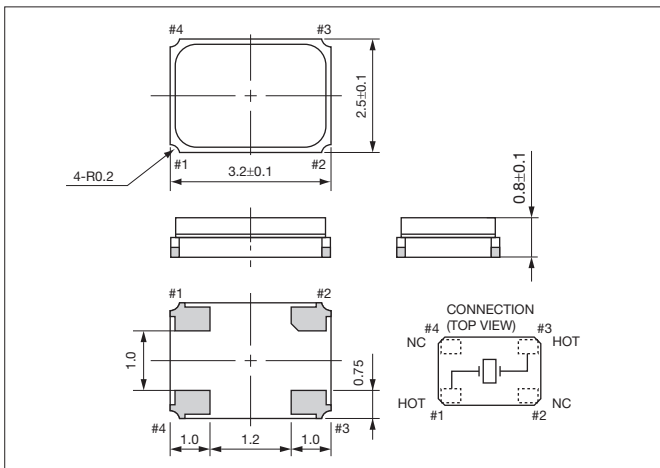

### Recommended Land Pattern

(Unit: mm)

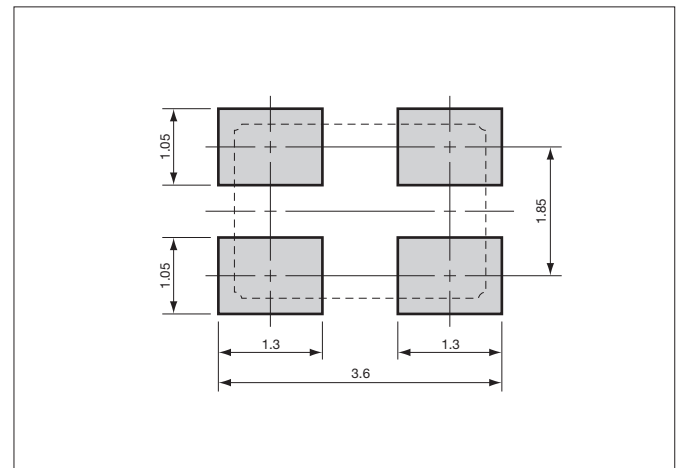

# Mouser Electronics

Authorized Distributor

Click to View Pricing, Inventory, Delivery & Lifecycle Information:

## Kyocera:

[CX-96F-040.000-E0107](#) [KSX-35-16368KAC-MF0R](#) [ST4115SB32768E0HPWZZ](#) [ST4115SB32768H5HPWZZ](#)  
[CX101F-040.000-H0445](#) [CX49GFWB04000H0PESZZ](#) [CX49GFWB04915H0PESZZ](#) [CX49GFWB06000H0PESZZ](#)  
[CX49GFWB08000H0PESZZ](#) [CX49GFWB12000H0PESZZ](#) [CX49GFWB14318H0PESZZ](#) [CX49GFWB16000H0PESZZ](#)  
[CX49GFWB18432H0PESZZ](#) [CX49GFWB20000H0PESZZ](#) [CX49GFWB24000H0PESZZ](#) [CX49GFWB27000H0PESZZ](#)  
[CX49GFNB04332H0PESZZ](#) [CX49GFNB20000H0PESZZ](#)