

PRODUCT DATA DRAWING

REVISION HISTORY			
REV	DESCRIPTION	DATE	APPROVED
-	DCN 39255	07/12	STW
A	DCN 41517	07/15	STW

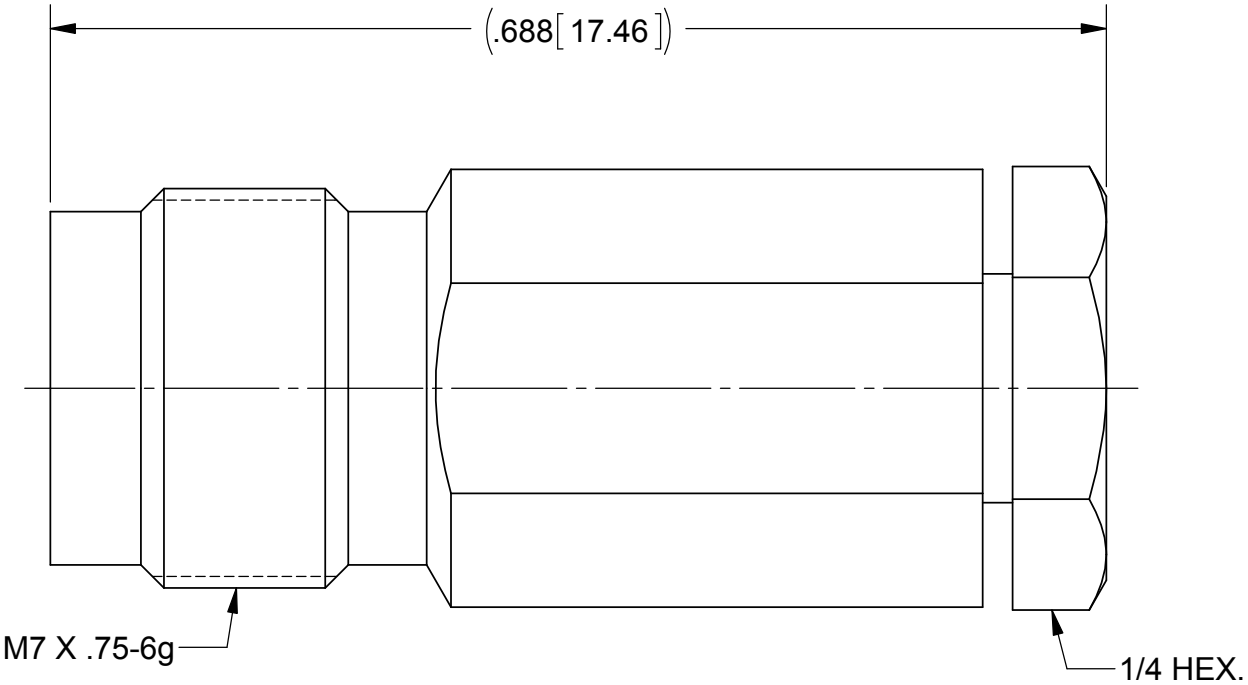
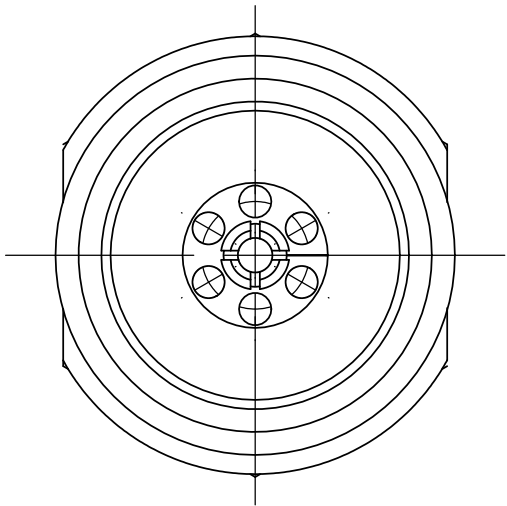
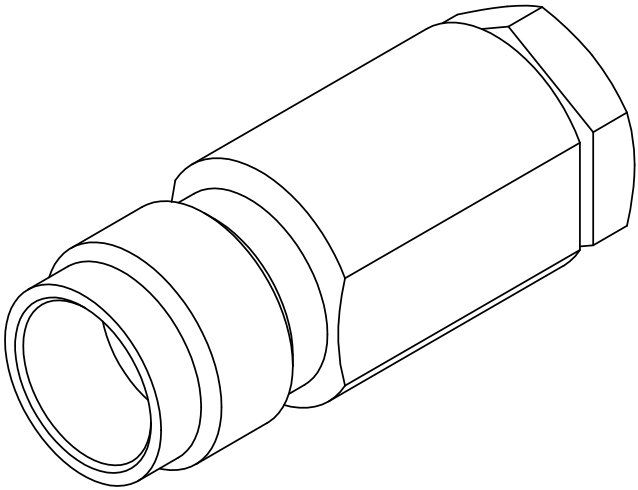

MATERIAL:

BODY, FERRULE & CLAMP NUT:	STAINLESS STEEL
CONTACT:	BERYLLIUM COPPER
BEAD:	ULTEM 1000
SPACER:	PTFE

FINISH:

BODY & CLAMP NUT:	PASSIVATED
FERRULE & CONTACT:	GOLD OVER NICKEL

PERFORMANCE:

IMPEDANCE:	50 OHMS
FREQ. RANGE:	DC TO 50.0 GHz.
VSWR:	1.35:1 DC TO 50.0 GHz.
INSERTION LOSS:	.05 X SQRT (F (F IN GHz.))

MATERIAL:	SEE NOTES	DIMENSIONS ARE IN INCHES TOLERANCES: FRACTIONAL: ±1/64 ANGULAR: X° ±1°0'
-----------	-----------	---

Mouser Electronics

Authorized Distributor

Click to View Pricing, Inventory, Delivery & Lifecycle Information:

[Amphenol:](#)

[SF1621-60009](#)