

**FC-26163-000**

**SHT 1.1**

NOTES:

- 1. INCREASED PRESSURE AT THE SOUND INLET CAUSES A POSITIVE GOING VOLTAGE TO APPEAR AT THE OUTPUT TERMINAL, RELATIVE TO THE NEGATIVE TERMINAL.

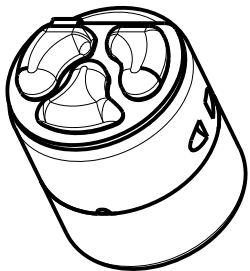
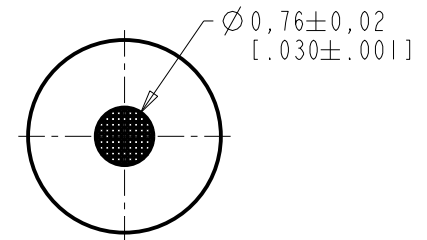
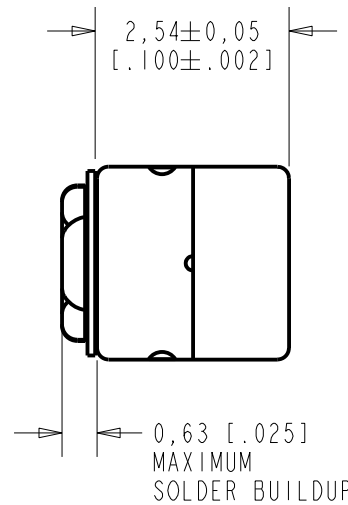
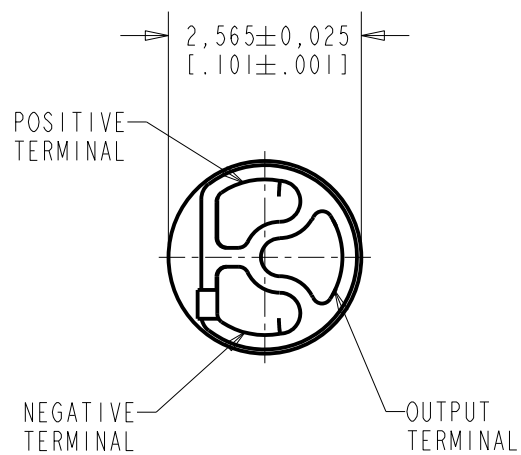

DIMENSIONS IN MILLIMETERS [INCHES]

Revision	C.O. #	Implementation Date	RELEASE LEVEL	REVISION
F	MI0104840	10-10-12	<b>Active</b>	<b>F</b>
E	MI0104555	4-12-12		
D	MI0103600	4-20-10		
SCALE: 10:1			DR. BY	DATE
DO NOT SCALE DRAWING			MMM	3-6-06
TITLE: MICROPHONE			CK. BY	DATE
OUTLINE DRAWING			GJP	3-8-06
FC-26163-000			APP. BY	DATE
SHT 1.1			GJP	3-8-06

**KNOWLES ELECTRONICS**  
ITASCA, ILLINOIS U.S.A.

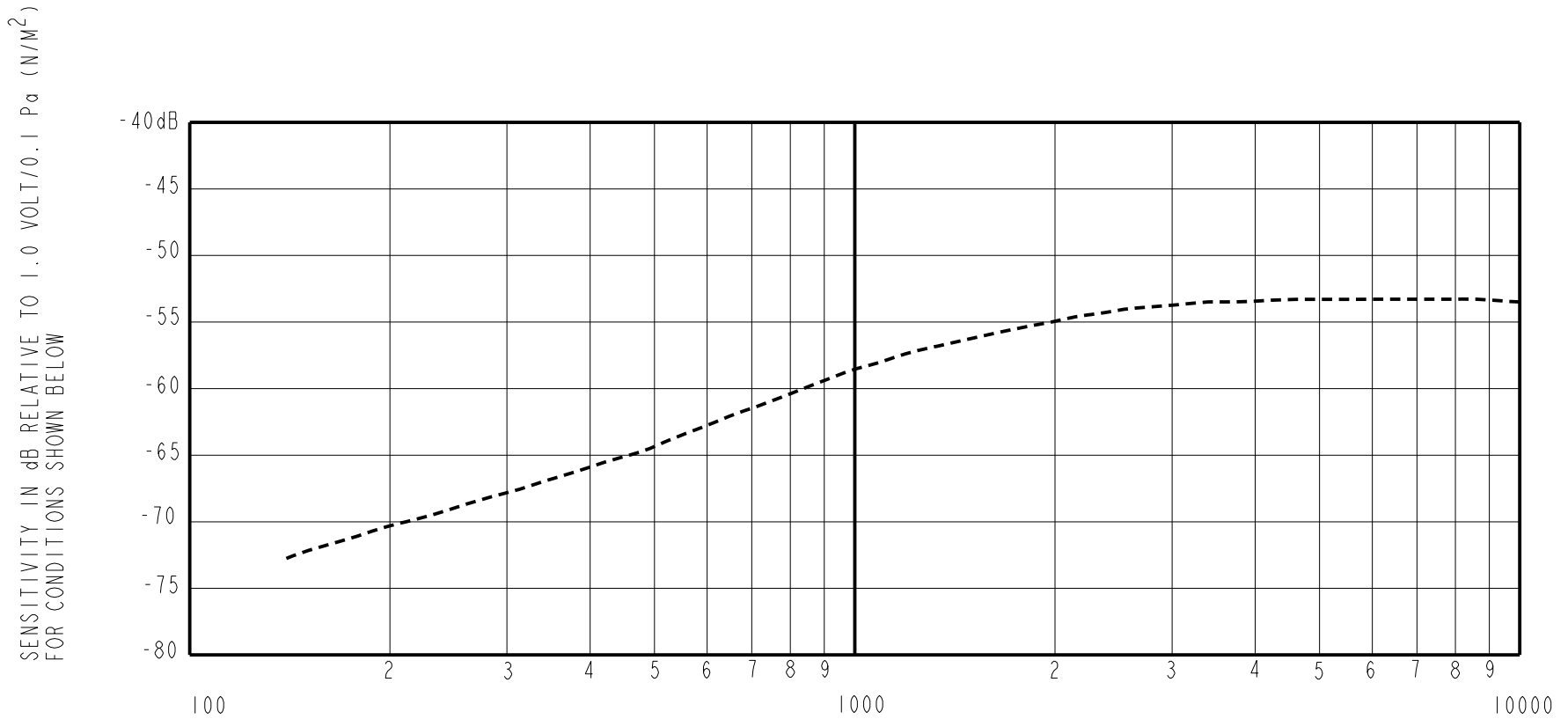

FREQUENCY	SENSITIVITY			DEVICE CONFORMITY	
	MIN.	NOM.	MAX.	RANGE OF DEVIATION FROM 3.5 kHz	
500	---	-64.5	---	-14.0	-8.0
1000	---	-58.5	---	-9.0	-1.0
3500	-56.5	-53.5	-50.5	0.0	0.0
10000	---	-53.5	---	-3.0	+3.0

- NOTES: 1. CASE CONNECTED TO NEGATIVE TERMINAL.  
 2. MICROPHONE TO BE FUNCTIONAL WITH 1.6 VDC SUPPLY.  
 3. TYPICAL SENSITIVITY TO HUMIDITY AT 3500Hz IS 0.06 dB/%RH  
 4. SENSITIVITY AND NOISE VALUES INDICATED ON THIS SPECIFICATION ARE VALID AT 50% HUMIDITY.

PORT LOCATION	DC SUPPLY	AMPLIFIER CURRENT DRAIN	SENSITIVITY CHANGE ON REDUCING SUPPLY TO 0.9VDC	"A" WEIGHTED NOISE (RE 1.0 VOLT)	OUTPUT IMPEDANCE OHMS		
					MIN.	NOM.	MAX.
12S	1.3V	50 $\mu$ A MAX.	3 dB MAX.	-93.0 dB MAX.	2800	4400	6800

Revision	C.O. #	Implementation Date	RELEASE LEVEL	REVISION
F	M10104840	10-10-12	<b>Active</b>	<b>F</b>
E	M10104555	4-12-12		
D	M10103600	4-20-10		

**KNOWLES ELECTRONICS**  
ITASCA, ILLINOIS U.S.A.

WHEN TEST LIMITS ARE USED TO ESTABLISH INCOMING INSPECTION ACCEPTANCE/REJECTION CRITERIA, CORRELATION OF TEST EQUIPMENT WITH KNOWLES IS ALSO REQUIRED FOR ELIMINATION OF EQUIPMENT AND TEST METHOD VARIATION

TITLE: **MICROPHONE** **FG-26163-000**  
PERFORMANCE SPECIFICATION **SHT 2.1**

DR. BY	DATE
MMM	3-6-06
CK. BY	DATE
GJP	3-8-06
APP. BY	DATE
GJP	3-8-06

# Mouser Electronics

Authorized Distributor

Click to View Pricing, Inventory, Delivery & Lifecycle Information:

## Knowles:

[FG-23824-G22](#) [FG-23652-D17](#) [FG-23629-D58](#) [FG-23742-P16](#) [FG-23329-P07](#) [FG-23824-C36](#) [FG-26163-000](#) [FG-23629-P25](#) [FG-23629-G17](#) [FG-23653-D45](#) [FG-23629-G10](#) [FG-23329-C05](#) [FG-23453-000](#) [FG-30077-C36](#) [FG-23653-C36](#) [FG-23653-C56](#) [FG-23652-P16](#) [FG-23453-C05](#) [FG-23329-P18](#) [FG-30088-S12](#) [FG-23453-096](#) [FG-23742-C05](#) [FG-23653-D58](#) [FG-30077-S12](#) [FG-23813-C36](#) [FG-23742-150](#) [FG-23652-C36](#) [FG-23742-D65](#) [FG-23742-D36](#) [FG-23629-P16](#) [FG-26481-C69](#) [FG-26726-D17](#) [FG-23652-D65](#) [FG-23629-D65](#) [FG-26163-D65](#) [FG-23629-B27](#) [FG-26163-P07](#) [FG-23849-P16](#) [FG38-30687-P121](#) [FG38-30504-S15](#) [FG-23329-P36](#) [FG38-30490-C36](#) [FG38-31011-S16](#) [FG-30723-S21](#) [FG-26809-D45](#) [FG-31438-D17](#)