

| | |
|----------------|----------------------|
| PRODUCT NUMBER | ZONE "A" PLATING |
| 90306-001 | 100μ/2.54μ MIN. SnPb |
| 90306-001LF | 100μ/2.54μ MIN. Sn |

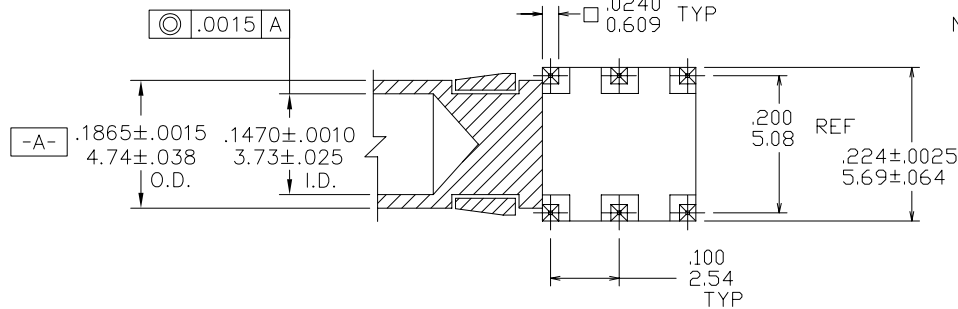
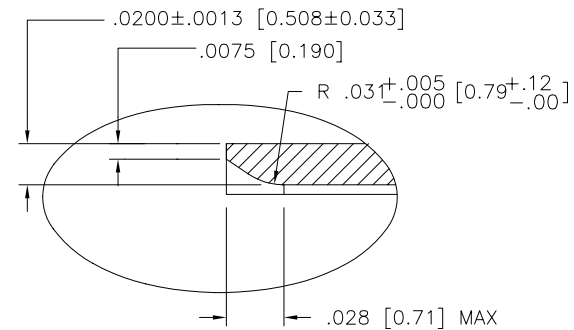
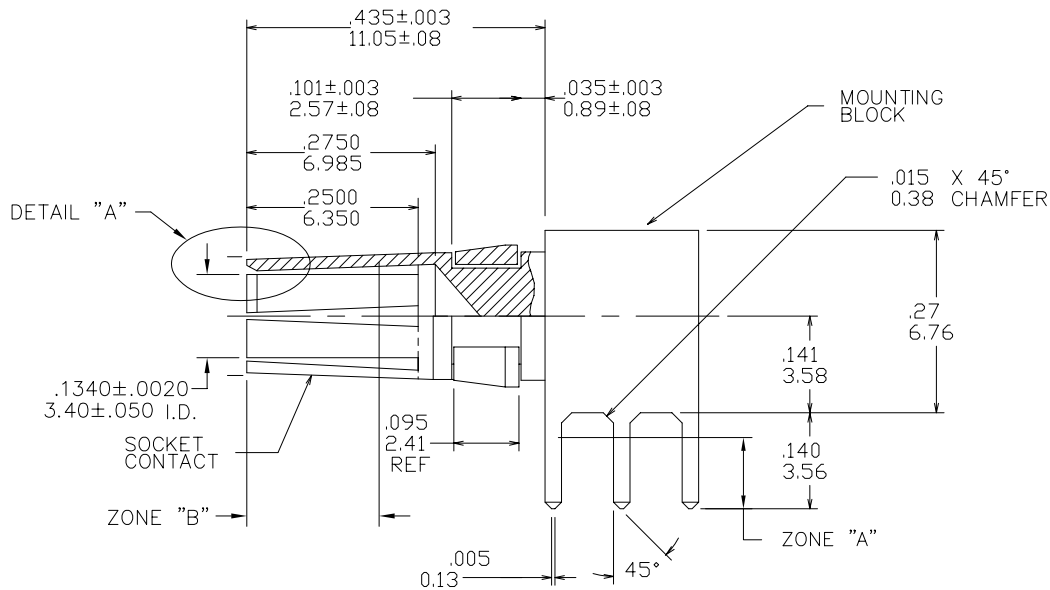

NOTES:

- MATERIAL:
 SOCKET CONTACT: BeCu
 MOUNTING BLOCK: BRASS
 SNAP RING: PHOS. BRONZE (ALLOY 510)
- PLATING:
 ZONE A: SEE TABLE
 ZONE B: 30u"/.76u MIN Au OVER
 UNDERPLATE: 50u"/1.27u MIN Ni
- HEAT TREATING: 625°F f/ 2-1/2 HRS.
- NO BURRS ALLOWED IN SOCKET INTERIOR.
- SURFACE FINISH IN CONTACT AREA NOT TO EXCEED 25rms.

| | | | | | | | | | |
|---------------------------------------|----------|------------------|--|------------------|--|-----------------|--|-----------------------------------|--|
| mat'l. code | | surface | | tolerance | | projection | | product family | |
| NOTE 1 | | ISO 1302 ✓ | | ISO 406 | | ISO 1101 | | HPC | |
| tolerances unless otherwise specified | | angles | | linear | | INCH/MM | | title | |
| G v04394 MDF 2/16/94 | | .xx±.01/.3 | | .xxx±.005/.13 | | scale 1:1 | | CLOSED PWR SOCKET | |
| H v40764 PDP 4/4/94 | | 0'±2' | | .xxxx±.0020/.051 | | FCI | | dwg no 90306 sheet 1 of 1 size A3 | |
| J v60760 MDF 5/20/96 | | M.FETROW 6/12/91 | | S.CLARK 6/12/91 | | S.CLARK 6/12/91 | | type Product Customer Drawing | |
| K v00720 LSS 4/11/00 | | S.CLARK 6/12/91 | | S.CLARK 6/12/91 | | S.CLARK 6/12/91 | | | |
| L v05-0743 DAI 10/18/05 | | enrgr | | appd | | | | | |
| M v06-0283 MHT 7/27/06 | | chr | | | | | | | |
| sheet index | revision | M | | | | | | | |
| | sheet | 1 | | | | | | | |

Mouser Electronics

Authorized Distributor

Click to View Pricing, Inventory, Delivery & Lifecycle Information:

[FCI / Amphenol:](#)

[90306-001LF](#)