



## HEYCap™ Tapered Caps and Plugs–NPT

For NPT Fitting Hubs and Threaded Mounting Holes

- HEYCaps can be used as either **caps or plugs**.
- Because they are tapered in design and made from highly flexible polyethylene, they not only **fit snugly** but are readily **removable**.
- Applicable Specs: MIL-C-5501/7 (MIL-C-52078), NAS-835.

**CAPS:**

- Especially recommended for use on **threaded external NPT fitting hubs**.
- Part dimensions are based on average threaded hub fit. Before ordering in quantity, please sample HEYCaps.
- Recommended Closures: Threaded hubs where Cap dimension B is at least 1% smaller than the hub to be capped. Minimum .020" (0,5 mm).

**PLUGS:**

- Especially recommended for use on **threaded internal NPT fittings and mounting holes**.
- Part dimensions are based on average tapped hole fit. Before ordering in quantity, please sample HEYCap Tapered Plugs.
- Recommended Closures: Threaded mounting holes where Plug dimension A is at least 1% larger than the hole to be plugged. Minimum .020" (0,5 mm).

Fits this NPT Hub or Mounting Hole	PART NO. Red	DESCRIPTION	PART DIMENSIONS							
			A - Major Body Diameters		B - Minor		C Head Diameter		D Depth	
			in.	mm.	in.	mm.	in.	mm.	in.	mm.

**HEYCap Tapered Caps\* for NPT Fitting Hubs - Body Diameters reference Inside**

1/8	<b>G5014</b>	TCP 49-42†	.42	10,7	.36	9,0	.63	16,0	.38	9,7
1/4	<b>G5020</b>	TCP 61-55	.55	13,8	.47	11,9	.75	19,1	.44	11,2
3/8	<b>G5027</b>	TCP 76-69	.69	17,6	.61	15,6	.88	22,4	.50	12,7
1/2	<b>G5035</b>	TCP 91-85	.85	21,6	.74	18,8	1.06	26,9	.63	16,0
3/4	<b>G5047</b>	TCP 115-108	1.08	27,5	.93	23,7	1.31	33,3	.75	19,1
1	<b>G5057</b>	TCP 136-130	1.30	33,0	1.17	29,8	1.50	38,1	.81	20,6
1-1/4	<b>G5071</b>	TCP 168-162	1.62	41,1	1.50	38,0	1.88	47,8	.75	19,1
1-1/2	<b>G5080</b>	TCP 195-189	1.89	48,0	1.72	43,6	2.13	54,1		
2	<b>G5096</b>	TCP 246-240	2.40	61,0	2.24	56,8	2.63	66,8	1.00	25,4
2-1/2	<b>G5110</b>	TCP 299-295	2.95	74,9	2.69	68,2	3.13	79,5		
3	<b>G5116</b>	TCP 356-349	3.49	88,7	3.20	81,3	3.69	93,7	1.13	28,7

**HEYCap Tapered Plugs\*\* for NPT Threaded Mounting Holes - Body Diameters reference Outside**

1/8	<b>G5011</b>	TCP 40-33	.40	10,1	.33	8,4	.53	13,5	.38	9,7
1/4	<b>G5014</b>	TCP 49-42†	.49	12,4	.42	10,7	.63	16,0		
3/8	<b>G5022</b>	TCP 63-57	.63	16,0	.55	14,0	.75	19,1	.47	11,9
1/2	<b>G5029</b>	TCP 79-73	.79	20,1	.69	17,5	.94	23,9	.56	14,2
3/4	<b>G5040</b>	TCP 104-98	1.04	26,4	.92	23,4	1.16	29,5	.69	17,5
1	<b>G5048</b>	TCP 122-115	1.22	31,0	1.09	27,7	1.41	35,8	.75	19,1
1-1/4	<b>G5068</b>	TCP 160-154	1.60	40,6	1.51	38,4	1.75	44,5	.50	12,7
1-1/2	<b>G5075</b>	TCP 181-175	1.81	46,0	1.78	45,2	2.00	50,8	.38	9,7
2	<b>G5090</b>	TCP 226-220	2.26	57,4	2.23	56,6	2.50	63,5	.50	12,7
2-1/2	<b>G5106</b>	TCP 279-273	2.79	70,9	2.64	67,1	2.94	74,7		
3	<b>G5115</b>	TCP 346-338	3.46	87,9	3.33	84,6	3.63	92,2	.75	19,1

\*May also be used as Plugs: to determine Outside Diameters, add approximately .06" (1,5 mm) to Inside Diameter dimensions.

\*\*May also be used as Caps: to determine Inside Diameters, subtract approximately .06" (1,5 mm) from Outside Diameter dimensions.

†Part No. **G5014** functions as a Cap for NPT 1/8" Hubs and a Plug for NPT 1/4" Hubs. Standard color red.



TAPERED CAP

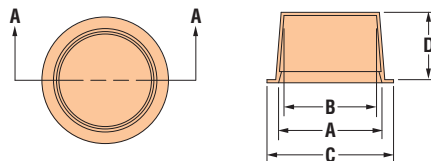

TAPERED PLUG

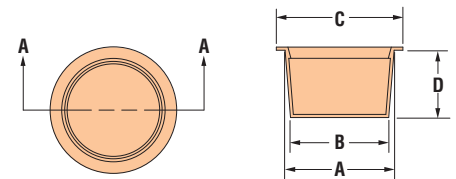

*Quick Specs*

Material LDPE  
Standard Color: Red  
Temperature Range -94°F (-70°C) to 150°F (66°C)

# Mouser Electronics

Authorized Distributor

Click to View Pricing, Inventory, Delivery & Lifecycle Information:

[Heyco:](#)

[G5020](#) [G5027](#) [G5057](#) [G5071](#) [G5096](#) [G5035](#) [G5047](#) [G5080](#) [G5110](#) [G5116](#) [G5029](#) [G5075](#) [G5014](#) [G5022](#)  
[G5040](#) [G5048](#) [G5068](#) [G5090](#) [G5106](#) [G5115](#) [G5011](#)