

2

1

THIS COPY IS PROVIDED ON A RESTRICTED BASIS AND IS NOT TO BE USED IN ANY WAY DETRIMENTAL TO THE INTERESTS OF PANDUIT CORP.

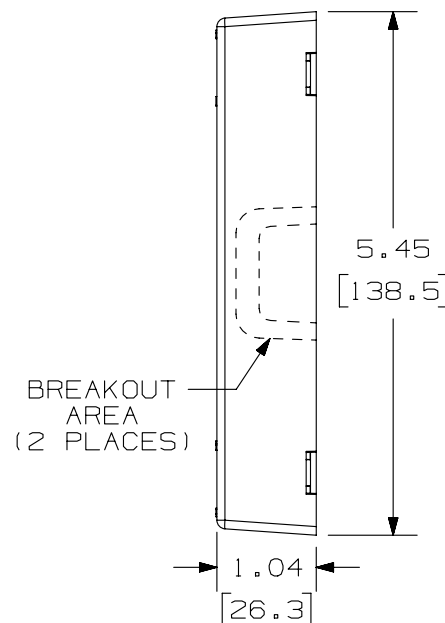
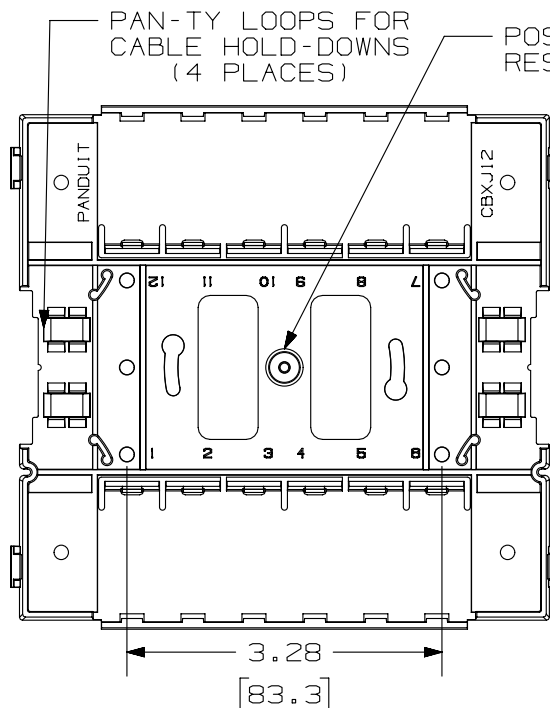

PANDUIT P/N	WEIGHT
CBX12** - AY	2.87 LB/10 PCS (1306 g/10 PCS)

NOTES:

- SEE CURRENT CATALOG FOR ADDITIONAL PART NUMBER SUFFIXES TO INDICATE COLOR AND OR PACKAGE QUANTITY.
- SEE CATALOG FOR A COMPLETE LIST OF PARTS APPLICABLE FOR USE WITH THIS PART.
- DIMENSIONS IN [] ARE IN METRIC.
- BOX INCLUDES:
 - BOX BASE
 - BOX COVER
 - PLT1.51-M PAN-TY
 - LABEL/ LABEL COVER
 - MOUNTING SCREW
 - MOUNTING SCREW (USED TO SECURE COVER TO BASE)
 - STRIP OF 3.00" X .75" FOAM TAPE FOR MOUNTING
- BASE HAS FOUR POCKETS FOR OPTIONAL MAGNET (CBM-X)
- BREAKOUTS DESIGNED TO ACCEPT LD5/LDPH5 AND LD10/LDPH10 RACEWAY.
- BASE MATERIAL THICKNESS= .090 [2.29].

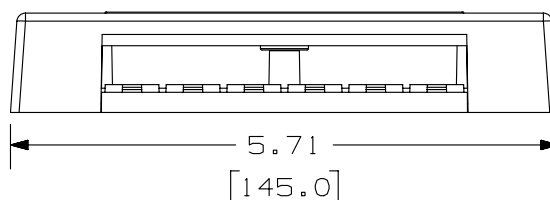

NO WARRANTY, EXPRESSED OR IMPLIED, IS MADE BY PANDUIT WITH RESPECT TO ADHESIVE BOND PERFORMANCE. AMONG OTHER THINGS, THE CONDITIONS UNDER WHICH THESE MOUNTS MAY BE APPLIED AND/OR THE SURFACE TO WHICH THEY MAY BE APPLIED ARE BEYOND PANDUIT'S CONTROL.

PART NUMBER		CBX12** - AY	
TITLE			
MINI-COM 12 POSITION SURFACE MOUNT BOX			
CUSTOMER DRAWING			
ITEM REVISION NAME		M02479EX/00	
DATASET FILE NAME		M02479EX_DC130/00B	
UNLESS OTHERWISE SPECIFIED, DIMENSIONAL TOLERANCES ARE: IN [mm]			
.x ± .1 [2.54] .xxx ± .005 [.127] .xx ± .01 [.25] ANGLES ± 5 °			
		THIRD ANGLE PROJECTION	
DRAWN BY		DATE	
JSP		12-27-06	
CHK		MJD	
SCALE		NONE	
DRAWING NUMBER:		02479-130	
REV		DATE	
BY		CHK	
APR		DESCRIPTION	
ECN		SIZE	
A		SHT 1 OF 1	

2

1

D10100DA/14

Mouser Electronics

Authorized Distributor

Click to View Pricing, Inventory, Delivery & Lifecycle Information:

Panduit:

[CBX12WH-AY](#) [CBX12BL-AY](#) [CBX12IG-AY](#) [CBX12IW-AY](#) [CBX12EI-AY](#) [CBX12AW-AY](#)