

MARKETING SALES DRAWING
DIMENSIONS IN INCHES - DO NOT SCALE THIS DRAWING
DIMENSIONS IN METRIC - []

Electrical Testing
per Tusonix standard
test plans and Mil-Std-202
Test Methods.

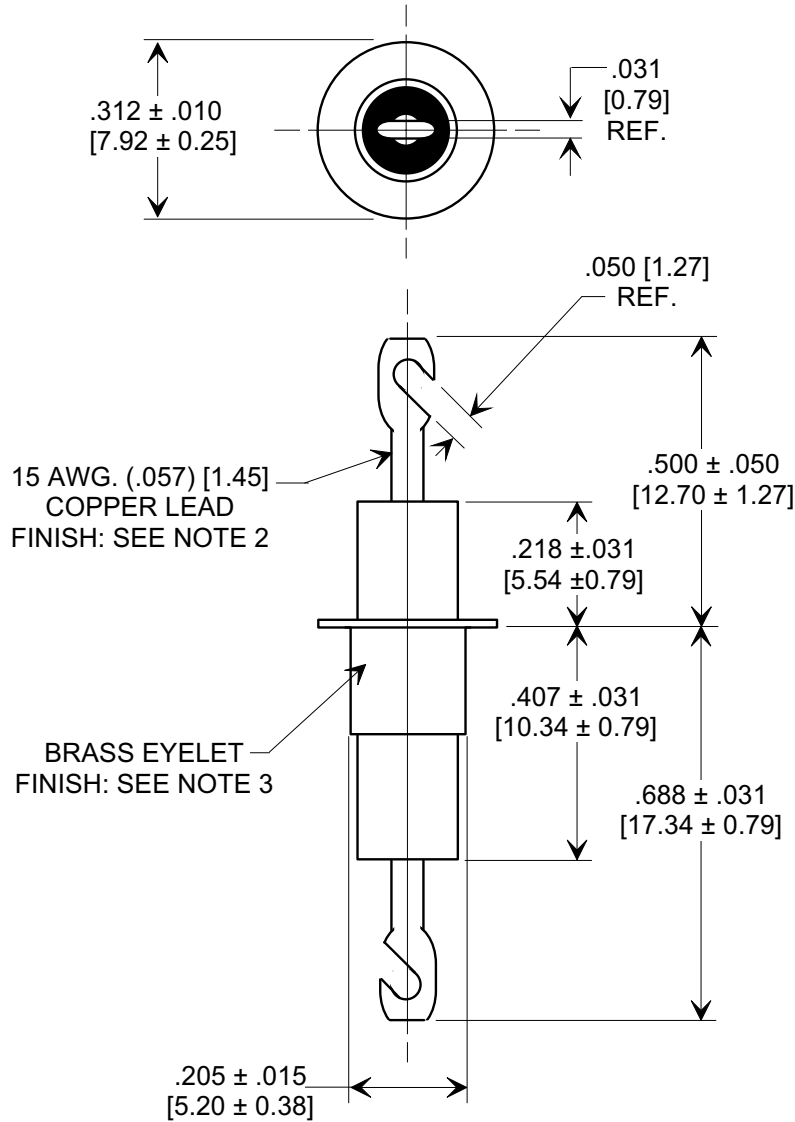
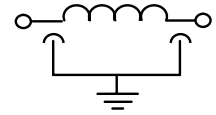
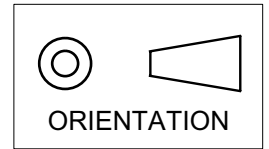

NOTES:

- TUSONIX STANDARD PART NUMBER: 4106-000.
TUSONIX RoHS COMPLIANT PART NUMBER: 4106-000 LF.
CUSTOMER MUST SPECIFY STANDARD OR RoHS PART NUMBER WHEN ORDERING.
- LEAD FINISH: STANDARD PART #: 60/40 SOLDER PLATED. RoHS PART #: SILVER PLATED.
- EYELET FINISH: STANDARD PART #: 60/40 SOLDER PLATED. RoHS PART #: SILVER PLATED.
- PART MARKING: STANDARD PART: NO MARKING. RoHS PART: GREEN DOT IDENTIFIER.

MIN. CAP (pF)	WORKING VOLTAGE (WVDC)		CURRENT Idc	I.R. MIN. @ 100 (VDC)	DWV	MINIMUM NO-LOAD INSERTION LOSS			
	85°C	125°C				10 MHz	100 MHz	1 GHz	10 GHz
3000	500 DC 350 AC	500 DC 350 AC	25A	10 G	1250 VDC	----	50	50	50

REVISION RECORD Original Release C.O. 20040219-2-01 ADDED NOTES 1-4. S.M. 07-26-05 20050718-3-02	0	REVISION RECORD Original Release C.O. 20040219-2-01 ADDED NOTES 1-4. S.M. 07-26-05 20050718-3-02	1	--TOLERANCES-- Unless Otherwise Specified DECIMAL ± // // // ANGLES ± // // //	Title EYELET STYLE EMI FILTER			
			Drawn L.E. 02-19-04 Scale 3 X					
			Approved T.C. 02-19-04					
	TUSONIX TUCSON, ARIZONA		A		4106-000			

X-2015 Rev-0

Mouser Electronics

Authorized Distributor

Click to View Pricing, Inventory, Delivery & Lifecycle Information:

[Tusonix:](#)

[4106-000LF](#)