

In case of consideration for usig Automotive equipment / device which demand high reliability, kindly contact our sales window correspondents.

Apr.1.2020 Copyright 2020 HIROSE ELECTRIC CO., LTD. All Rights Reserved.

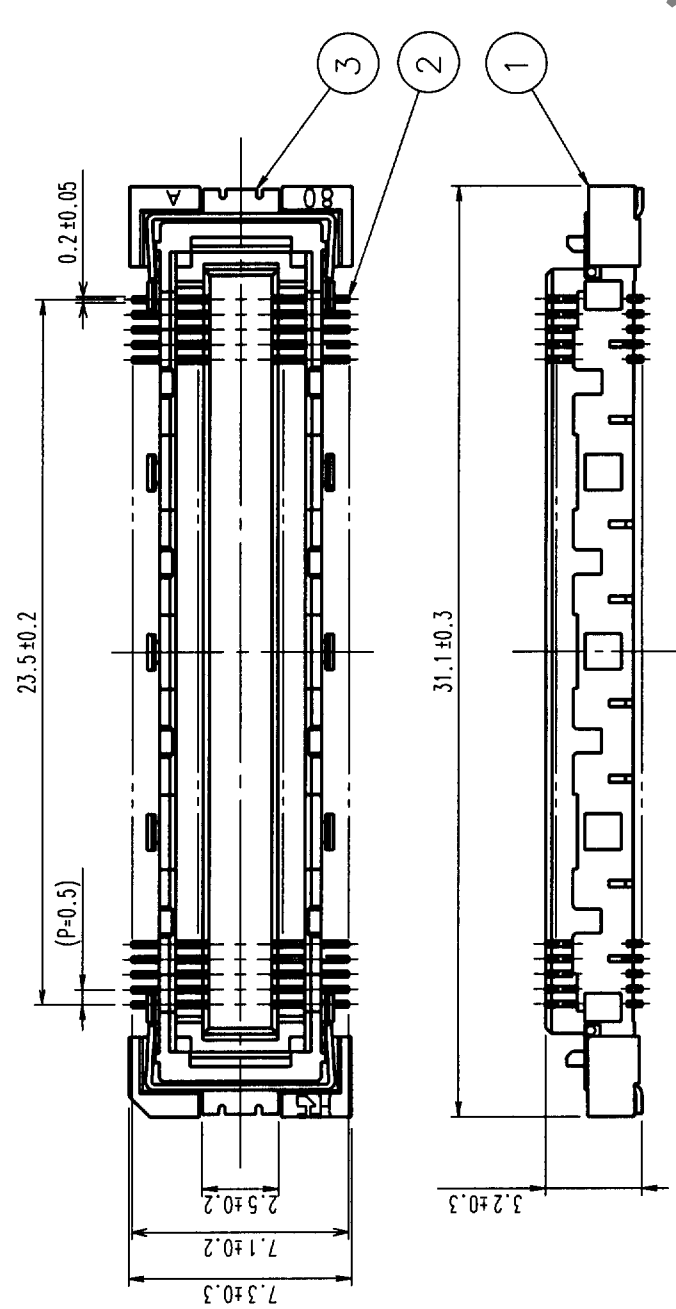

RECOMMENDED LAND PATTERN

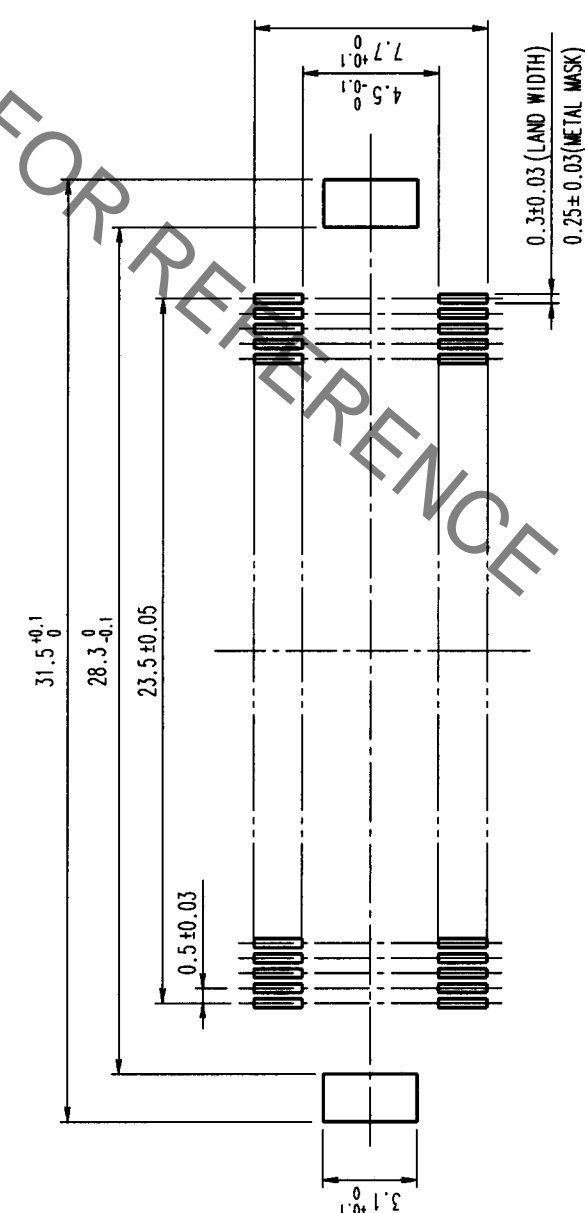

NOTES

- 1 SMT LEAD-COPLANARITY: 0.1 MAX.
- 2 THIS PRODUCT HAS NO POLARITY TO MOUNT ON THE RECOMMENDED LAND PATTERN.

HRS DRAWING FOR REFERENCE

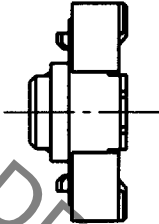

COUNT	DESCRIPTION OF REVISIONS	BY	CHKD	DATE	COUNT	DESCRIPTION OF REVISIONS	BY	CHKD	DATE
△					△				
△					△				
△					△				

NO.		MATERIAL	FINISH, REMARKS	DRAWN		CHECKED		APPROVED		RELEASED	
3		PHOSPHOR BRONZE	TIN PLATED								
2		PHOSPHOR BRONZE	CONTACT AREA: GOLD (0.1μm) OVER NICKEL LEAD: GOLD PLATED (FLASH) OVER NICKEL								
1		LCP	BEIGE UL94V-0	J. Takachi	99.10.18	M. Sakabe	99.10.18	J. Yoshimura	99.10.18		
NO.		MATERIAL		FINISH, REMARKS		DESIGNED		CHECKED		APPROVED	
CODE NO. (OLD)		CL		DRAWN		DESIGNED		CHECKED		APPROVED	
SCALE		4 : 1		DRAWN NO.		DESIGNED NO.		CHECKED NO.		APPROVED NO.	
UNITS		JTTT		EDC3-151988		99.10.18		99.10.18		99.10.18	
PART NO.		FX10B-96S-SV		DRAWING NO.		99.10.18		99.10.18		99.10.18	
CODE NO.		CL570-0251-2		HIRESE ELECTRIC CO., LTD		99.10.18		99.10.18		99.10.18	

TO	
PCK	