

Signal lamps with lamp socket - W 2x4.6d, housing**1.66.003.091/0000**

Please include the desired lens and LED/bulb in your order.

**General information**

Form of lens	round
Diameter of collar	13

Dimensions

Overall height	8.5 mm
Mounting depth	28.5 mm
Mounting hole	11.10 mm

Mechanical design

Mounting	ring nut
Terminals	quick connector A 2.8 x 0.5
Lamp socket	W 2 x 4.6 d
Lamp	LED or filament lamp

Electrical characteristics

Voltage limit max.	35 V
Power limit max.	1.2 W

Other specifications

Degree of protection from front side	IP40 (DIN EN 60529)
Weight	1.4 g
ROHS compliant	yes
REACH compliant	yes

Mounting hole

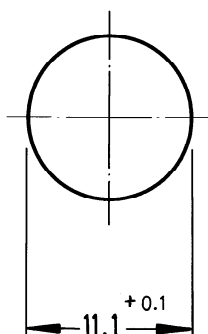

Drawing with lens

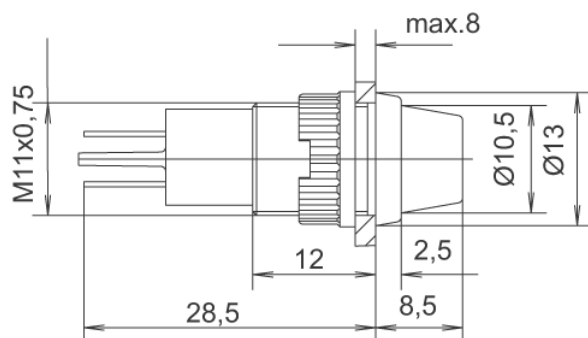

Mouser Electronics

Authorized Distributor

Click to View Pricing, Inventory, Delivery & Lifecycle Information:

[RAFI:](#)

[1.66.003.091/0000](#)