

PLEASE CHECK WWW.MOLEX.COM FOR LATEST PART INFORMATION

Part Number: **0190690200**
Status: **Active**
Overview: Solderless Terminals
Description: Krimptite Ring Tongue Terminal for 10-12 AWG Wire, Stud Size 4 (M2.6), Length 19.94mm

Documents:

[3D Model](#) [Product Specification PS-19902-013-001 \(PDF\)](#)
[Drawing \(PDF\)](#) [RoHS Certificate of Compliance \(PDF\)](#)
[Product Specification PS-19902-011-001 \(PDF\)](#)

Agency Certification

CSA LR18689
 UL E32244

General

Product Family Ring and Spade Terminals
 Series [19069](#)
 Crimp Quality Equipment Yes
 Overview [Solderless Terminals](#)
 Product Name Krimptite
 Type Ring
 UPC 800755067187

Physical

Barrel Type Closed
 Insulation None
 Material - Plating Mating Tin
 Material - Plating Termination Tin
 Net Weight 1.566/g
 Packaging Type Bag
 Plating min - Mating 2.540µm
 Plating min - Termination 2.540µm
 Stud Size 4 (M2.6)
 Termination Interface: Style Crimp or Compression
 Wire Size AWG 10, 12
 Wire Size mm² 4.00-6.00

Solder Process Data

Lead-freeProcess Capability N/A

Material Info

Engineering Number C-128-04

Reference - Drawing Numbers

Product Specification PS-19902-011-001, PS-19902-013-001
 Sales Drawing SD-19069-020-001

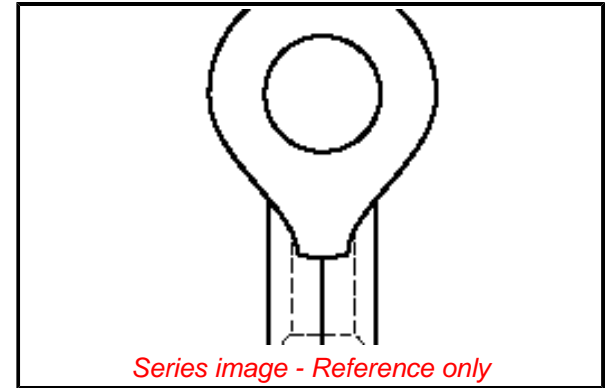

EU ELV

Not Relevant

EU RoHS

Compliant

REACH SVHC

Not Contained Per -
 ED/71/2019 (16 July
 2019)

Halogen-Free

Status

Low-Halogen

For more information, please visit [Contact US](#)

China ROHS

ELV

RoHS Phthalates

China RoHS

Green Image

Not Relevant

Not Contained

Search Parts in this Series

[19069 Series](#)

Application Tooling | [FAQ](#)

Tooling specifications and manuals are found by selecting the products below. Crimp Height Specifications are then contained in the Application Tooling Specification document.

Global

Description

Product #

PremiumGrade Hand	640030100
Crimp Tool	
Crimp Head for the	640070100
AT-200 Pneumatic	
Hand Tool	

Mouser Electronics

Authorized Distributor

Click to View Pricing, Inventory, Delivery & Lifecycle Information:

[Molex:](#)

[19069-0200](#)