

## Model 4702 Banana Plug To In-Line Banana Jack

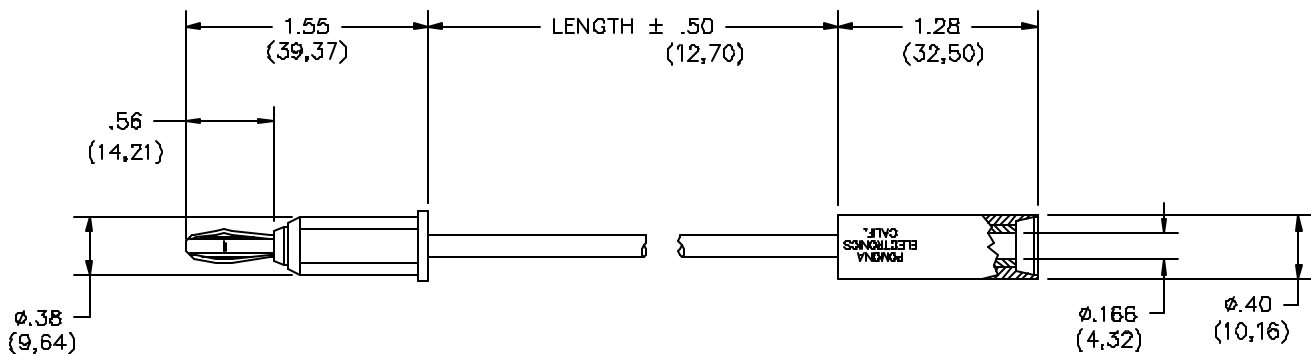

### FEATURES:

- Dual Purpose
- Insulates all hot leads when used as an extension cord.
- Endless extension couplings possible with any banana plug patch cord.

### MATERIALS:

Conn: Banana Plug

Material: Spring, One piece heat treated Beryllium Copper, Berylco 25 per QQ-C-533.

Finish: Nickel plate per QQ-N-290 class 2 (.0002 min.).

Insulation: Polypropylene, molded to plug body and wire. Color matches color of wire.

Operating Temperature: +55° C. (+131° F.) Max.

Marking: "POMONA ELECTRONICS CALIF."

Wire: 18 AWG; stranding 65 x 36 tinned copper, polyvinyl chloride insulated (.050 wall thickness).

Marking: POMONA 4702-"XX".

Conn: In-Line Banana Jack

Material: Brass, H.H. per QQ-B-626, Alloy 360.

Finish: Nickel plate per QQ-N-290. Class 2 (.0002 min.).

Insulation: Polypropylene, molded to jack body and wire. Color matches color of wire.

Operating Temperature: +55° C. (+131° F.) Max.

Marking: "POMONA ELECTRONICS CALIF."

**RATINGS:** Entire Assembly

Operating Temperature: +55° C. (+131° F.) Max.

Operating Voltage: 5000 W VDC

Current: 15 Amperes Cont.

**ORDERING INFORMATION:** Model 4702-XX-\*

XX = Cable Lengths, Standard Lengths: 12" (305), 18" (475), 24" (610), 36" (914), 48" (1219) & 60" (1524). Additional lengths can be quoted upon request.

\*=Color, -0 black, -2 red.

Ordering Example: 4702-60-2 Indicates 60" in length, color is Red.

All dimensions are in inches. Tolerances (except noted): .xx = ±.02" (.51 mm), .xxx = ±.005" (.127 mm).

All specifications are to the latest revisions. Specifications are subject to change without notice.

Registered trademarks are the property of their respective companies. Made in USA

# Mouser Electronics

Authorized Distributor

Click to View Pricing, Inventory, Delivery & Lifecycle Information:

Pomona:

[4702-48-2](#) [4702-48-0](#) [4702-36-0](#) [4702-36-2](#) [4702-24-0](#) [4702-24-2](#)