

# D-Sub Connectors

156-1409, 156-1415, 156-1425, 156-1437

**KOBI**CONN

D-Sub Connectors

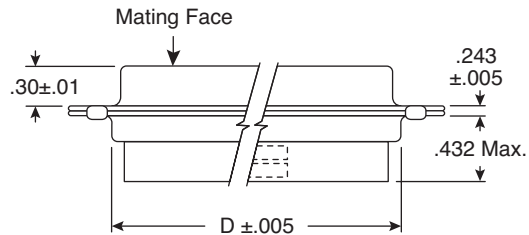
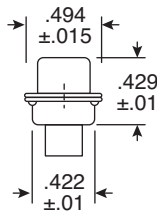
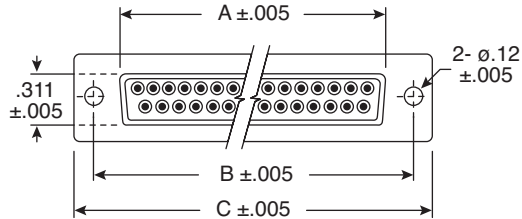
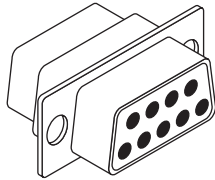

Dimensions: In.

Mouser Stock No.	No. of Contacts	Dimensions (In.)			
		A	B	C	D
156-1409	9	.643	.984	1.21	.759
156-1415	15	.971	1.31	1.54	1.08
156-1425	25	1.51	1.85	2.09	1.63
156-1437	37	2.16	2.50	2.73	2.27

MATERIALS	
Shell:	Steel, Zinc or Tin-Plated
Insulator:	Glass Filled Nylon

SPECIFICATIONS	
Type:	Receptacle Housing
Current Rating:	5A
Dielectric Strength:	1000V for 1 Minute
Insulator Resistance:	1000MΩ min. @ 500VDC
Temperature:	-55°C ~ +105°C

Date Last Revised: 10-18-05

Available from Mouser Electronics  
1-800-346-6873  
www.mouser.com

KC-300659

156-1409, 156-1415, 156-1425, 156-1437

# Mouser Electronics

Authorized Distributor

Click to View Pricing, Inventory, Delivery & Lifecycle Information:

[Kobiconn:](#)

[156-1415](#) [156-1409](#) [156-1425](#)