

LOC	DIST	REVISONS			
		P	LTR	DESCRIPTION	DATE
GP	00	J		REVISED PER ECO-06-025935	12/FEB/07

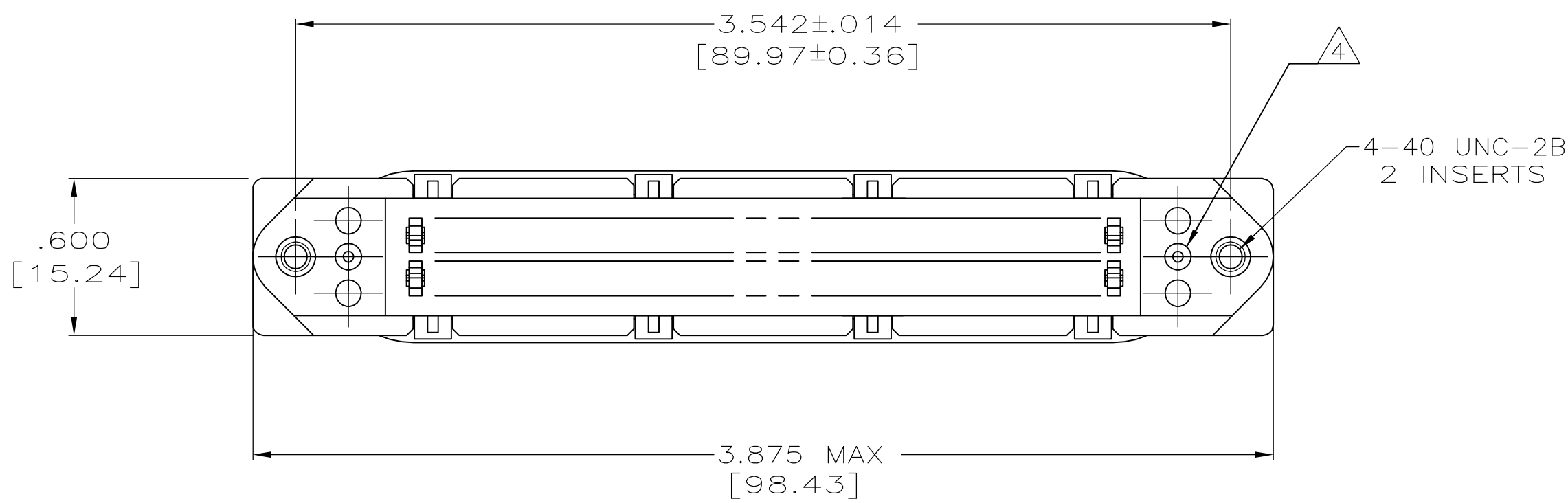
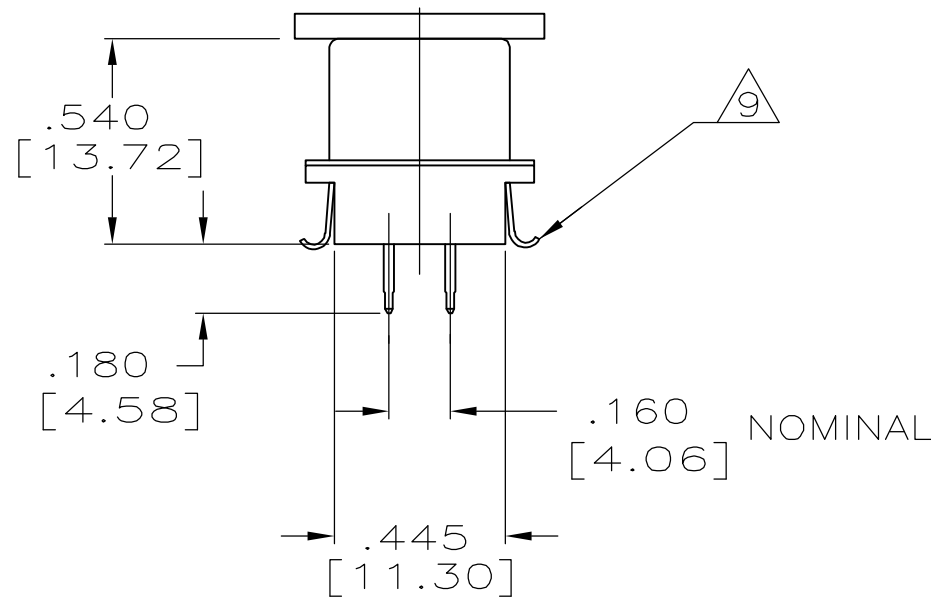
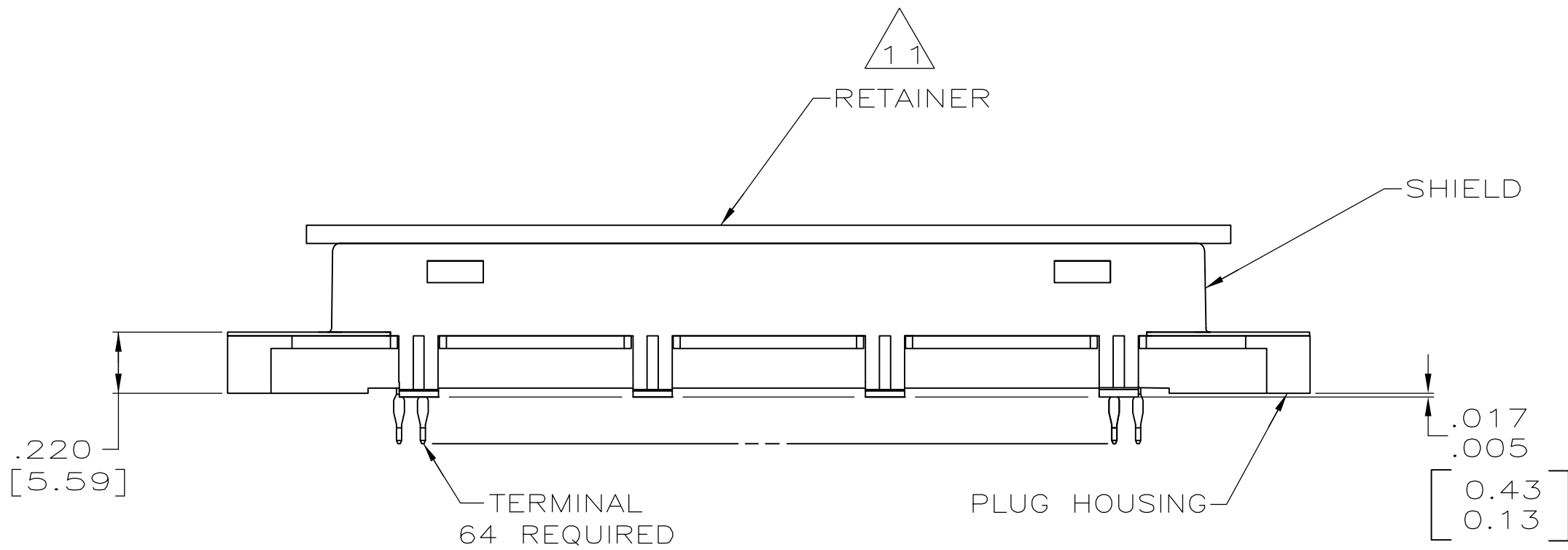
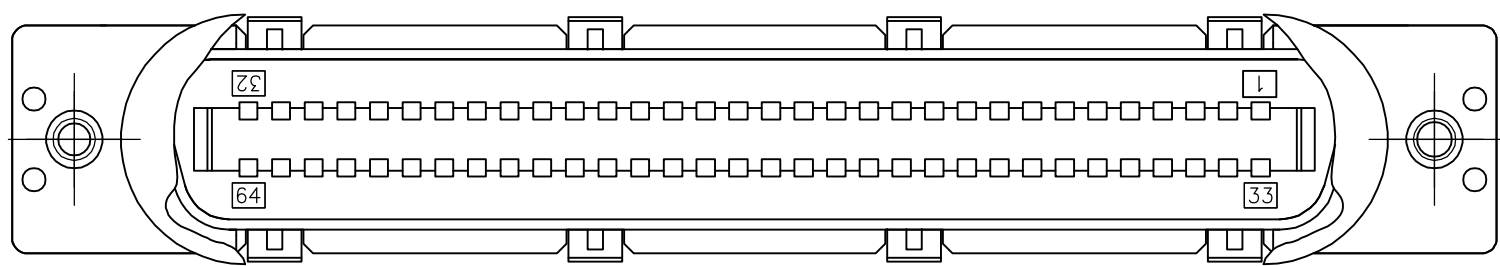

FINISHED HOLE SIZE
AFTER REFLOW

φ.035
φ.030
φ 0.89
φ 0.76

φ.007
φ.018
TYP

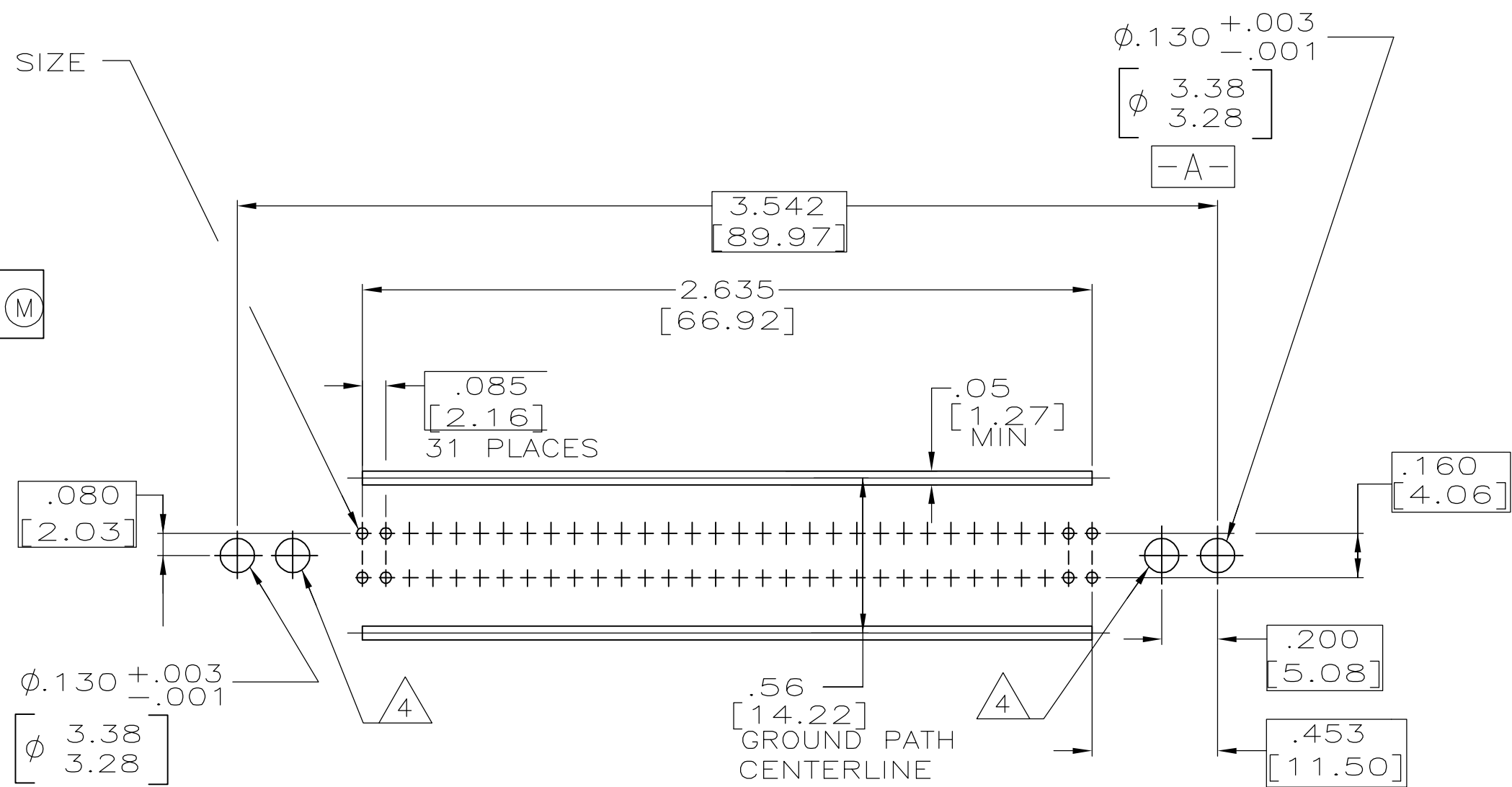

PRINTED CIRCUIT BOARD
MOUNTING DIMENSIONS

1. ALL DIMENSIONS SHOWN ARE MAXIMUM UNLESS OTHERWISE SPECIFIED.
2. MATERIAL: HOUSING - POLYPHENYLENE OXIDE, BLACK.
SHIELD - CARBON STEEL PLATED WITH .000200 [5.08μm] MINIMUM NICKEL.
TERMINALS - PHOSPHOR BRONZE PLATED WITH .000030 [0.76μm] MINIMUM GOLD PLATE IN LOCALIZED PLATE AREA OVER .000050 [1.27μm] MINIMUM ELECTROLESS NICKEL.
RETAINER - POLYETHYLENE, NATURAL
INSERTS - BRASS, PLATED WITH .000100[2.54μm] MINIMUM BRIGHT ZINC.
556622-2 PLATED WITH MATTE TIN-LEAD 93-7% .000100-.000180[2.54μm-4.57μm] THICK ON ACTION PIN AREA.
3. THE CONTACT SURFACES OF THE TERMINALS ARE COATED WITH LUBRICANT.
4. OPTIONAL MOUNTING HOLE FOR SELF-TAPPING SCREW.
5. ALL PLATED-THRU HOLES SHALL BE PER AMP SPEC 115-6072.
6. FOR NON-PANEL MOUNT APPLICATIONS USE BAIL LOCK HARDWARE KIT NO. 556614-1.
7. CENTER-TO-CENTER SPACING OF TERMINALS IS .085 NOMINAL.
8. DIMENSIONS IN [] ARE MILLIMETERS.
9. GROUND TABS (8) PLACES.
10. 50 LBS MINIMUM FORCE REQUIRED TO UNSEAT CONNECTOR FROM PRINTED CIRCUIT BOARD WITHOUT USE OF HARDWARE.
11. RETAINER MUST REMAIN INSTALLED UNTIL AFTER CONNECTOR HAS BEEN INSERTED INTO PCB HOLES.
12. OBSOLETE

Sn-Pb	556622-2
Au	556622-1
PIN PLATING	PART NUMBER

THIS DRAWING IS A CONTROLLED DOCUMENT.		DWN R. NELSON	10-17-89	tyco Electronics		Tyco Electronics Corporation Harrisburg, PA 17105-3608	
DIMENSIONS: INCHES[mm]		CHK B. FOX	12-19-89			NAME	
		APVD R. NELSON	12-19-89	PRODUCT SPEC		RECEPTACLE ASSEMBLY, 64 POSITION,SHIELDED,ACTION PIN, WITH 4-40 HOLES	
		APPLICATION SPEC		SIZE		RESTRICTED TO	
		WEIGHT		A1 00779		REV J	
MATERIAL		FINISH		CUSTOMER DRAWING		SCALE 2:1	

Mouser Electronics

Authorized Distributor

Click to View Pricing, Inventory, Delivery & Lifecycle Information:

[TE Connectivity:](#)

[556622-1](#)