

a) Part as supplied

242W0**

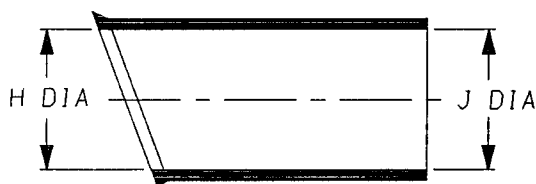

b) Part after unrestricted recovery.

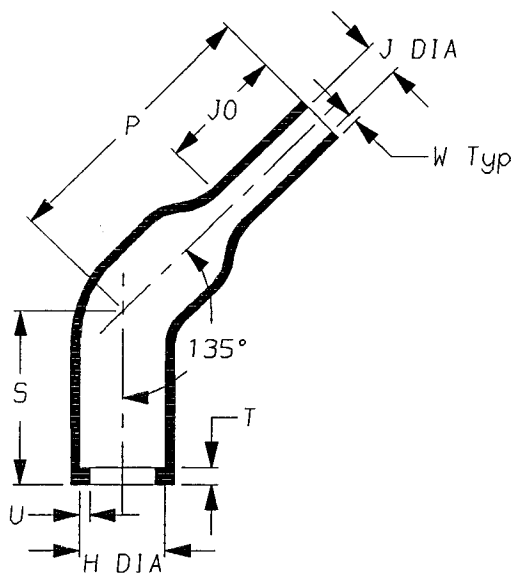

DIMENSIONS (in millimetres).

Part Number	H		J		P	S	T	U	JO	W
	Min a	Max b	Min a	Max b	±10% b	±10% b	±10% b	±10% b	±10% b	±20% b
242W042	31	17.9	31	7.0	55	35	3.5	2.0	25	1.8
242W053	36	22.1	36	8.4	60	40	3.5	2.0	30	2.0
242W063	43	27.9	43	9.9	65	45	3.5	2.0	35	2.2

Copyright (!)

The copyright in this drawing is the property of Tyco Electronics UK Ltd. The drawing is issued on the condition that it is not copied, reproduced or disclosed to a third party, either in whole or in part without the prior written consent of Tyco Electronics UK Ltd.

Drawn A.LILLEY. Checked *dx* Issue 2 Date October 2000 Conforms to ISO Recommendations

Approval Design

Car

MKTG. *W Jones*

Q.A.

[Signature]

3rd Angle Projection
Not to Scale

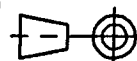

Iss.	Date	E.C.R. No.	Details of Change
2	October 2000	CR00-HM-0016	W was 2.0

Ordering Information

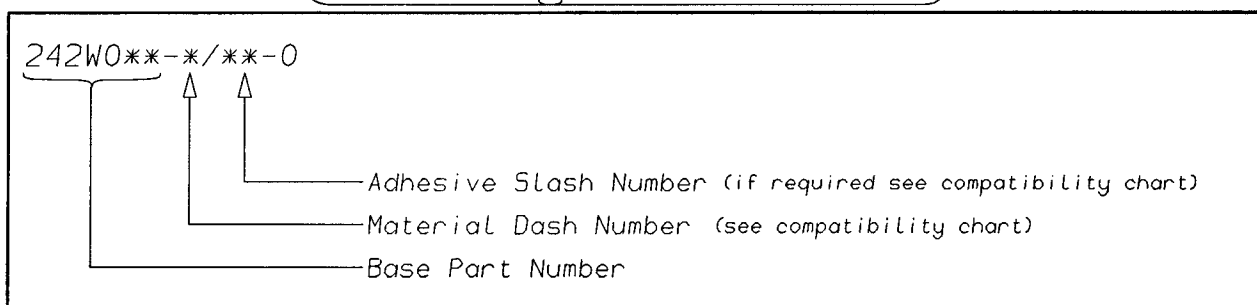

COMPATIBILITY CHART

MATERIAL DASH NUMBER	MATERIAL DESCRIPTION	COATING SLASH NUMBER
-3	POLYOLEFIN, SEMI-RIGID	/42, /86
-4	POLYOLEFIN, FLEXIBLE	/42, /86
-25	ELASTOMER, FLUID RESISTANT	/86, /225
-130	POLYOLEFIN, COMMERCIAL FLEXIBLE	/42, /86

AS SUPPLIED DIMENSIONS ARE FOR UNCOATED PARTS,
WHEN COATING IS ADDED, ENTRY DIAMETERS WILL REDUCE BY 1.5mm MAX.

Raychem Wire & Harness
 a Division of Tyco Electronics
 Faraday Road,
 Swindon, Wiltshire, England. SN3 5JA
 Telephone: (01793) 528171 Fax: 572516

Raychem Wire & Harness
 a Division of Tyco Electronics
 300, Constitution Drive, Menlo Park,
 California 94025-1164, USA
 Telephone (650) 361-3333 Fax: (650) 361-5579

Mouser Electronics

Authorized Distributor

Click to View Pricing, Inventory, Delivery & Lifecycle Information:

[TE Connectivity:](#)

[242W063-25-0](#)